

PRODUCT DATA DRAWING

CAD
GENERATED
DRAWING

DCN
CONTROLLED
DOCUMENT

DWG. NO.

SF2998-6001

MATERIAL:

BODY
COUPLING NUT: STAINLESS STEEL PER AMS-5640,
UNS S30300, TYPE I.

LOCK RING: BERYLLIUM COPPER PER ASTM B196.

GASKET: SILICONE RUBBER PER ZZ-R-765, CLASS II,
GRADE 50/60

FINISH:

BODY
COUPLING NUT: PASSIVATED PER QQ-P-35, TYPE II

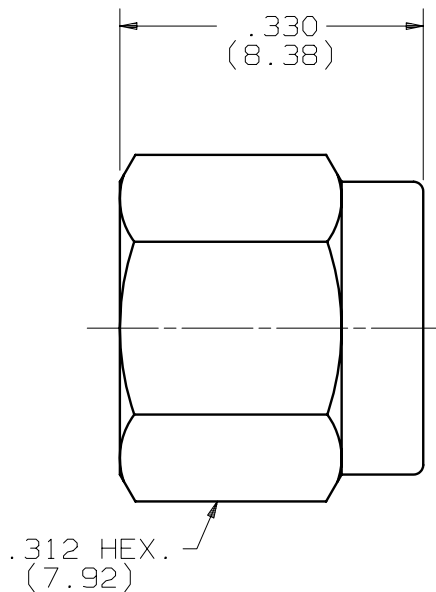

SYM.	DESCRIPTION	DATE	APPR.	UNLESS OTHERWISE SPECIFIED: 1)ALL DIMENSIONS ARE AFTER PLATING. 2)BREAK CORNERS & EDGES .005 R.MAX. 3)CHAM. 1st & LAST THDS. 4)SURFACE ROUGHNESS 63 / MIL-STD-10. 5)DIAS. ON COMMON CENTERS TO BE CONCENTRIC WITHIN .005 T.I.R. 6)REMOVE ALL BURRS.		DIMENSIONS ARE IN INCHES TOLERANCES: DECIMALS FRACTIONAL ANGULAR .X ±.030 X° ±1°0' .XX ±.015 ±1/64 X°X' ±15' .XXX ±.005			SV Microwave, Inc. 2400 Centrepark West Drive, Suite 100 West Palm Beach, FL 33409					
B	REL. DCN 32690	02/05	VMJ			MATERIAL: SEE ABOVE						TITLE: SMA PLUG NON SHORTING DUST CAP		
				DRAWN: MEB 02/02/05		FINISH: SEE ABOVE		AREA: N/A		DWG.NO. SF2998-6001				
				CHECKED: VMJ 02/02/05		SIZE A		CAGE NO. 95077					SCALE N/A	
				APPROVED: VMJ 02/02/05										

SV Microwave, Inc.

2400 Centrepark West Drive, Suite 100
West Palm Beach, FL 33409

Mouser Electronics

Authorized Distributor

Click to View Pricing, Inventory, Delivery & Lifecycle Information:

[Amphenol:](#)

[SF2998-6001](#)