

REV	ECN	DESCRIPTION	DATE	MODIFIED
B		UPDATE	2018.06.18	ROY.QU

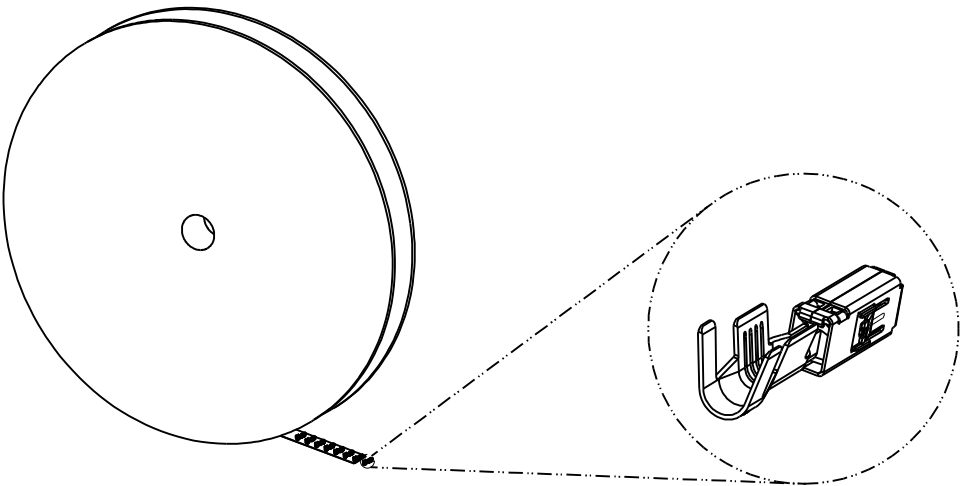
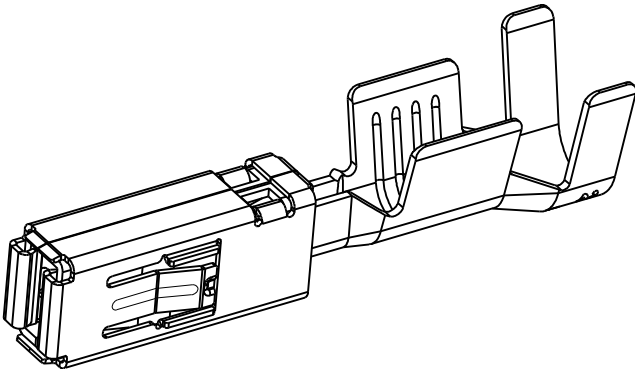
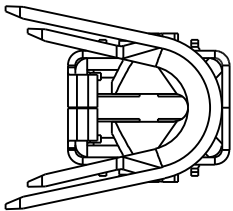
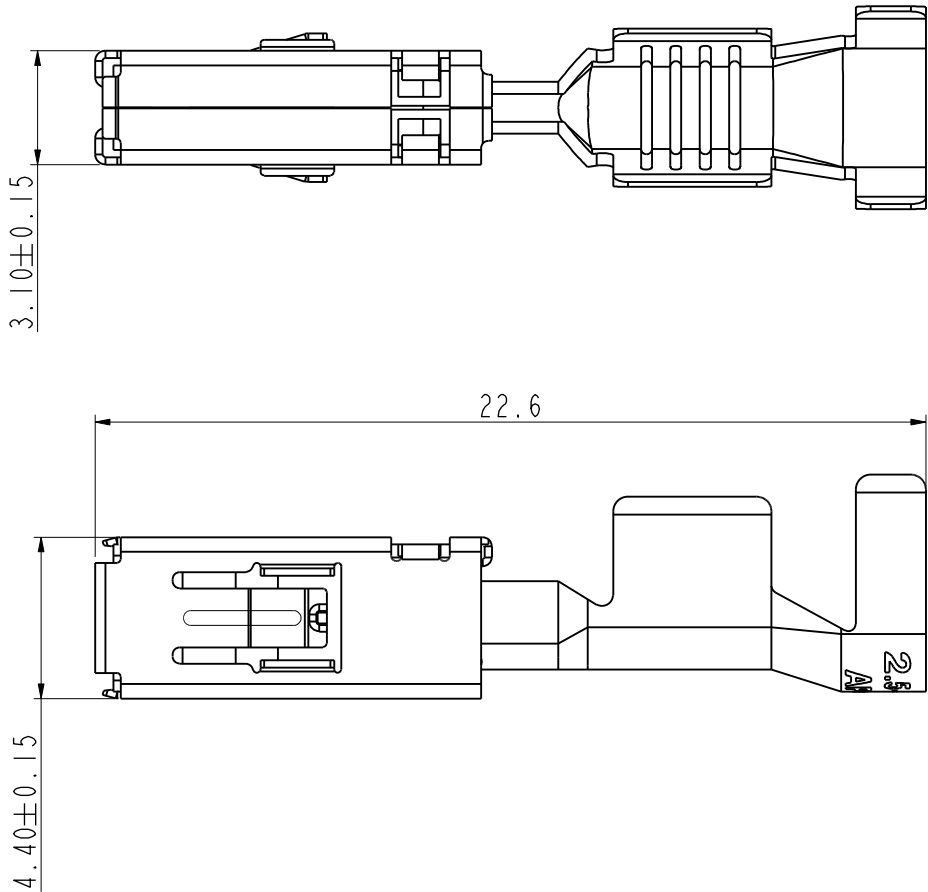
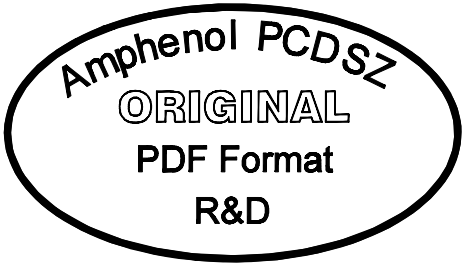

TECHNICAL FEATURES

- 1. MATERIAL:  
CONTACT: COPPER ALLOY  
TOP SPRING: STAINLESS
- 2. CONTACT FINISH: TIN PLATED
- 3. WIRE SIZE RANGE: 2.5~4.0 MM^2
- 4. CURRENT CARRYING CAPACITY:  
UP TO 40 AMPERE (AT 20° C AMBIENT TEMPERATURE)
- 5. MATING FORCE: 8N MAX
- 6. CONTACT RESISTANCE: NEW STATE < 2mΩ
- 7. TAPE REEL PACKING

DIMENSIONS	TOLERANCES	PROJECTION	Amphenol Pcd Shenzhen		TITLE  2.8*0.8 FEMALE PIN			
ANSI Y14.5M	.X ±0.1		ENGR					
UNITS: MM	.XX ±0.01		ROY.QU 2018.06.18					
Pro/E FILE	ANGLES ±0.5°				SIZE	DWG NO.		REV
ORIGINAL	THIS DOCUMENT CONTAINS PROPRIETARY INFORMATION WHICH IS THE CONFIDENTIAL PROPERTY OF AMPHENOL PCD SHENZHEN		CHKD		A3	C-C310003612S		B
			APPD					
					CODE: 58982		SCALE: 2:1	SHEET 1 OF 1

# Mouser Electronics

Authorized Distributor

Click to View Pricing, Inventory, Delivery & Lifecycle Information:

[Amphenol:](#)

[C310003612](#)