

## REVISIONS

REV	ECO	DESCRIPTION	DATE	BY	APPR
A1	--	RELEASE DRAWING	05/DEC/19	SULLEN	TOMMY

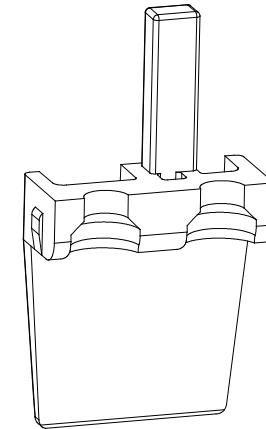
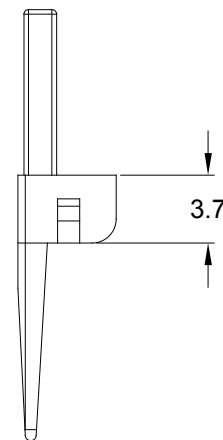
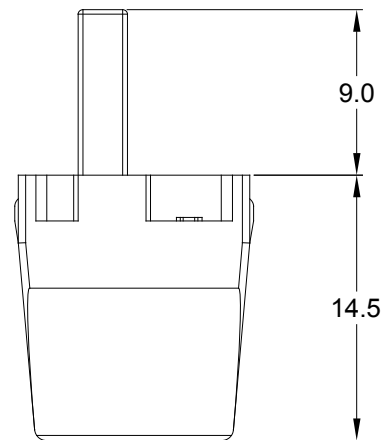
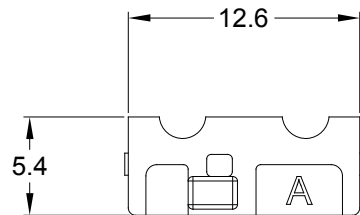

## NOTES: UNLESS OTHERWISE SPECIFIED

1. MATERIAL: THERMOPLASTIC; COLOR: SEE SHEET 2

2. RoHS COMPLIANT

3. CAVITIES: 2

4. KEYED: SEE SHEET 2

5. USE WITH CONNECTORS ATP04-2P\*  
(\* = MODIFICATIONS AND COLORS )

6. ALL DIMENSIONS ARE FOR REFERENCE USE ONLY.

SEE SHEET 2

QUANTITY	PART NUMBER	DESCRIPTION	ITEM
----------	-------------	-------------	------

## MATERIALS LIST

<b>UNLESS OTHERWISE SPECIFIED</b> 1) All dimensions are in metric(mm). 2) Tolerances are as follows: 1 PL DEC ±0.30 2 PL DEC ±0.15 3 PL DEC ±0.08 3) Note reference =		<b>SIGNATURES</b> DRAWN: SULLEN.ZHANG CHECKED: ORION.LI ENGINEER: APPROVAL: TOMMY.XIE	<b>DATE</b> 05/DEC/19 05/DEC/19  05/DEC/19	<b>Amphenol</b> Sine Systems - www.amphenol-sine.com 44724 Morley Drive Clinton Township, MI 48036	
<b>MATERIAL SPECIFICATIONS:</b>		<b>CUSTOMER:</b>		<b>P-WEDGELOCK,2 POS,ATP SERIES</b>	
<b>PROCESS SPECIFICATIONS:</b>		<b>THIS DRAWING IS SUPPLIED FOR INFORMATION ONLY. DESIGN FEATURES, SPECIFICATIONS AND PERFORMANCE DATA SHOWN HEREON ARE THE PROPERTY OF THE AMPHENOL CORPORATION. NO RIGHTS OF REPRODUCTION ARE IMPLIED. ALL DIMENSIONS ARE SUBJECT TO NORMAL MANUFACTURING VARIATIONS.</b>		<b>SIZE</b> A	<b>TYPE</b> C-
<b>NEXT ASSY:</b>		<b>DWG NO:</b> AWP-2PX		<b>REVISION</b> A1	
		<b>SCALE:</b> NONE		<b>SHEET</b> 1	<b>OF</b> 2

## REVISIONS

REV	ECO	DESCRIPTION	DATE	BY	APPR
A1	--	RELEASE DRAWING	05/DEC/19	SULLEN	TOMMY

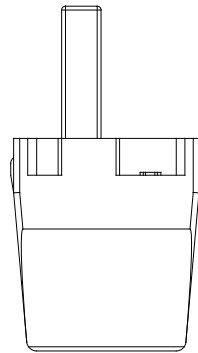
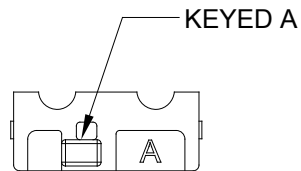

AWP-2PA  
GRAY

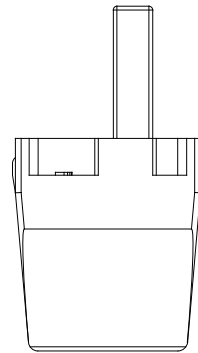
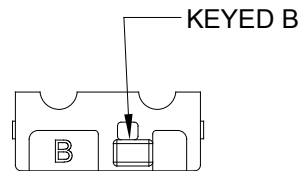

AWP-2PB  
BLACK

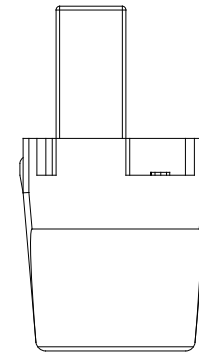
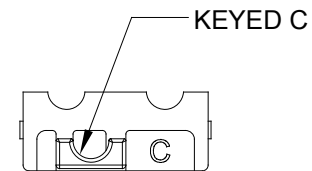

AWP-2PC  
GREEN

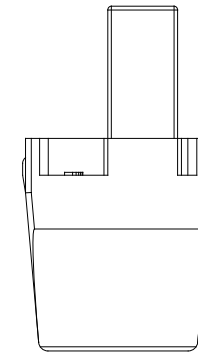
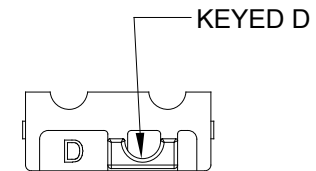

AWP-2PD  
BROWN

		AWP-2PX			
QUANTITY		PART NUMBER		DESCRIPTION	
				ITEM	
MATERIALS LIST					
<div>UNLESS OTHERWISE SPECIFIED</div> <div>1) All dimensions are in metric(mm).</div> <div>2) Tolerances are as follows:</div> <div>1 PL DEC ±0.30</div> <div>2 PL DEC ±0.15</div> <div>3 PL DEC ±0.08</div> <div>3) Note reference = </div>		<div>SIGNATURES</div> <div>DRAWN: SULLEN.ZHANG</div> <div>CHECKED: ORION.LI</div> <div>ENGINEER:</div> <div>APPROVAL: TOMMY.XIE</div> <div>CUSTOMER:</div> <div>THIS DRAWING IS SUPPLIED FOR INFORMATION ONLY. DESIGN FEATURES, SPECIFICATIONS AND PERFORMANCE DATA SHOWN HEREON ARE THE PROPERTY OF THE AMPHENOL CORPORATION. NO RIGHTS OF REPRODUCTION ARE IMPLIED. ALL DIMENSIONS ARE SUBJECT TO NORMAL MANUFACTURING VARIATIONS.</div>		<div>DATE</div> <div>05/DEC/19</div> <div>05/DEC/19</div> <div></div> <div>05/DEC/19</div>	
MATERIAL SPECIFICATIONS:		<div>Amphenol</div> <div>Sine Systems - <a href="http://www.amphenol-sine.com">www.amphenol-sine.com</a></div> <div>44724 Morley Drive</div> <div>Clinton Township, MI 48036</div>			
PROCESS SPECIFICATIONS:		P-WEDGELOCK,2 POS,ATP SERIES			
NEXT ASSY:		SIZE	TYPE	DWG NO:	REVISION
		A	C-	AWP-2PX	A1
		SCALE: NONE		SHEET 2	OF 2

# Mouser Electronics

Authorized Distributor

Click to View Pricing, Inventory, Delivery & Lifecycle Information:

[Amphenol:](#)

[AWP-2PB](#)