

T H E R M O M E T R I C S
A COMMITMENT TO EXCELLENCE

GE-2142 HVAC Duct Temperature Sensor



Thermometrics GE-2142 HVAC Duct Temperature Sensors are OEM solutions for measuring the temperature of air in ventilation ducts. These sensors provide a signal output that is proportional to the duct air temperature. This signal can be used as an input to a controller that interprets the signal and adjusts outputs accordingly.

Features

- Lead frame construction for a robust crimpless conductive path from the terminals to the NTC
- High accuracy
- High sensitivity and reliability
- Rugged thermoplastic housing
- Twist-and-lock installation
- Open element design for fast time response

Automotive Applications

- HVAC Vent Temperature
- In-cabin Temperature

Industrial Applications

- Air Temperature
- HVAC Airflow Monitoring
- Industrial Automation – Ambient environment and process monitoring.

Amphenol
Advanced Sensors

GE-2142 Specifications

Weight:

2.4 grams

R @ 25°C (77°F):

2,795 Ω ($\pm 2.50\%$)

Operating Temperature:

-40° to 135°C (-40°F to 275°F)

Beta (25/85) °C:

4073

Storage Temperature:

-40° to 135°C (-40°F to 275°F)

Plastic:

Nylon 6/6

Response Time:

< 5 seconds (in oil)

Mating Connector:

P/N: 12047662

Connection System:

Aptiv (Delphi) Metri-Pack 150

Unsealed

Dimensions

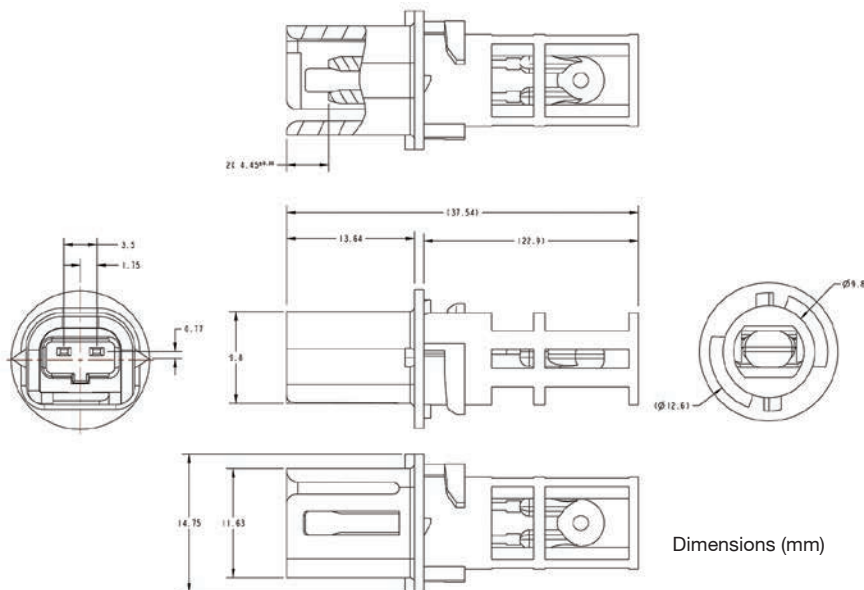

Temp. (°C)	Nominal Resistance	Resistance Tolerance $\pm\%$	Temp. Accuracy ($\pm^\circ\text{C}$)
-40	100,865	4.87	0.72
-35	72,437	4.69	0.72
-30	52,594	4.51	0.72
-25	38,583	4.32	0.71
-20	28,582	4.14	0.70
-15	21,371	3.96	0.69
-10	16,120	3.78	0.68
-5	12,261	3.59	0.67
0	9,399.2	3.41	0.65
5	7,263.3	3.23	0.64
10	5,657.9	3.05	0.62
15	4,440.9	2.86	0.60
20	3,511.0	2.68	0.58
25	2,795.0	2.50	0.56
30	2,239.6	2.45	0.56
35	1,805.9	2.41	0.57
40	1,464.9	2.36	0.57
45	1,195.1	2.32	0.58
50	980.26	2.27	0.58
55	808.78	2.23	0.59
60	670.90	2.19	0.59
65	559.40	2.15	0.60
70	468.74	2.12	0.61
75	394.64	2.08	0.61
80	333.76	2.04	0.62
85	283.50	2.00	0.62
90	241.81	2.09	0.67
95	207.09	2.19	0.71
100	178.03	2.28	0.76
105	153.64	2.38	0.82
110	133.08	2.47	0.87
115	115.68	2.56	0.93
120	100.91	2.66	0.98
125	88.32	2.75	1.04
130	77.54	2.78	1.08
135	68.29	2.81	1.12

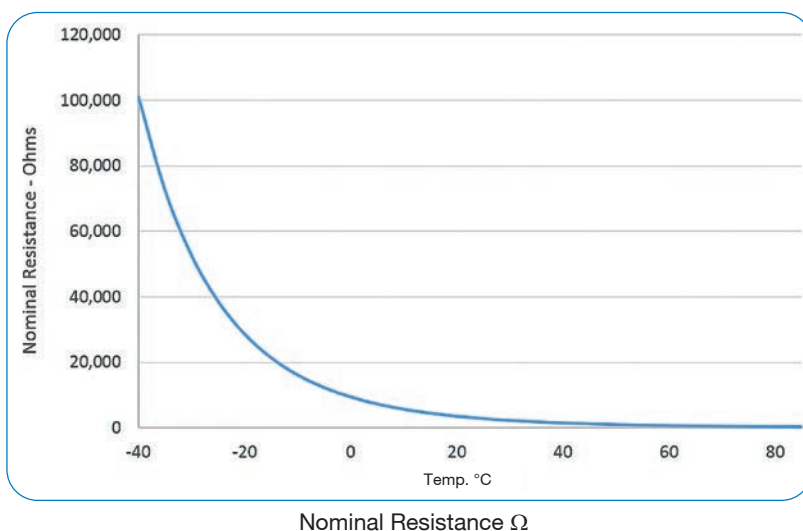

GE-2142 Specifications - Continued

Mounting Hole

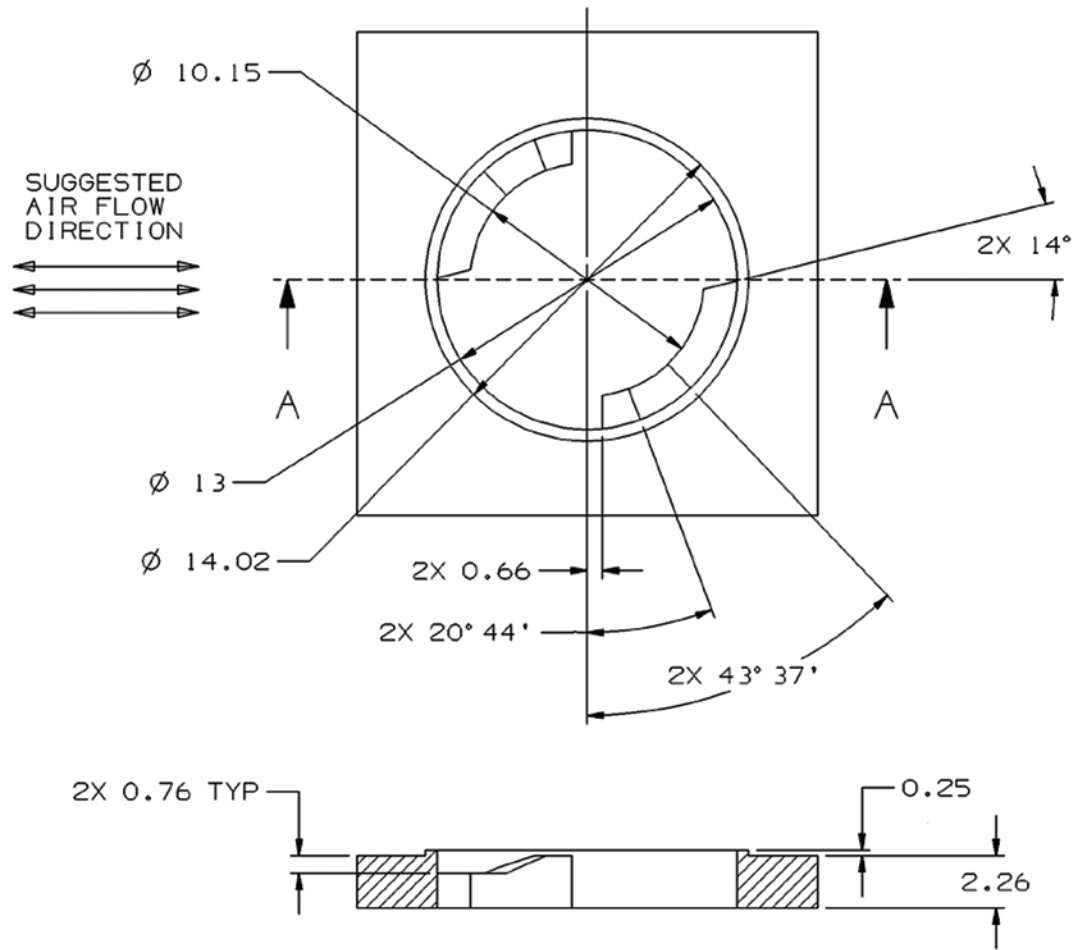

Mouser Electronics

Authorized Distributor

Click to View Pricing, Inventory, Delivery & Lifecycle Information:

[Amphenol:](#)

[GE-2142](#)