

1. MATERIALS AND FINISHES:
BODY - BERYLLIUM COPPER, GOLD PLATING
CONTACT - BERYLLIUM COPPER, GOLD PLATING
INSULATOR - PTFE
2. ELECTRICAL:
 - A. IMPEDANCE: 50 OHM
 - B. FREQUENCY RANGE: DC - 40 GHz
 - C. VSWR:
1.15:1 MAX AT DC TO 10 GHz
1.25:1 MAX AT 10 GHz-26.5 GHz
1.35:1 MAX AT 26.5 GHz TO 40 GHz
 - D. DIELECTRIC WITHSTANDING VOLTAGE: 500 VRMS, MIN.
3. MECHANICAL:
 - A. DURABILITY: 100 CYCLES MIN.
 - B. TEMPERATURE RANGE: -65° C TO 165° C
4. PACKAGING:
 - A. QUANTITY: SINGLE PACK
 - B. MARKING: BAG TO BE MARKED
"AMPHENOL, 925-142A-51S, AND DATE CODE"

REVISIONS

REV	DESCRIPTION	DATE	ECO	APPR
A	RELEASE TO MFG.	6/1/16	00941	MM

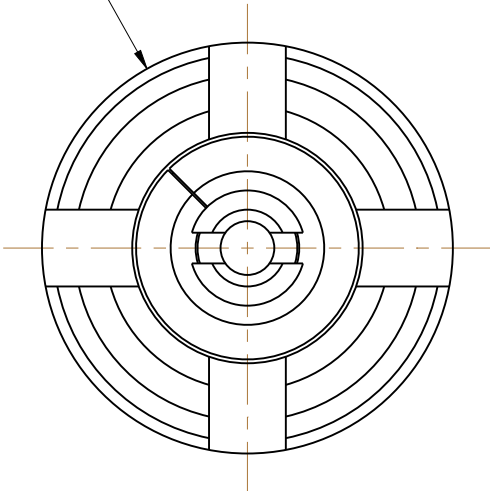
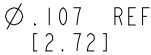
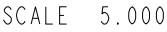

ALL OTHER SHEETS ARE FOR INTERNAL USE ONLY

UNLESS OTHERWISE SPECIFIED, DIMENSIONS ARE IN METRIC AND TOLERANCES ARE: <0.5mm 0.5 - 6mm 6 - 30mm 30 - 120mm ANGLES ± 0.05mm ±0.1mm ±0.2mm ± 0.3mm ±1°	MATERIAL	DRAWN	DATE	TITLE		Amphenol RF www.amphenolrf.com	
	-	E WANKOFF	11-Jan-13				
	NOTICE - These drawings, specifications, or other data (1) are, and remain the property of Amphenol corp. (2) must be returned upon request; and (3) are confidential and not to be disclosed to any person other than those to whom they are given by Amphenol Corp. the furnishing of these drawings, specifications, or other data by Amphenol Corp., or to any other person to anyone for any purpose is not to be regarded by implication or otherwise in any manner licensing, granting rights to permitting such holder or any other person to manufacture, use or sell any product, process or design, patented or otherwise, that may in any way be related to or disclosed by said drawings, specifications, or other data.	REFERENCE	ENGINEER	DATE	SMPM BULLET FEMALE-FEMALE .330" LONG		DRAWING NO.925-142A-51S
		5420 AND	E WANKOFF	11-Jan-13			
CONFIGURATION LEVEL:		APPROVED	DATE	DWG SIZE		REV	PART NO.925-142A-51S
FINISH		CAD FILE	B		A		

Mouser Electronics

Authorized Distributor

Click to View Pricing, Inventory, Delivery & Lifecycle Information:

[Amphenol:](#)

[925-142A-51S](#)