

REVISIONS			
REV	DESCRIPTION, ECN, EAR NO.	DATE	APP'D
K	PRODUCT DRAWING (EAR 13638)	DEC09/09	K.L.
L	PRODUCT DRAWING (EAR 14330)	DEC11/14	K.L.

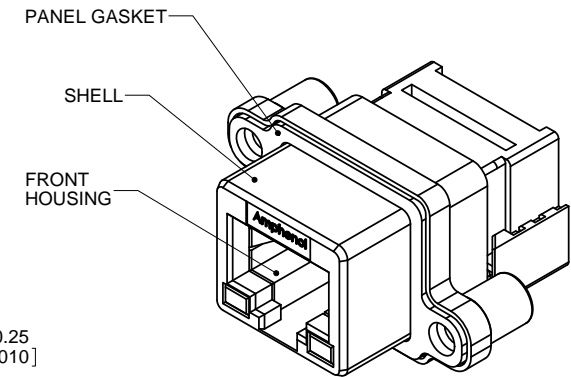
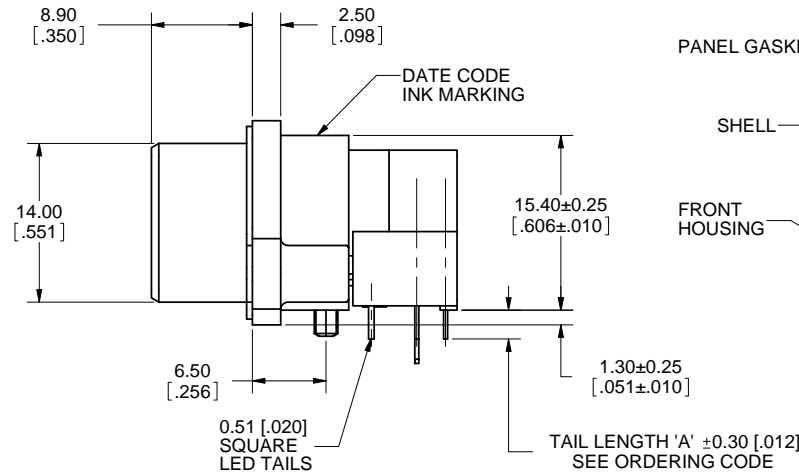
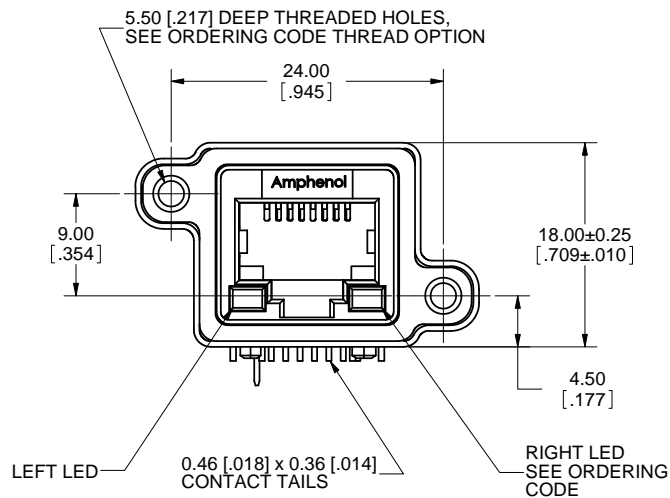

ORDERING CODE: **M R J - 5 3 X X - X 1**

SERIES, RUGGED RJ

RECEPTACLE, RIGHT ANGLE, PCB TAIL

NUMBER OF CONTACTS

8= 8 CONTACTS

A=10 CONTACTS

LED OPTION

0=NONE

1=GREEN LEFT, YELLOW RIGHT

4=YELLOW LEFT, GREEN RIGHT

5=GREEN LEFT, GREEN RIGHT

A=BI-COLOUR GREEN/YELLOW LEFT

BI-COLOUR GREEN/YELLOW RIGHT

D=GREEN LEFT

BI-COLOUR GREEN/YELLOW RIGHT

E=YELLOW LEFT

BI-COLOUR GREEN/YELLOW RIGHT

TAIL LENGTH AND MOUNTING HOLE THREAD OPTION

0= TAIL LENGTH A=2.54 [.100], #4-40 UNC THREAD

B= TAIL LENGTH A=3.81 [.150], #4-40 UNC THREAD

M= TAIL LENGTH A=2.54 [.100], M3 x 0.5 THREAD

P= TAIL LENGTH A=3.81 [.150], M3 x 0.5 THREAD

SINGLE PORT

#### NOTES:

- MATERIAL:  
ALL MATERIALS ARE RoHS COMPLIANT PER EU DIRECTIVE 2011/65/EU AND AMENDMENTS
  - SHELL - DIECAST ZINC, NICKEL PLATED
  - CONTACTS - PHOSPHOR BRONZE WITH 50 MICROINCHES (1.27 MICRONS) GOLD OVER 50 MICROINCHES (1.27 MICRONS) MINIMUM NICKEL ON THE MATING AREA AND MATTE TIN OVER NICKEL ON THE CONTACT TAILS.
  - INSERTS - ENGINEERING THERMOPLASTIC, UL FLAMMABILITY RATING 94V-0, REAR INSERTS: BLACK NYLON, FRONT INSERT: CLEAR POLYCARBONATE
  - LED'S - EPOXY LENS, STEEL TAILS WITH TIN PLATING
  - GASKET - SILICONE RUBBER, BLACK
- ENVIRONMENTAL PERFORMANCE PER IEC 60529 CODE IP67 FOR SEAL BETWEEN MATING AREA AND PCB SIDE OF CONNECTOR. GASKET PROVIDES SEAL TO INSIDE FACE OF PANEL.
- CURRENT RATING: 1.5 AMPERES
- CONTACT RESISTANCE: 30 MILLIOHMS MAXIMUM
- OPERATING TEMPERATURE: -40°C TO +105°C
- LED CHARACTERISTICS: FORWARD DC CURRENT 25 mA MAX., FORWARD VOLTAGE 2.5 V MAX @ 2 mA
- AVAILABLE MATING AREA COVERS PROVIDE ADDED PROTECTION. CONSULT WITH AMPHENOL CANADA FOR DETAILS.
- CUSTOMER TO VERIFY THAT ALL PROCESS CLEANERS ARE COMPATIBLE WITH POLYCARBONATE MATERIAL.

#### SPECIAL CONNECTORS

MANY UNIQUE FEATURES ARE READILY AVAILABLE TO SUIT CUSTOMER REQUIREMENTS. CONSULT WITH AMPHENOL CANADA FOR DETAILS.

UNLESS SPECIFIED OTHERWISE	DRAWN	S.SEMENOV	NOV11/04
PRIMARY UNITS MILLIMETERS	CHECKED		
SECONDARY INCHES	M.E. APP'D		
REFERENCE IN PARENTHESES	Q.A. APP'D		
GENERAL TOLERANCES	DWG APPR.	A. GREEN	NOV11/04
1 DECIMAL PLACE	ENG. REL. NO.		
2 DECIMAL PLACES ±0.15	REF.		
3 DECIMAL PLACES	THIRD ANGLE PROJECTION		
ANGULAR DEGREES			

**Amphenol Canada Corp.**  
www.amphenolcanada.com

MRJ SERIES RUGGED MODULAR JACK, 8 & 10 POSITION RIGHT ANGLE, WITH LED, TAIL LENGTH & THREAD OPTIONS, RoHS COMPLIANT

P-MRJ-53XX-X1

CODE ID NO. 03554 DWG. SIZE: C SCALE: 3:1 SHEET 1 OF 2

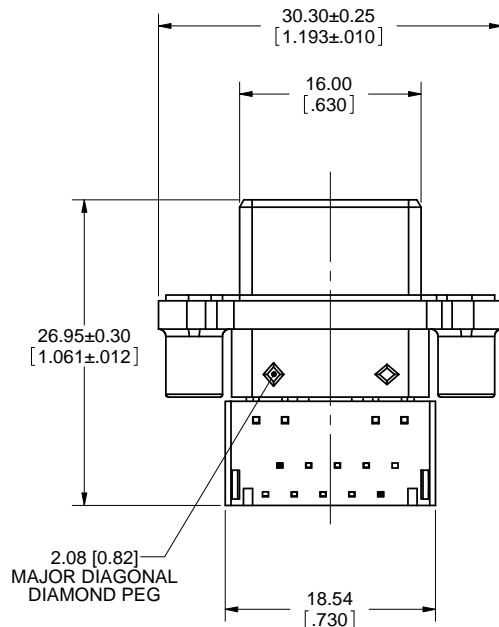

# RECOMMENDED P.C.B. LAYOUT COMPONENT SIDE OF BOARD



REVISIONS			
REV	DESCRIPTION, ECN, EAR NO.	DATE	APP'D
K	PRODUCT DRAWING (EAR 13638)	DEC09/09	K.L
L	PRODUCT DRAWING (EAR 14330)	DEC11/14	K.L

## 8 POSITION VIEW

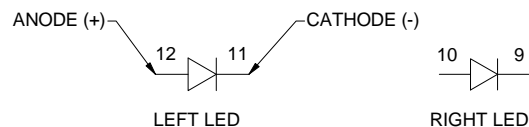
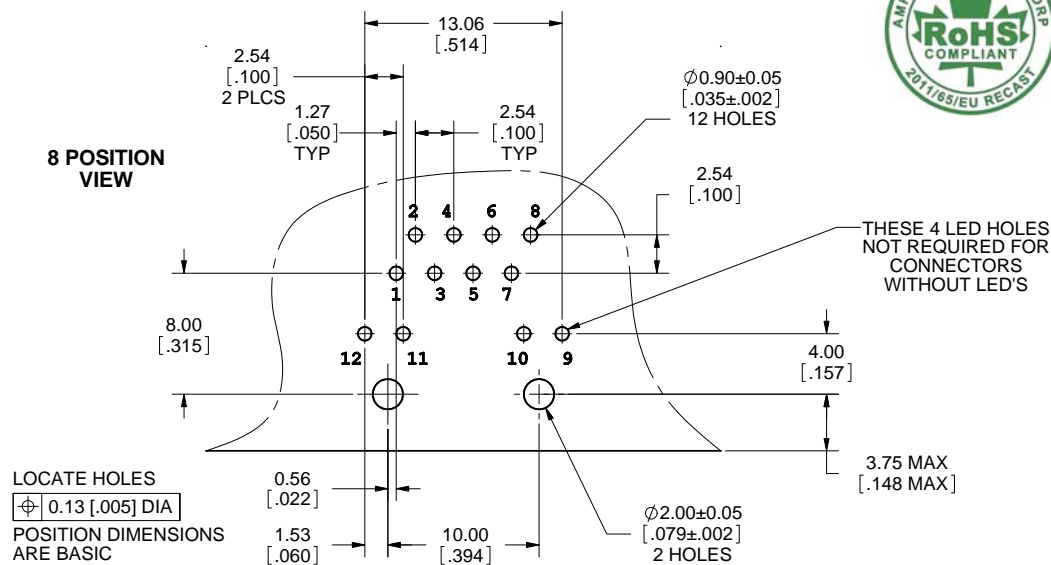

## 8 POSITION LED SCHEMATIC GREEN OR YELLOW

## 10 POSITION VIEW

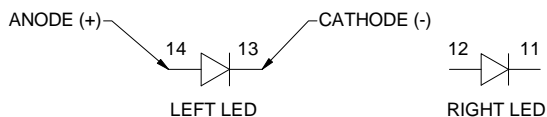
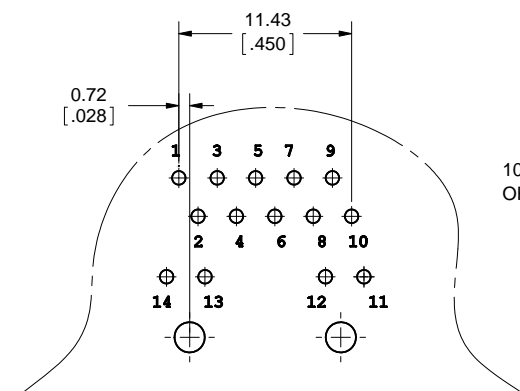

## 10 POSITION LED SCHEMATIC GREEN OR YELLOW

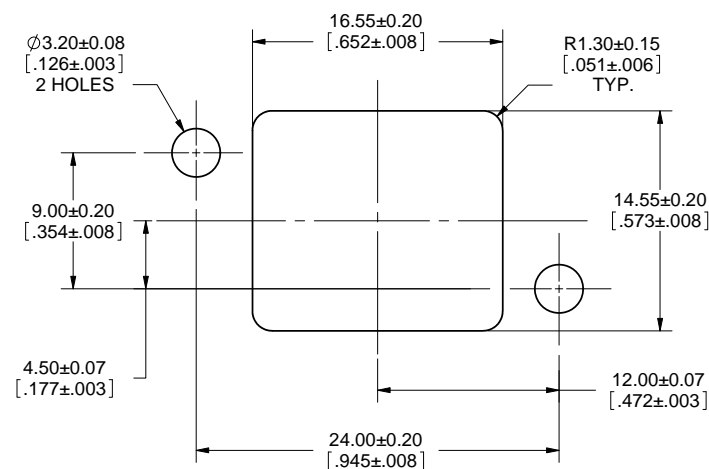

## RECOMMENDED PANEL CUTOUT FRONT OF PANEL

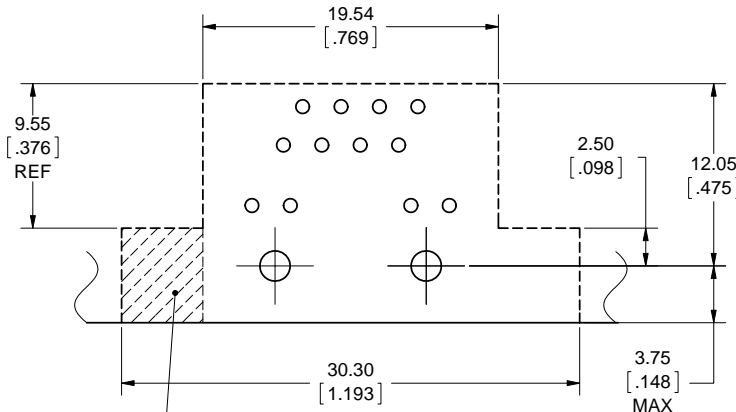

## RECOMMENDED KEEP-OUT ZONE COMPONENT SIDE OF BOARD

UNLESS SPECIFIED OTHERWISE	DRAWN	S. SEMENOV	NOV11/04
PRIMARY UNITS MILLIMETERS	CHECKED		
SECONDARY UNITS INCHES	M.E. APP'D		
REFERENCE IN PARENTHESES	Q.A. APP'D		
GENERAL TOLERANCES	DWG APPR.	A. GREEN	NOV11/04
1 DECIMAL PLACE	ENG. REL. NO.		
2 DECIMAL PLACES $\pm 0.15$	REF.		
3 DECIMAL PLACES	THIRD ANGLE PROJECTION		
ANGULAR DEGREES	DO NOT SCALE DRAWING		

<b>Amphenol Canada Corp.</b> www.amphenolcanada.com	
MRJ SERIES RUGGED MODULAR JACK, 8 & 10 POSITION RIGHT ANGLE, WITH LED, TAIL LENGTH & THREAD OPTIONS, RoHS COMPLIANT	
DWG. NO.	REV L
P-MRJ-53XX-X1	
CODE ID NO. 03554	DWG SIZE: C
SCALE: 3:1	SHEET 2 OF 2

# Mouser Electronics

Authorized Distributor

Click to View Pricing, Inventory, Delivery & Lifecycle Information:

[Amphenol:](#)

[MRJ-53A1-B1](#)