

RECOMMENDED P.C.B. LAYOUT  
(COMPONENT SIDE OF BOARD)

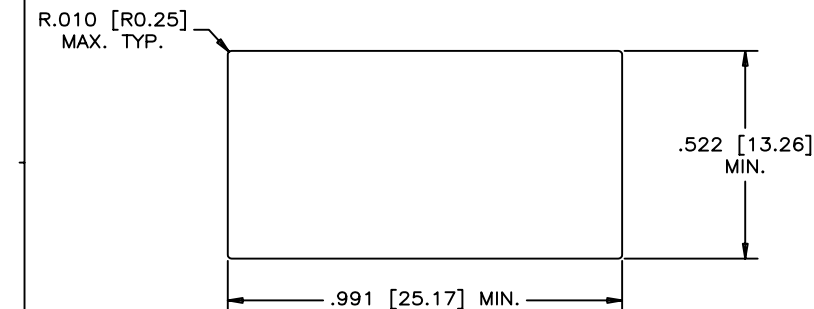

RECOMMENDED PANEL CUTOUT

THIS DOCUMENT CONTAINS PROPRIETARY INFORMATION AND SUCH INFORMATION MAY NOT BE DISCLOSED TO OTHERS FOR ANY PURPOSE OR USED FOR MANUFACTURING PURPOSES WITHOUT WRITTEN PERMISSION FROM AMPHENOL CANADA CORP.

REVISIONS				
SYM	ZONE	ECN, ERN NO.	DATE	APPRD.
D		REVISED PROPOSAL DRAWING	JAN13/09	L.CHAN

#### MATERIALS:

PLASTIC HOUSING: HIGH TEMPERATURE RESISTANT NYLON  
UL FLAMMABILITY RATING 94V-0.  
SOLDER REFLOW PROCESS COMPATIBLE.

CONTACTS: PHOSPHOR BRONZE

CONTACT PLATING: 50 MICROINCHES [1.27 MICRONS] MINIMUM GOLD  
ON MATING SURFACES  
50 MICROINCHES [1.27 MICRONS] MINIMUM NICKEL  
UNDERPLATE  
100 MICROINCHES [2.54 MICRONS] MATTE TIN  
ON CONTACT TAILS.

SHIELD: COPPER ALLOY; NICKEL PLATED WITH TIN DIPPED  
PCB TAILS.

RECOMMENDED SOLDERING TEMPERATURE:  
WAVE SOLDERING OR REFLOW SOLDERING AT 260°C  
MAXIMUM FOR 5 SEC MAXIMUM.

#### ELECTRICAL

- VOLTAGE RATING: 125 VAC RMS MAX.
- CURRENT RATING: 1.5 AMPS MAX.
- CONTACT RESISTANCE: 30 MILLIOHMS MAX.
- INSULATION RESISTANCE: 500 MEGAOHMS MIN.
- DWV: 1000VAC RMS 60 HZ , 1 MIN.

#### MECHANICAL

- MATING DURABILITY: 500 CYCLES MIN.
- PCB THICKNESS: .062"
- PCB RETENTION PRE-SOLDER: 1.0 LB MIN.
- PCB RETENTION POST-SOLDER: 10.0 LB MIN.

#### ENVIRONMENTAL

- STORAGE: -25 °C TO 80°C
- OPERATION: -10°C TO 70°C

#### REGULATORY

- UL AND CSA COMPLIANT.
- MEETS FCC PART 68 REQUIREMENTS

PART NUMBER: RJE01-662-02

DRAWN L.CHAN	DATE NOV.9/04	Amphenol Canada Corp.		
DESIGNED				
CHECKED K.LAMBIE	01/06/18	TITLE HIGH SPEED MODULAR JACK, 2 PORT, 6 POSITION, 6 CONTACTS, SHIELDED WITH TOP & SIDE GROUND TABS RoHS COMPLIANT		
I. E. APPRD.				
Q. A. APPRD.				
DWG. APPRD.				
ENG. REL. NO.		DWG C	DRAWING NO. P-RJE01-662-02	REV. D
REF. EAR 12575				
DIMENSIONS ARE IN INCHES [mm]	CODE ID. NO. 03554	SCALE 4/1	WT. -----	SURF. -----
		SHEET 1 OF 1		

# Mouser Electronics

Authorized Distributor

Click to View Pricing, Inventory, Delivery & Lifecycle Information:

[Amphenol:](#)

[RJE01-662-02](#)