

NOTES:

1. MATERIALS AND FINISHES:  
BODY - STAINLESS STEEL, PASSIVATED  
CONTACT - BERYLLIUM COPPER, GOLD PLATING  
INSULATOR - PTFE
2. ELECTRICAL:  
A. IMPEDANCE: 50 OHM  
B. FREQUENCY RANGE: DC - 18 GHz  
C. VSWR(RETURN LOSS): 1.15 (-23 dB), MAX.  
D. DIELECTRIC WITHSTANDING VOLTAGE: 1000 VRMS, MIN.
3. MECHANICAL:  
A. DURABILITY: 500 CYCLES MIN.  
B. TEMPERATURE RANGE: -65° C TO +165° C
4. PACKAGING:  
A. QUANTITY: SINGLE PACK  
B. MARKING: PACKAGING TO BE MARKED  
"AMPHENOL RF, PART NUMBER, AND DATE CODE"

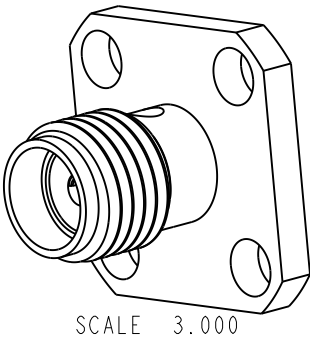
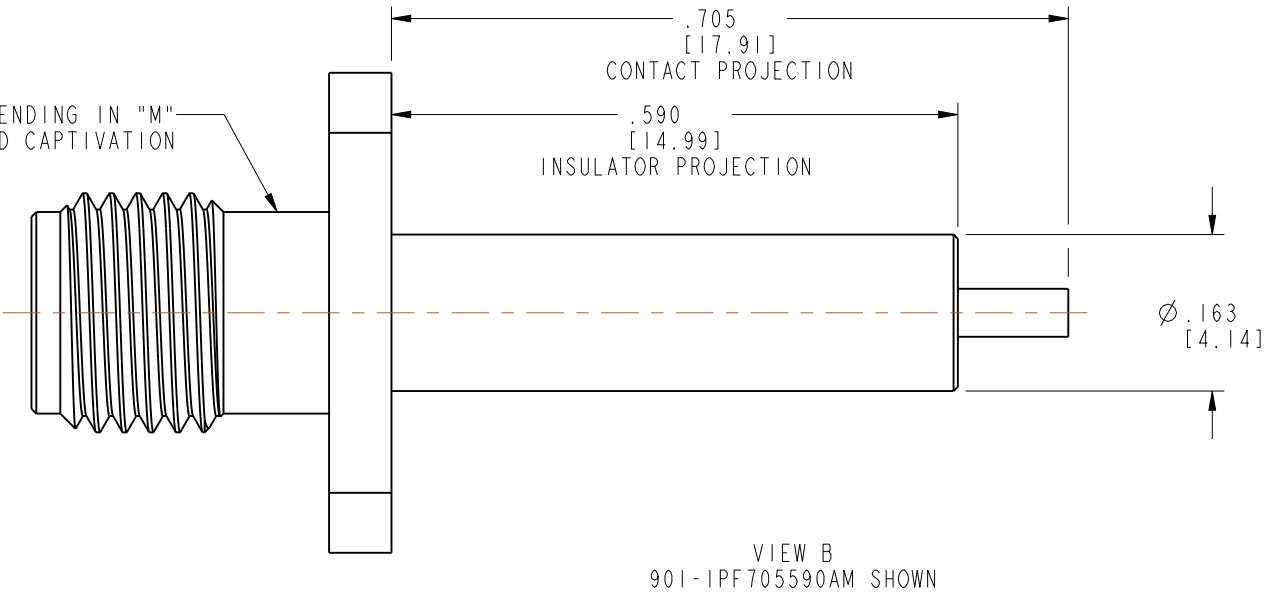
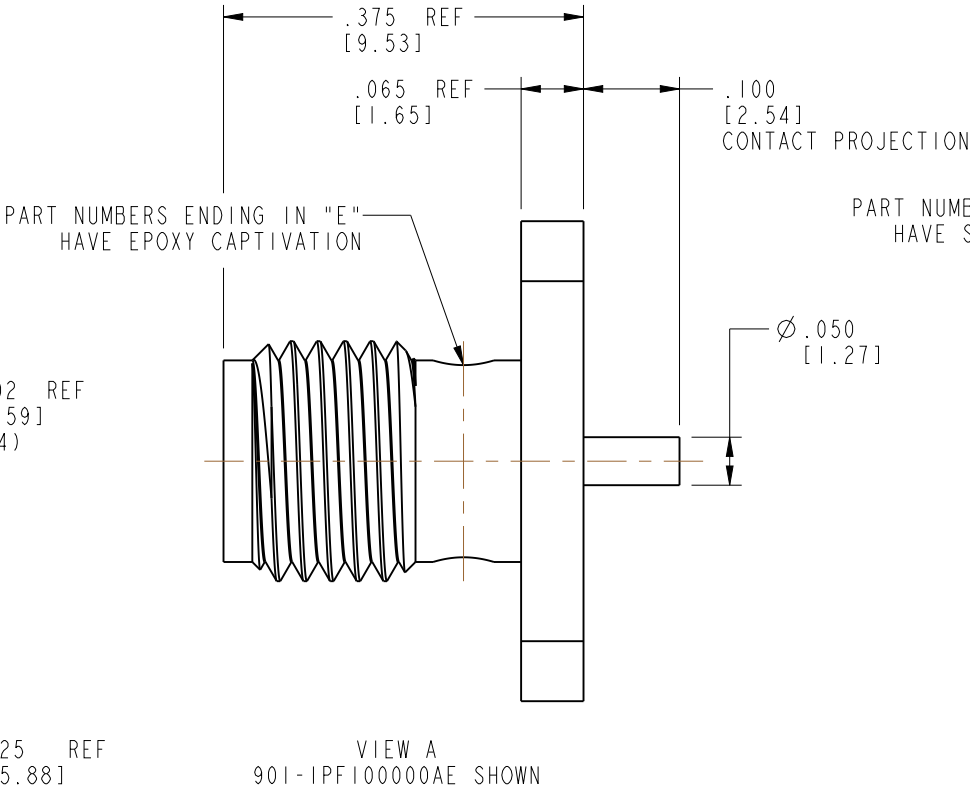
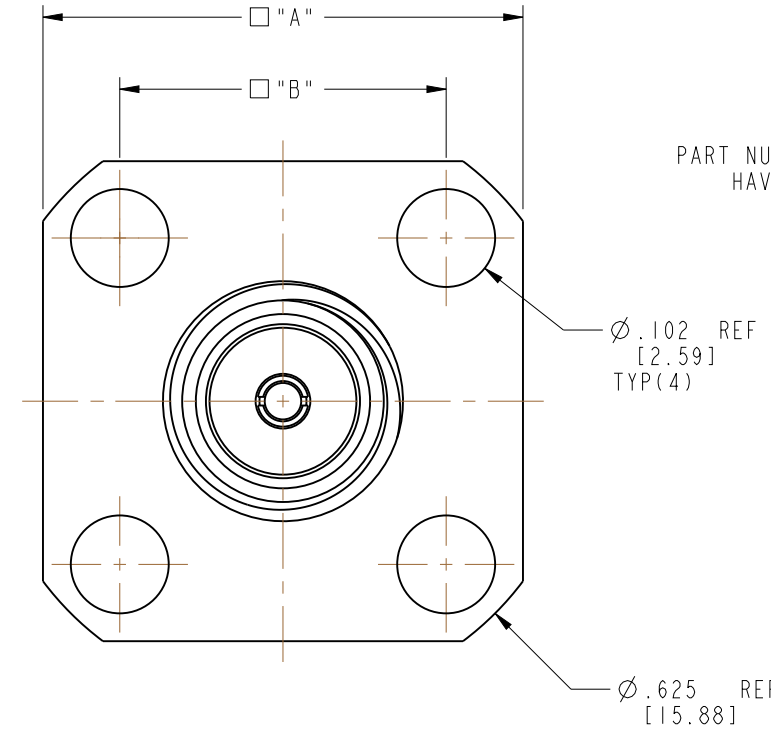

DRAWING NO.	"A" IN [MM]	"B" IN [MM]	CAPTIVATION
901-1PFXXXXYYAE	.375 [9.53]	.250 [6.35]	EPOXY
901-1PFXXXXYYAM	.375 [9.53]	.250 [6.35]	MECHANICAL
901-2PFXXXXYYAE	.500 [12.70]	.340 [8.64]	EPOXY
901-2PFXXXXYYAM	.500 [12.70]	.340 [8.64]	MECHANICAL
901-3PFXXXXYYAE	.687 [17.45]	.375 [9.53]	EPOXY
901-3PFXXXXYYAM	.687 [17.45]	.375 [9.53]	MECHANICAL
901-4PFXXXXYYAE	1.000 [25.40]	.689 [17.50]	EPOXY
901-4PFXXXXYYAM	1.000 [25.40]	.689 [17.50]	MECHANICAL

UNLESS OTHERWISE SPECIFIED, DIMENSIONS ARE IN INCHES AND TOLERANCES ARE:  
2 PLACE DECIMAL 3 PLACE DECIMAL ANGLES  
±.015 (0,381 mm) ±.005 (0,127 mm) ± 1°

NOTICE - These drawings, specifications, or other data (1) are, and remain the property of Amphenol corp. (2) must be returned upon request; and (3) are confidential and not to be disclosed to any person other than those to whom they are given by Amphenol Corp. the furnishing of these drawings, specifications, or other data by Amphenol Corp., or to any other person to anyone for any purpose is not to be regarded by implication or otherwise in any manner licensing, granting rights to permitting such holder or any other person to manufacture, use or sell any product, process or design, patented or otherwise, that may in any way be related to or disclosed by said drawings, specifications, or other data.

MATERIAL SEE NOTES	DRAWN C. VIGORITO	DATE 12-Oct-18
REFERENCE EAR: 7643 REF: 901-9215-3CCSF	ENGINEER C. VIGORITO	DATE 12-Oct-18
CONFIGURATION LEVEL: In Work	APPROVED K. CAPOZZI	DATE 08-Aug-19
FINISH	CAD FILE	

TITLE SMA PANEL JACK, POST CONTACT STEEL BODY PASSIVATED VARIOUS LENGTHS	SCALE: 5.0:1.0	SHEET 2 OF 2
DWG SIZE B	REV A	

Amphenol RF www.amphenolrf.com	
DRAWING NO.	901-XPFXXXXYYAX
ITEM NO.	901-XPFXXXXYYAX
PART NO.	901-XPFXXXXYYAX

THIRD ANGLE PROJ.

REVISIONS

REV	DESCRIPTION	DATE	ECO	APPR
A	RELEASE TO MFG.	08-Aug-19	12523	CJV

5. ORDERING INFORMATION:  
A. ADDITIONAL CANDLESTICK LENGTHS ARE AVAILABLE  
B. CHANGE XXX TO DESIRED CONTACT PROJECTION AND  
YYY TO DESIRED INSULATOR PROJECTION LENGTH IN INCHES.  
[.705 MAX. CONTACT PROJECTION, .050 MIN. CONTACT PROJECTION]  
C. EXAMPLE: 901-1PF100000AE HAS CONTACT PROJECTION OF .100 [2.54]  
AND NO INSULATOR PROJECTION,  
AS SHOWN IN "VIEW A".  
901-1PF705590AM HAS CONTACT PROJECTION OF .705 [17.91] AND  
INSULATOR PROJECTION OF .590 [14.99],  
AS SHOWN IN "VIEW B".  
D. CONTACT AMPHENOL RF MARKETING FOR QUOTE AND MORE INFORMATION.

**CUSTOMER OUTLINE DRAWING**  
ALL OTHER SHEETS ARE FOR INTERNAL USE ONLY

# Mouser Electronics

Authorized Distributor

Click to View Pricing, Inventory, Delivery & Lifecycle Information:

[Amphenol:](#)

[901-1PF705590AE](#)