

REV.	DATE	DESCRIPTION
NC	12/11/97	INITIAL RELEASE
A	01/08/07	REVISE DESCRIPTION, UPDATE DRAWING FORMAT

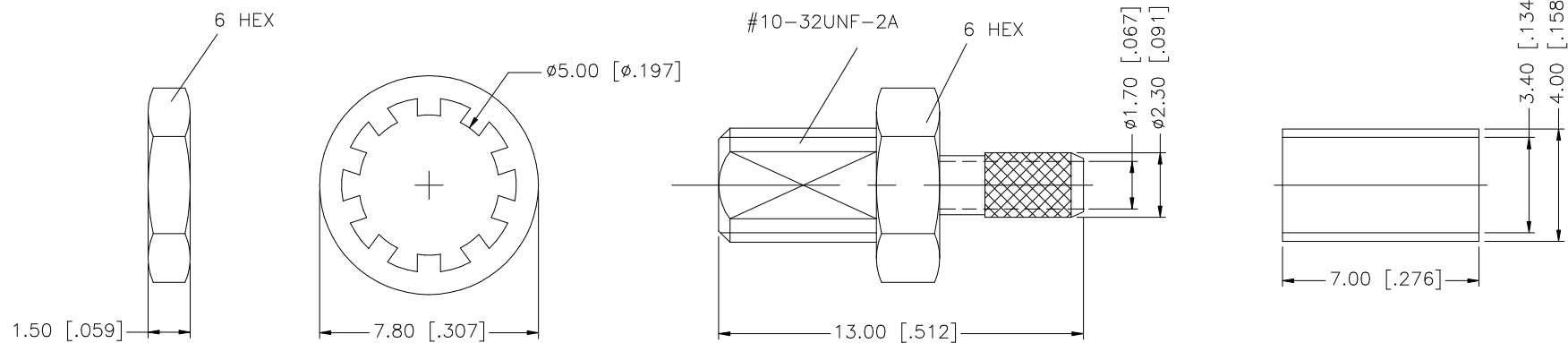

8					UNLESS OTHERWISE SPECIFIED DIMENSIONS ARE IN MILLIMETERS. DIMENSIONS IN [] ARE IN INCHES AND FOR CUSTOMER REFERENCE ONLY. UNLESS OTHERWISE SPECIFIED TOLERANCES FOR MILLIMETERS ARE: 0.5 – 8mm ± 0.20mm 8 – 30mm ± 0.40mm 30 – 120mm ± 0.50mm UNLESS OTHERWISE SPECIFIED TOLERANCES FOR INCHES ARE: .020 – .315 = ± 0.007" .315 – 1.180 = ± 0.015" 1.180 – 4.724 = ± 0.020"	APPROVALS		DATE		Amphenol Connex							
7						DRAWN	G.R.S.	01/08/07									
6						CHECKED				PART DESCRIPTION							
5	FERRULE	COPPER	NICKEL	1		ISSUED				BULKHEAD CABLE TERMINATOR (FOR RG-174/U, 316/U CABLE)							
4	HEX NUT	BRASS	NICKEL	1		SHEET	1 OF 1										
3	LOCK WASHER	BRASS	NICKEL	1					PART NO.								
2	INSULATOR	TEFLON	NATURAL	1					142207								
1	BODY	BRASS	NICKEL	1		CAD FILE	C:/142/142207.DWG		DWG. NO.	142207.DWG		REV.	A	SIZE	A	SCALE	NA
	DESCRIPTION	MATERIAL	FINISH	QTY	DO NOT SCALE DRAWING												

Mouser Electronics

Authorized Distributor

Click to View Pricing, Inventory, Delivery & Lifecycle Information:

[Amphenol:](#)

[142207](#)