

PC-Board layout  
view component side  
thickness 1,6 mm

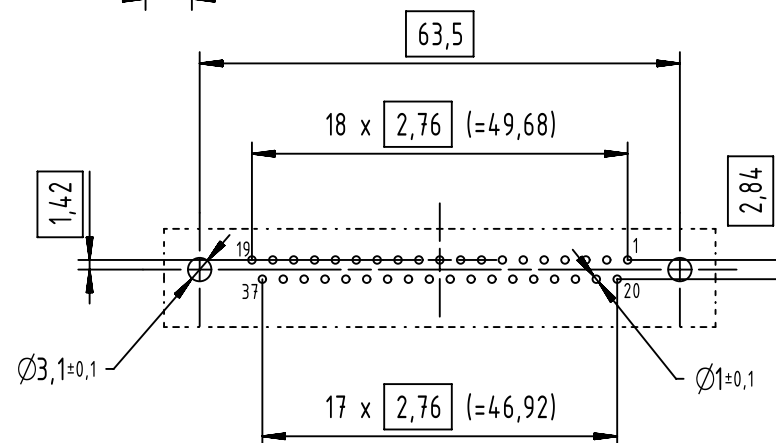

Connection retention and insertion forces on the PCB = 25 / 80 N

09664513533	M3	1
09664516533	M3	2
09664517533	M3	3
09664513513	4-40 UNC	1
09664516513	4-40 UNC	2
09664517513	4-40 UNC	3
Part number	Screw lock thread	Performance level



All Dimensions in mm  
Original Size DIN A4



All rights reserved  
Department EC PD - FR

HARTING Electronics GmbH

D-32339 Espelkamp

Scale

1:1

Free size tol.

Created by  
DOUGE

Inspected by  
BAGDIKIAN

Standardisation  
HOFFMANN

Ref.

Sub.

Date  
2014-02-04

State  
Final Release

Title

D-Sub 37-poles female straight board locks

Doc-Key / ECM-Nr.  
100566514 / UGD/001/A  
500000071016

Type

TB

Number

0966451X5X3

Rev.

A

Page  
1/1

# Mouser Electronics

Authorized Distributor

Click to View Pricing, Inventory, Delivery & Lifecycle Information:

HARTING:

09664516533