



Pushing Performance
Since 1945

Han 3A-HSI/P-DL-1Pg13,5-grey

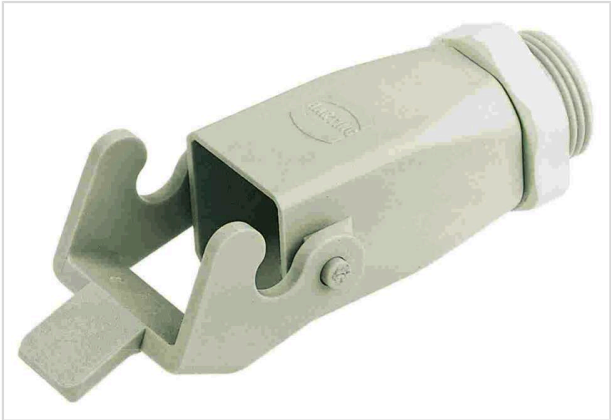

Image is for illustration purposes only. Please refer to product description.

Part number	09 20 003 0120
Specification	Han 3A-HSI/P-DL-1Pg13,5-grey
HARTING eCatalogue	https://b2b.harting.com/09200030120

Identification

Category	Hoods/Housings
Series of hoods/housings	Han A [®]
Type of hood/housing	Screw mounted housing

Version

Size	3 A
Cable entry	1x Pg 13.5
Locking type	Single locking lever
Field of application	Standard Hoods/housings for industrial applications
Pack contents	Please order seal screw separately.

Technical characteristics

Limiting temperature	-40 ... +125 °C
Note on the limiting temperature	For use as a connector according to IEC 61984.
Degree of protection acc. to IEC 60529	IP44 IP65 With seal screw IP67 With seal screw
Type rating acc. to UL 50 / UL 50E	4 4X 12

Material properties

Material (hood/housing)	Polycarbonate (PC)
Colour (hood/housing)	RAL 7032 (pebble grey)



Pushing Performance
Since 1945

Material properties

Material flammability class acc. to UL 94	V-0
RoHS	compliant with exemption
RoHS exemptions	6(c): Copper alloy containing up to 4 % lead by weight
ELV status	compliant with exemption
China RoHS	50
REACH Annex XVII substances	Not contained
REACH ANNEX XIV substances	Not contained
REACH SVHC substances	Yes
REACH SVHC substances	Lead
California Proposition 65 substances	Yes
California Proposition 65 substances	Lead
Fire protection on railway vehicles	EN 45545-2 (2020-08)
Requirement set with Hazard Levels	R22 (HL 1-3)
	R23 (HL 1-3)

Specifications and approvals

UL / CSA	UL 1977 ECBT2.E235076
	CSA-C22.2 No. 182.3 ECBT8.E235076
Approvals	CE
	DNV GL

Commercial data

Packaging size	10
Net weight	17 g
Country of origin	Romania
European customs tariff number	85389099
GTIN	5713140038387
ETIM	EC000437
eCl@ss	27440202 Shell for industrial connectors

Mouser Electronics

Authorized Distributor

Click to View Pricing, Inventory, Delivery & Lifecycle Information:

[HARTING:](#)

[09200030120](#)