

882-004 PC Tail Panel Mnt Receptacle, Threaded Coupling, 40GbE



40GbE. Ultraminiature. Rear panel jam-nut mount. PCB terminals.

882-004 SuperFly Datalink connectors have one, El Ochoito® octaxial contact housing eight socket contacts. Attach to .100" (2.54 mm) maximum thickness panel with spanner nut. PC tail contacts are gold plated or solder dipped in 63/37 tin-lead. Contacts are epoxy-sealed and are non-removable. Gold-plated EMI spring for low shell-to-shell resistance, fluorosilicone O-rings for water-tight seal. *Mates to 882-003 plug.*

SIZE AND WEIGHT SAVING

- Smallest 40Gb Ethernet aerospace-grade connector

FAST ASSEMBLY

- Pre-tinned PC tail contacts
- Epoxy-sealed terminals

HARSH ENVIRONMENT

- EMI protection
- Water ingress
- Shock and vibration

Recommended PC Board Layout

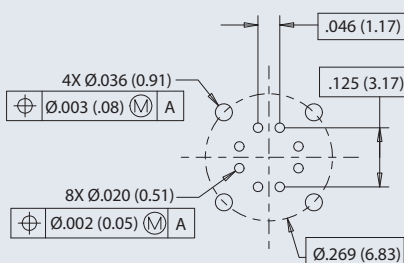

RECOMMENDED PCB LAYOUT
CONNECTOR SIDE
SEE AN0002 FOR OPTIMAL PERFORMANCE
(MAINTAIN Ø.036 ON Ø.269 FOR GROUND PINS)

How To Order PC Tail Panel Mnt Receptacle

Sample Part Number	882-004	- M	G	-.125
Product	882-004 = Panel Mount PC Tail Receptacle			
Shell Finish	M = Aluminum / Electroless Nickel MT = Aluminum / Nickel-PTFE ZK = Stainless Steel / Passivate			
PC Tail Finish	S = Solder dip, 63/37 tin-lead G = Gold			
PC Tail Length	.080 = .080" (2.03 mm.) .175 = .175" (4.45 mm.)	.125 = .125" (3.18 mm.) .200 = .200" (5.08 mm.)		

Recommended Panel Cutout

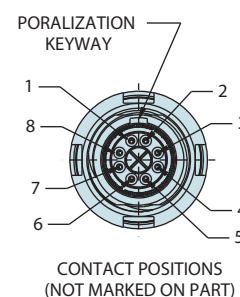
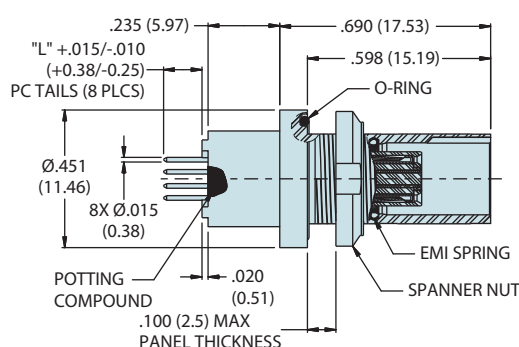
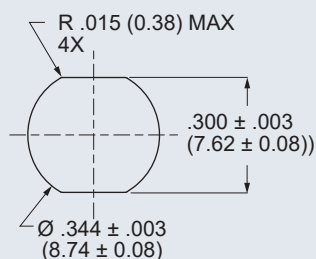

Specifications

- ❑ **Operating temp.:** -65° to +175°C
- ❑ **Impedance:** 100 ohms
- ❑ **DWV:** 500 Vrms unmated
- ❑ **Current Rating:** 1.5 A
- ❑ **IR:** 1000 MΩ min.
- ❑ **Durability:** 2000 mating cycles
- ❑ **Ingress protection:** IP67

Construction

- ❑ **Shell, jam-nut:** aluminum alloy or SST
- ❑ **Insulators:** high-grade rigid dielectric
- ❑ **Contacts:** copper alloy, 50 microinches gold over nickel plating
- ❑ **O-rings:** fluorosilicone
- ❑ **EMI spring:** stainless steel, gold plated
- ❑ **Spline:** copper alloy, electroless nickel plated
- ❑ **Potting:** epoxy

Spanner Nut Tightening Tool

Nickel-plated tool steel, 1/4" sq. drive
13 - 18 in.-lbs. recommended torque



Mouser Electronics

Authorized Distributor

Click to View Pricing, Inventory, Delivery & Lifecycle Information:

[Glenair:](#)

[882-004-ZRS-.125](#)