

THE INFORMATION CONTAINED IN THIS DRAWING IS THE SOLE PROPERTY OF L-COM, INC. ANY REPRODUCTION IN PART OR WHOLE WITHOUT THE WRITTEN PERMISSION OF L-COM, INC. IS PROHIBITED.

MODEL# HMA6-XXXXY

1st SUFFIX = CONNECTOR TYPE

2nd SUFFIX = CABLE LENGTH (FT)
01 TO 10 FEET
(+1 INCH, -0)

APM	ALPROX MALE
MC	MC CARD MALE
MCX	MCX MALE
MM	MMCX MALE
MMR	MMCX R/A
NM	N-MALE
RSP	RP SMA PLUG
RTJ	RP TNC JACK
RTP	RP TNC PLUG
SEP	SE PLUG
SM	SMA MALE
SMR	SMA MALE R/A
SBP	SBP PLUG
SBJ	SBJ JACK
SNP	SMA NANO PLUG
NF	N-FEMALE
RBP	RP BNC PLUG
RSJ	RP SMA JACK
TM	TNC MALE
BM	BNC MALE

EXAMPLE:
HMA6-NF02

REVISIONS

REV	DESCRIPTION	DATE	APPROVED
A	INITIAL RELEASE	09/08/11	B.PUCHASKI
-	-	-	-
-	-	-	-

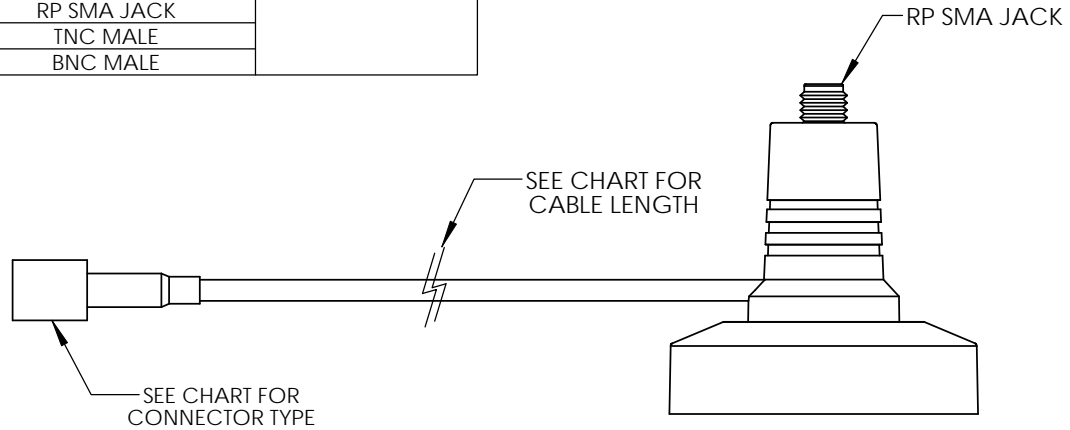
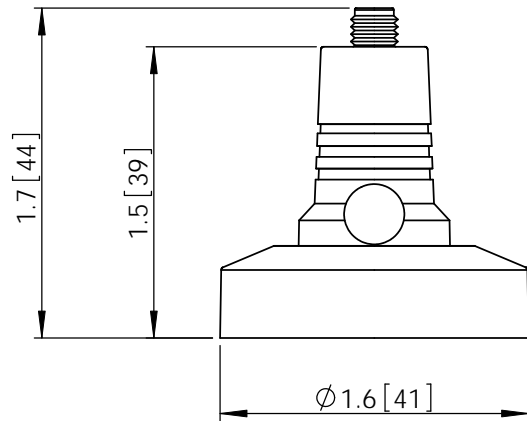

NOTES:
PACKAGING:
COMPONENT SHALL BE PACKAGED IN ACCORDANCE
WITH L-COM SPEC PKG-00012.
-ALL DIMENSIONS FOR REFERENCE-

RoHS Compliant ✓

UNLESS OTHERWISE SPECIFIED, DIMENSIONS ARE IN INCHES [mm] DIMENSIONAL TOLERANCES: .X = ±.1 .XX = ±.01 .XXX = ±.005 ANGULAR TOLERANCES: ALL = ± 1° PROJECTION 	APPROVALS	DATE	 45 BEECHWOOD DRIVE NORTH ANDOVER, MA 01845	
	DRAWN BY B.PUCHASKI	09/08/11		
	CHECKED BY P.PESA	09/08/11	CATEGORY ANTENNA MOUNT	
	APPROVED BY P.PESA	09/08/11	PRODUCT DESCRIPTION RUBBER DUCK MAGNETIC MOUNT W/ 100 SERIES CABLE AND CONNECTOR	
CONFIGURATION DETAILS OF UNDIMENSIONED FEATURES MAY VARY		SIZE A	FSCM NO. 43321	DWG. NO. HMA6-XXXXY
COLOR VARIATIONS MAY OCCUR		SCALE: NONE	CAD FILE: HMA6-XXXXY.SLDDRW	REV. A
		SHEET 1 OF 1		

Mouser Electronics

Authorized Distributor

Click to View Pricing, Inventory, Delivery & Lifecycle Information:

[infinite Electronics:](#)

[HMA6-RTP05](#) [HMA6-SM05](#) [HMA6-RSP10](#) [HMA6-RSP05](#) [HMA6-RTP10](#)