

# Test Probes 4 mm Safety System



## Type

### PRUEF 2700

Safety test probe with dual function. Tip for penetrating insulation and oxide layers and 4 mm diameter pin for insertion in sockets. 4 mm diameter brass socket connection. Connects with safety measuring leads.

Tip diameter

4 mm (0.157 in.)

PART NO. / Housing color

**972319100** ●  
**972319101** ●



### PRUEF 2600

Test probe with elastic, shatter-proof insulated sleeve and slender stainless steel tip. Tip for penetration of insulation and oxide layers. 4 mm diameter brass socket connection. Connects with safety measuring leads. Accessory tip protector and IC tap SS 260.

2 mm (0.78 in.)

**972317100** ●  
**972317101** ●

## Technical Data

Connection Type	stationary tip
Voltage Rating	fixed socket Ø 4 mm
Measurement Category (IEC61010)	AC/DC 1000 V
Current Rating*	CAT II
Contact Resistance	32 A
<b>Material Specifications</b>	2 mOhm
Tip	nickel plated brass
Connection pin/ socket	nickel plated brass
Contact Spring	-
Housing	PP
<b>Environmental Conditions</b>	
Temperature range	-25 °C to +80 °C (13°F to 176°F)
<b>Flamability Rating</b>	
Housing	UL 94 HB

stationary tip
fixed socket Ø 4 mm
AC/DC 1000 V
CAT III
1 A
50 mOhm
stainless steel
nickel plated brass
-
PP
-25 °C to +80 °C (13°F to 176°F)
UL 94 HB

## Drawing

Measurements are shown in millimeters.  
Multiply by 0.03937 to convert to inches.

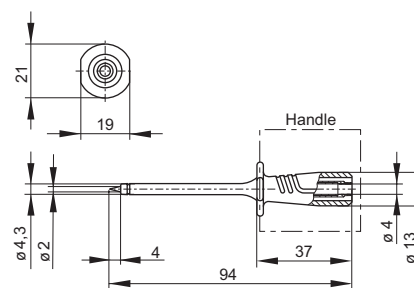
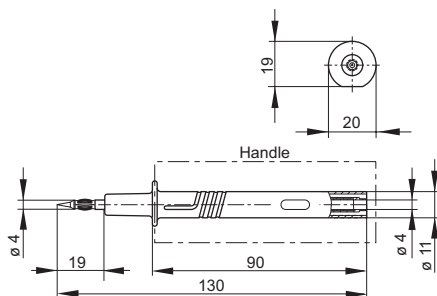

\* Please consider derating graph on page 80.

# Mouser Electronics

Authorized Distributor

Click to View Pricing, Inventory, Delivery & Lifecycle Information:

[Altech:](#)

[972319101](#) [972317101](#) [972319100](#) [972317100](#)