

Test Plugs 4 mm System

Type

VQ 20

4mm spring loaded plug with 4mm cross hole, flexible insulation sleeve, nickel plated brass, screw terminal max. 1.5mm².

Pin diameter

4 mm (0.157")

PART NO. / Housing color

- 930058100
- 930058101
- 930058102
- 930058103
- 930058104
- 930058107

VQ 30

4mm spring loaded plug with 4mm cross hole, flexible insulation sleeve, nickel plated brass, solder terminal max. 2.5mm².

4 mm (0.157")

- 930061100
- 930061101
- 930061102
- 930061103
- 930061104
- 930061107

Technical Data

Contact Type	spring loaded pin
Connection Type	screw terminal max. 1.5mm ²
Voltage Rating	30 VAC / 60 VDC
Measurement Category (IEC61010)	CAT I
Current Rating*	16A
Contact Resistance	3 mOhm

Material Specifications

Plug	nickel plated brass
Contact Spring	-
Housing	PVC-P

Environmental Conditions

Temperature range	-25°C to +70°C (-13 to 158°F)
-------------------	-------------------------------

Flamability Rating

Housing	-
---------	---

spring loaded pin	
solder terminal max. 2.5mm ²	
30 VAC / 60 VDC	
CAT I	
30A	
3 mOhm	

nickel plated brass	
-	
PP	

-25°C to +70 °C (-13 to 158°F)	
--------------------------------	--

Drawing

Measurements are shown in millimeters.
Multiply by 0.03937 to convert to inches.

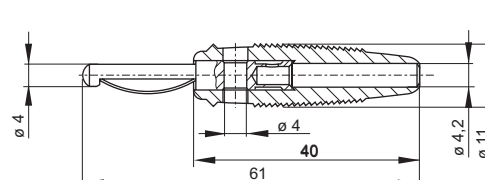
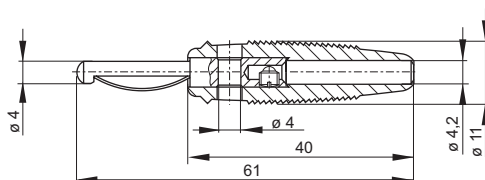

* Please consider derating graph on page 80.

Mouser Electronics

Authorized Distributor

Click to View Pricing, Inventory, Delivery & Lifecycle Information:

[Altech:](#)

[930058101](#) [930061104](#) [930061107](#) [930058103](#) [930061101](#) [930061100](#) [930058104](#) [930058107](#) [930061103](#)
[930061102](#) [930058102](#) [930058100](#)