

## ENM2 Series Limit Switches

### ENM2 AHT

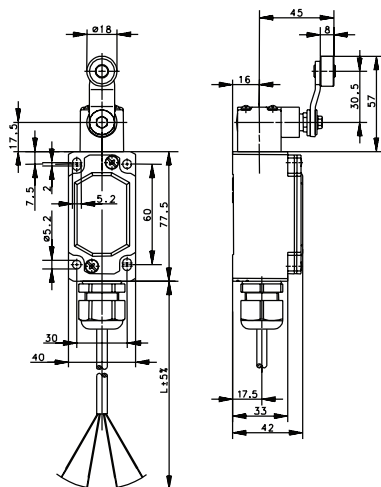

### ENM2 AD

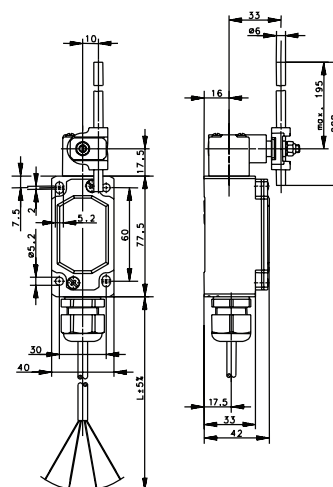

6.5' (2 meter) connection cable

**609.7185.082**  
ENM2-SU1Z EX AHT -2M-

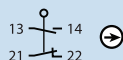

**609.7187.092**  
ENM2-SU1 EX AD -2M-



16.4' (5 meter) connection cable

**609.7185.084**  
ENM2-SU1Z EX AHT -5M-



**609.7187.094**  
ENM2-SU1 EX AD -5M-



29.5' (9 meter) connection cable

**609.7185.085**  
ENM2-SU1Z EX AHT -9M-

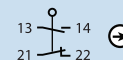

**609.7187.095**  
ENM2-SU1 EX AD -9M-



#### EX Certification

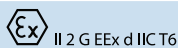

#### Technical Information

Maximum Switching Voltage  
Maximum Switching Amperage  
B10d  
Mechanical Service Life  
Switching Frequency  
Operating Temperature  
Protection Rating  
Utilization Category  
Rate Insulation Voltage

230V  
5A  
4 Million  
2 x 10<sup>6</sup>  
≤ 50/min  
-20 °C to +65 °C  
IP66 / IP67  
AC 15, 240 V / 3 A;  
DC 13, 250 V / 0.27 A  
250VAC

230V  
5A  
4 Million  
2 x 10<sup>6</sup>  
≤ 50/min  
-20 °C to +65 °C  
IP66 / IP67  
AC 15, 240 V / 3 A;  
DC 13, 250 V / 0.27 A  
250VAC

Drawing dimensions in mm

# Mouser Electronics

Authorized Distributor

Click to View Pricing, Inventory, Delivery & Lifecycle Information:

[Altech:](#)

[609.7185.082](#) [609.7185.085](#) [609.7185.084](#) [609.7187.092](#) [609.7187.094](#) [609.7187.095](#)