

## Ti2 Series

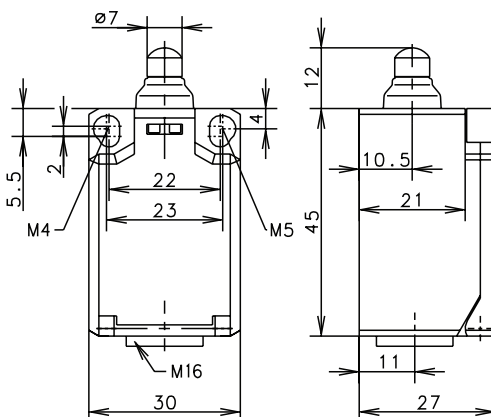

**W (Form B)**



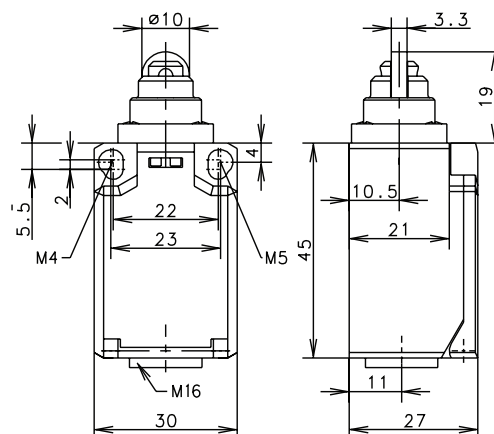

**RIW (Form C)**

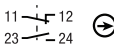
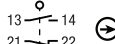
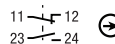
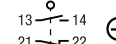
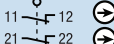
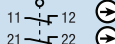
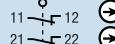
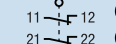
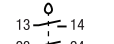
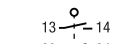

Switching Operation	Slow Action	Snap Action	Slow Action	Snap Action
<b>1 NC / 1 NO Contacts</b>	<b>608.8103.001</b> TI2-U1Z W 	<b>608.8153.002</b> TI2-SU1Z W 	<b>608.8117.007</b> TI2-U1Z RIW 	<b>608.8167.008</b> TI2-SU1Z RIW 
<b>2 NC Contacts</b>	<b>608.8803.003</b> TI2-A2Z W 	<b>608.8853.004</b> TI2-SA2Z W 	<b>608.8817.009</b> TI2-A2Z RIW 	<b>608.8867.010</b> TI2-SA2Z RIW 
<b>2 NO Contacts</b>	<b>608.8803.005</b> TI2-E2 W 			<b>608.8867.012</b> TI2-SE2 RIW 
<b>1 NC / 1 NO Contacts Overlapping</b>	-	-	-	-

### Technical Information

	Slow Action	Snap Action	Slow Action	Snap Action
Maximum Switching Voltage	240V	240V	240V	240V
Maximum Switching Amperage	10A	10A	10A	10A
B10d	6 Million	6 Million	6 Million	6 Million
Mechanical Service Life	3 x 10 <sup>6</sup>	3 x 10 <sup>6</sup>	3 x 10 <sup>6</sup>	3 x 10 <sup>6</sup>
Switching Frequency	≤ 100/min	≤ 100/min	≤ 100/min	≤ 100/min
Operating Temperature	-30 °C to +80 °C	-30 °C to +80 °C	-30 °C to +80 °C	-30 °C to +80 °C
Protection Rating	IP65	IP65	IP65	IP65
Utilization Category	AC-15, Ue/Ue 240V 3A	AC-15, Ue/Ue 240V 3A	AC-15, Ue/Ue 240V 3A	AC-15, Ue/Ue 240V 3A
Rate Insulation Voltage	240VAC	240VAC	240VAC	240VAC
Approvals				

### Special features / variants

- Available with greater switching force

### Special features / variants

- Available with greater switching force
- Available different actuator direction
- Activation direction can not be rotated by user

Drawing dimensions in mm

# Mouser Electronics

Authorized Distributor

Click to View Pricing, Inventory, Delivery & Lifecycle Information:

[Altech:](#)

[608.8153.002](#) [608.8867.010](#) [608.8817.009](#) [608.8167.008](#) [608.8853.004](#) [608.8803.003](#) [608.8803.005](#)  
[608.8103.001](#) [608.8117.007](#) [608.8867.012](#) [610.8351.008](#) [610.8101.036](#) [610.8357.004](#) [610.8701.003](#) [610.8851.040](#)