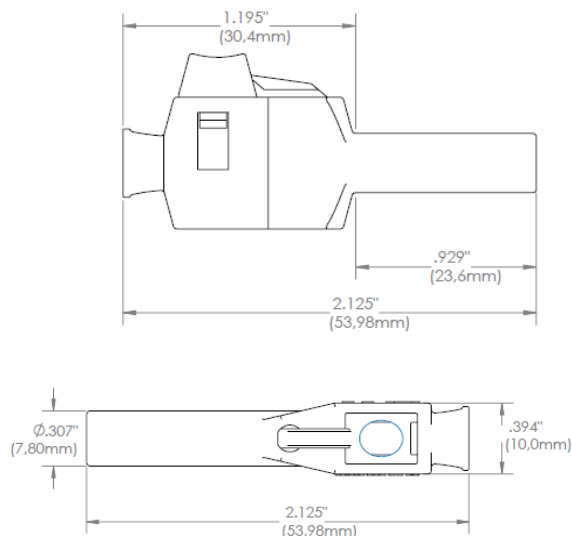
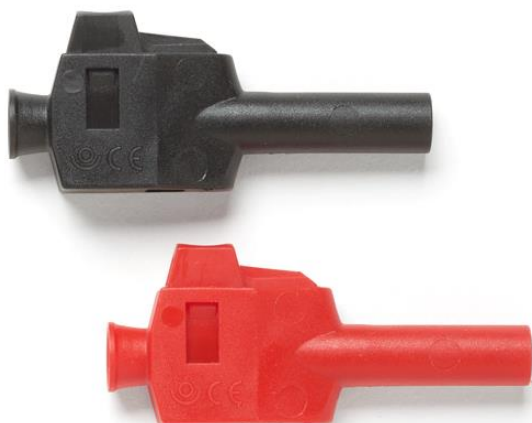

Model 73091**DIY Sheathed 4mm Banana Plug, Quick Wire Attachment****Features**

- Attach wires quickly with the push-button tab for easy assembly or test lead repair
- No soldering or set screws required; simply, push and hold the push tab, insert the stripped test lead wire (*strip 4-6mm of insulation*), and release the push tab to secure the wire down
- Banana plug contact is sheathed for higher voltage and added protection
- Make 4mm banana plug test leads conveniently in the field
- Designed to fit on the end of any 22 AWG to 18 AWG wire gauge

Materials

Contact: Nickel-plated brass and steel
Insulation: Polypropylene and Polyoxymethylene

Specifications

Voltage	*CAT II 600 V / CAT III 300 V
Max Current	20 A
Max Resistance	less than 10 mΩ
*When plug is correctly assembled and terminated	

Ordering Information

Model: 73091-*color*

Color: 0=Black, 2=Red

Do-it-Yourself Sheathed 4mm Banana Plug, Quick Wire Attachment

USA: Sales: 800-490-2361
Technical Support: technicalsupport@pomonatest.com
Fax: 425-446-5844
Europe: 31-(0) 40 2675 150 **International:** 425-446-5500
Where to Buy: www.pomonaelectronics.com

All dimensions are in inches. Tolerances (except noted): .xx = $\pm .02$ " (.51 mm), .xxx = $\pm .005$ " (.127 mm). All specifications are to the latest revisions. Specifications are subject to change without notice. Registered trademarks are the property of their respective companies.

Mouser Electronics

Authorized Distributor

Click to View Pricing, Inventory, Delivery & Lifecycle Information:

Pomona:

73091-2 73091-0