

Model 2143

Double Miniature Banana Jack

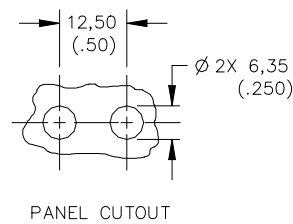
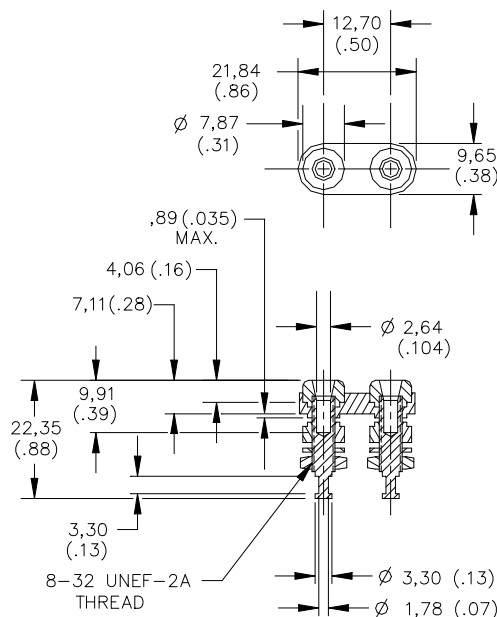
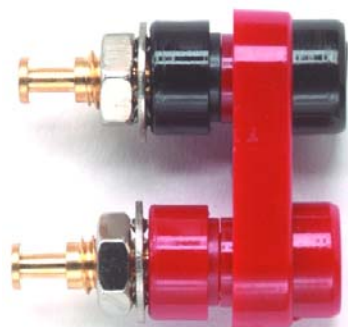

MODEL NO.	MTG. PLATE COLOR
2143-0	BLACK PLATE
2143-2	RED PLATE

Features

- Accepts miniature banana plugs.
- Mounts in panels up to .188" thick.

Materials

Miniature Banana Jack:

- Body – Gold plated brass
- Lockwasher #8 – Nickel Plated Steel
- Hex Nut #8-32 – Nickel Plated Brass
- Insulation – Polycarbonate, Color: One Red and one Black
- Panel Insulator – Polycarbonate

Ratings

- Operating Voltage: For *CE Compliance* and for personal safety, do not hold in hand when voltages exceed 30 Vrms/60 Vdc. Maximum voltage for *hands free use*: 1500 Vrms. Do not use on circuits where transient stresses can exceed the rated voltage.
- Operating Temperature: +115°C (+239°F) Max.
- Operating Current: 5 Amperes Max.

Ordering Information

Model: 2143-*

* = Standard Mounting Base Color: -0 Black, -2 Red

Ordering Example: 2143-2, Mounting Base Color is Red.

USA: Sales: 800-490-2361
 Technical Support: technicalsupport@pomonatest.com
 Fax: 425-446-5844
Europe: 31-(0) 40 2675 150 **International:** 425-446-5500
Where to Buy: www.pomonaelectronics.com

All dimensions are in inches. Tolerances (except noted): .xx = ±.02" (.51 mm), .xxx = ±.005" (.127 mm). All specifications are to the latest revisions. Specifications are subject to change without notice. Registered trademarks are the property of their respective companies.

Mouser Electronics

Authorized Distributor

Click to View Pricing, Inventory, Delivery & Lifecycle Information:

Pomona:

[2143-0](#) [2143-2](#) [2143-0#](#)