

Models 72912 Panel Mt IEC1010 Banana Jacks for Sheathed Plugs

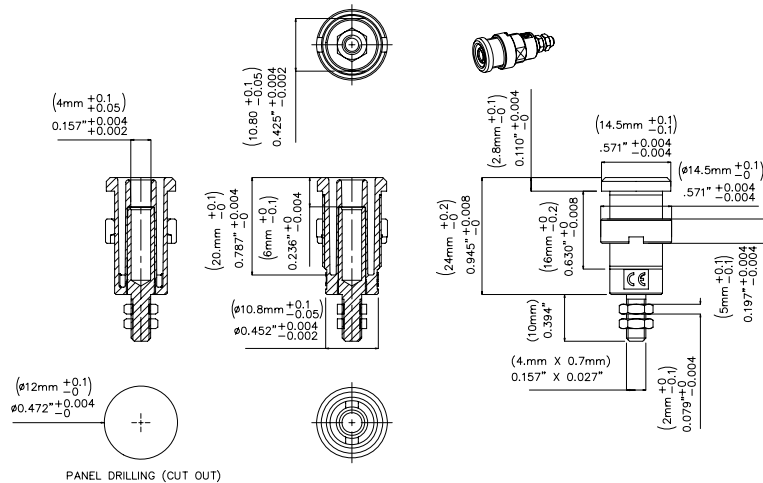

Features

- Panel Mt IEC1010 4mm (0.16in) jack for sheathed banana plugs, threaded stud.

Materials

- Body: Polyamide.
- Nut: Nickel plated
- Pin: Gold plated Nickel brass.
- Pin hex nuts: Gold Plated brass

Ordering Information

Model: 72912-Color sold in packages of 10 pieces.
Available colors: Black (-0), Red (-2)

Specifications

Max Current	36A
Max Voltage	1000 V CAT III

M4 x 0.7 nut: Screwing torque nuts 30Ncm Max.

USA: Sales: 800-490-2361 Technical Support: 800-241-2060 Fax: 888-403-3360

Europe: 31-(0) 40 2675 150 International: 425-446-5500

e-mail: technicalsupport@pomonatest.com

Where to Buy: www.pomonaelectronics.com

All dimensions are in inches. Tolerances (except noted): .xx = $\pm 0.02''$ (.51 mm), .xxx = $\pm 0.005''$ (.127 mm). All specifications are to the latest revisions. Specifications are subject to change without notice. Registered trademarks are the property of their respective companies.

Mouser Electronics

Authorized Distributor

Click to View Pricing, Inventory, Delivery & Lifecycle Information:

Pomona:

72912-2 72912-0