

4

3

2

1

D

D

C

C

B

B

A

A

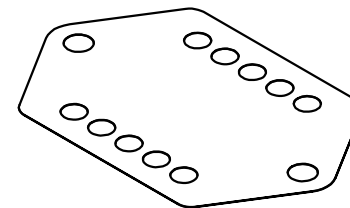
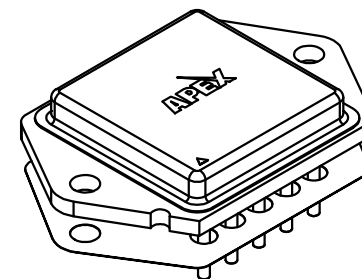
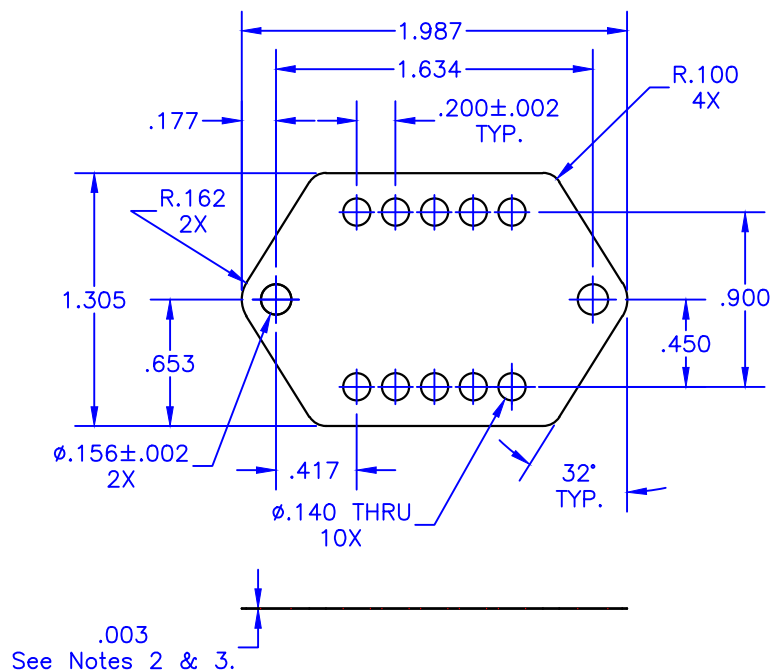

### NOTES:

1. Unless otherwise noted, all dimensions are in inches.
2. Foil Material: .002 thick 1145 aluminum
3. Interface Material: .0005 thick phase-change thermal compound, both sides.  
Maximum shipping & storage temperature - 40°C  
Reflow temperature - 60°C  
Maximum recommended service temperature - 200°C
4. Thermal impedance: .030 °C/W-in<sup>2</sup> (.194 °C/W-cm<sup>2</sup>) @ 20psi
5. Used with 10-pin Power DIP package (Apex designator: DE).

TOLERANCES - UNLESS OTHERWISE SPECIFIED  
 .XX = ±.01 [.254]  
 .XXX = ±.005 [.127]  
 ANG. = ±5°



TITLE: THERMAL WASHER, P-DIP  
 SUBJECT: MECHANICAL DRAWING  
 ENGINEER: K.GOPP  
 DRAWN BY: J.FAY  
 DCA: 16270  
 SH: 1 OF 1

MODEL: TW10  
 FILENAME: TW10  
 REV: I  
 DATE: 11JUL16

4

3

2

1

# Mouser Electronics

Authorized Distributor

Click to View Pricing, Inventory, Delivery & Lifecycle Information:

[Apex Microtechnology:](#)

[TW10](#)