

4

3

2

1

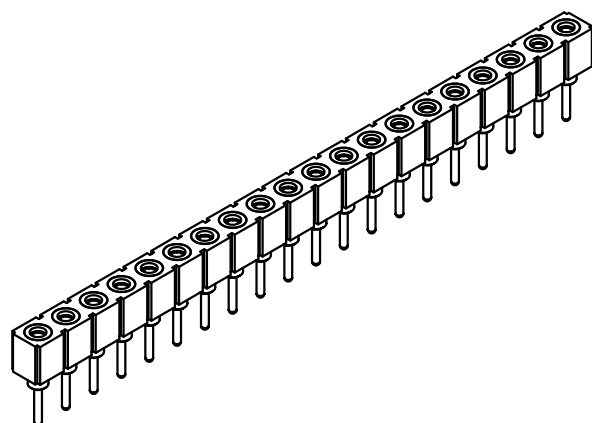
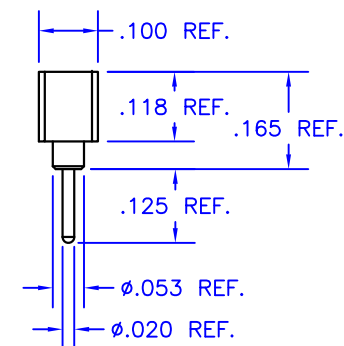
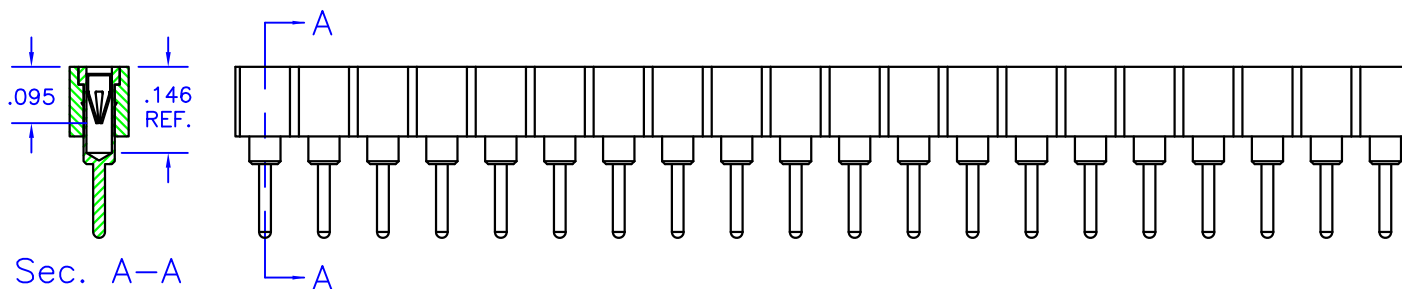
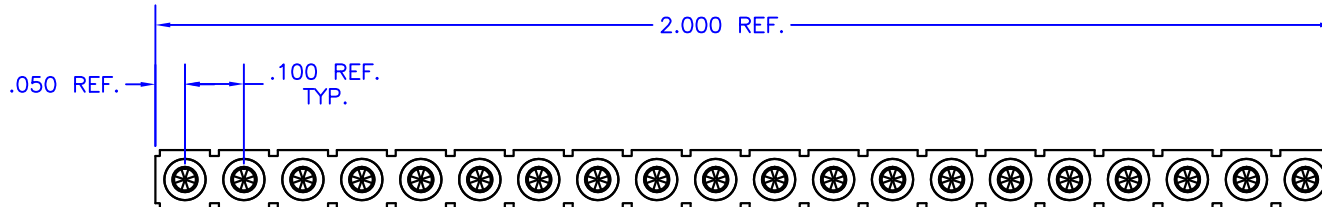

NOTES:

1. Unless otherwise noted, dimensions are in inches.
2. Shell: 360 brass, half-hard, with 200 μ in tin/lead over nickel
3. Contacts: Beryllium copper with 30 μ in gold over nickel
4. Body: Glass-filled black polyester, rated UL94V-0
5. Current rating: 3 amps, for 10°C temperature rise.
6. Solder mount in .028-.035 diameter hole.
7. Cut to length to suit application.
8. Mill-Max Part No. 310-93-120-41-001000

TOLERANCES - UNLESS
OTHERWISE SPECIFIED

.XX = $\pm .05$ [.002]
.XXX = $\pm .005$ [.0002]
ANG. = $\pm 2^\circ$



TITLE:

**MATING SOCKET
FOR .015-.025 DIAMETER PINS**

MODEL:

MS06

SUBJECT:

MECHANICAL DRAWING

ENGINEER:
D-MDRAWN BY:
R.MORDCAL: **13242**SPL: **1** OF **1**FILENAME: **MS06**REV: **D**DATE: **03JUN13**

4

3

2

1

Mouser Electronics

Authorized Distributor

Click to View Pricing, Inventory, Delivery & Lifecycle Information:

[Apex Microtechnology:](#)

[MS06](#)