



Part Number: D4C3783

Electrical Specifications

| | |
|------------------------|------------------------|
| Frequency Range (GHz): | 3.7 – 8.3 |
| Isolation (dB): | 17 MIN (per junction) |
| Insertion Loss (dB): | 0.6 MAX (per junction) |
| VSWR: | 1.35:1 MIN |
| Forward Power (W): | 20 AVG |
| | 30 PK |

Mechanical/Environmental Specifications

| | |
|-------------------|----------------------------|
| Connector Type: | SMA |
| Connector Body: | Passivated stainless steel |
| Connector Pin: | Gold plated copper |
| Load Body: | Brass |
| Magnetic Shunt: | Nickel plated CRS |
| Operational Temp: | 0°C to +50°C |
| Weight (oz) | 4.0 MAX |

D4C3783 Dimensions

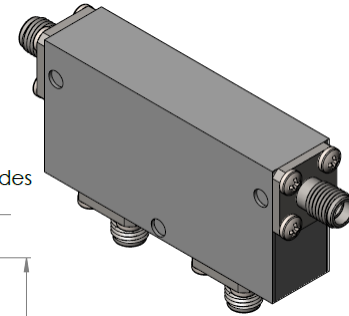
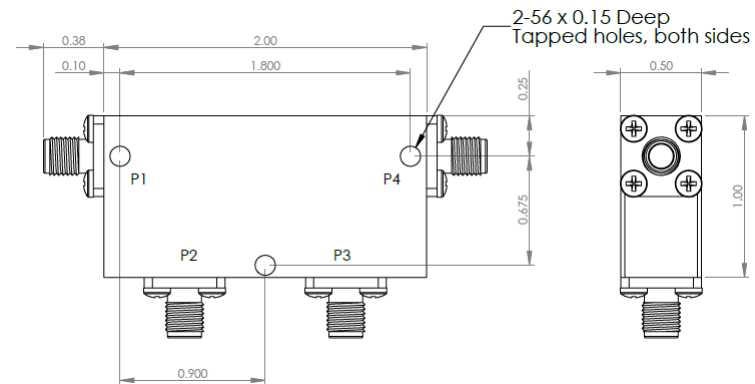

D4C3783-3 Dimensions

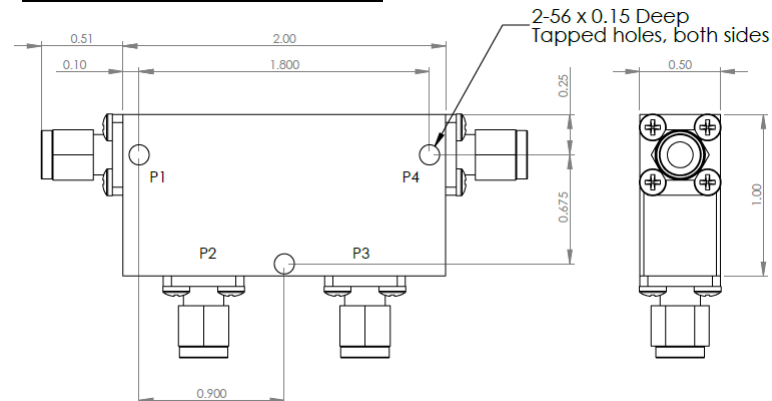

Dimensions are in inches
Tolerance
XX ±0.03
XXX ±0.010

| Type of Device | PN Suffix | Connector Configuration Input / Output | PN Example |
|--|-----------|---|------------|
| Dual Junction Circulator 4-Port Device Port 1 / Port 2 / Port 3 / Port 4 | No Dash | Female / Female / Female / Female | D4C3783 |
| | -1 | Male / Female / Female / Female | D4C3783-1 |
| | -2 | Female / Male / Female / Female | D4C3783-2 |
| | -3 | Male / Male / Male / Male | D4C3783-3 |
| | -4 | Female / Female / Male / Female | D4C3783-4 |
| | -5 | Female / Female / Female / Male | D4C3783-5 |



MEASURED DATA

Part Number: D4C3783, P4→P1, P2 & P3 Terminated with 50Ω, +25°C

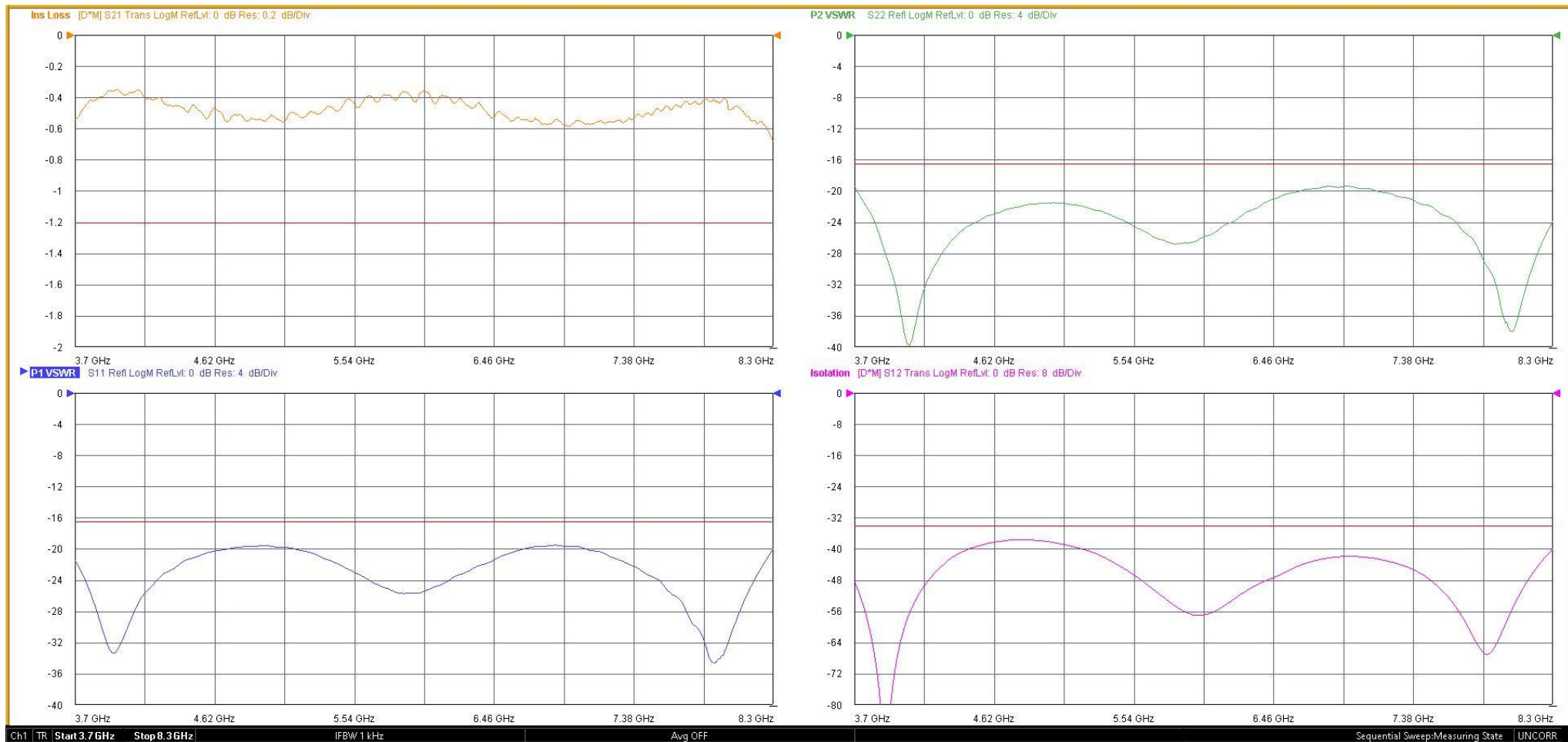

Mouser Electronics

Authorized Distributor

Click to View Pricing, Inventory, Delivery & Lifecycle Information:

[DiTom:](#)

[D4C3783](#) [D4C3783-1](#) [D4C3783-2](#) [D4C3783-3](#) [D4C3783-4](#) [D4C3783-5](#)