



## Part Number: D3I3442

### Electrical Specifications

Frequency Range (GHz):	3.4 – 4.2
Isolation (dB):	20 MIN
Insertion Loss (dB):	0.4 MAX
VSWR:	1.25:1 MIN
Forward Power (W):	20 AVG 30 PK
Reflective Power (W):	2 AVG

### Mechanical/Environmental Specifications

Connector Type:	SMA
Connector Body:	Passivated stainless steel
Connector Pin:	Gold plated copper
Load Body:	Brass
Magnetic Shunt:	Nickel plated CRS
Operational Temp:	0°C to +50°C
Weight (oz)	2.0 MAX

### D3I3442 Dimensions

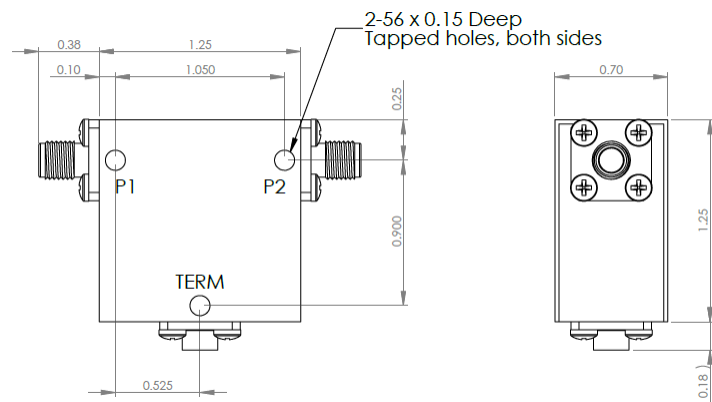

### D3I3442-3 Dimensions

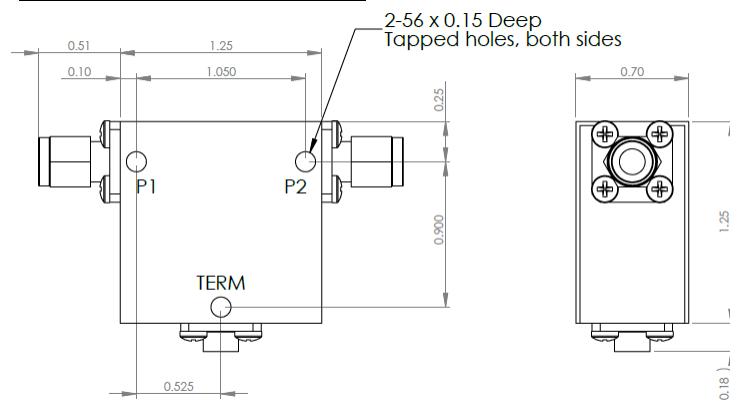

Dimensions are in inches  
Tolerance

XX ±0.03  
XXX ±0.010

Type of Device	PN Suffix	Connector Configuration Input / Output	PN Example
Single and Dual Junction Isolator, 2-Port Device  Input / Output	N/A	Female / Female	D3I3442
	-1	Male / Female	D3I3442-1
	-2	Female / Male	D3I3442-2
	-3	Male / Male	D3I3442-3



## MEASURED DATA

Part Number: D3I3442, +25°C

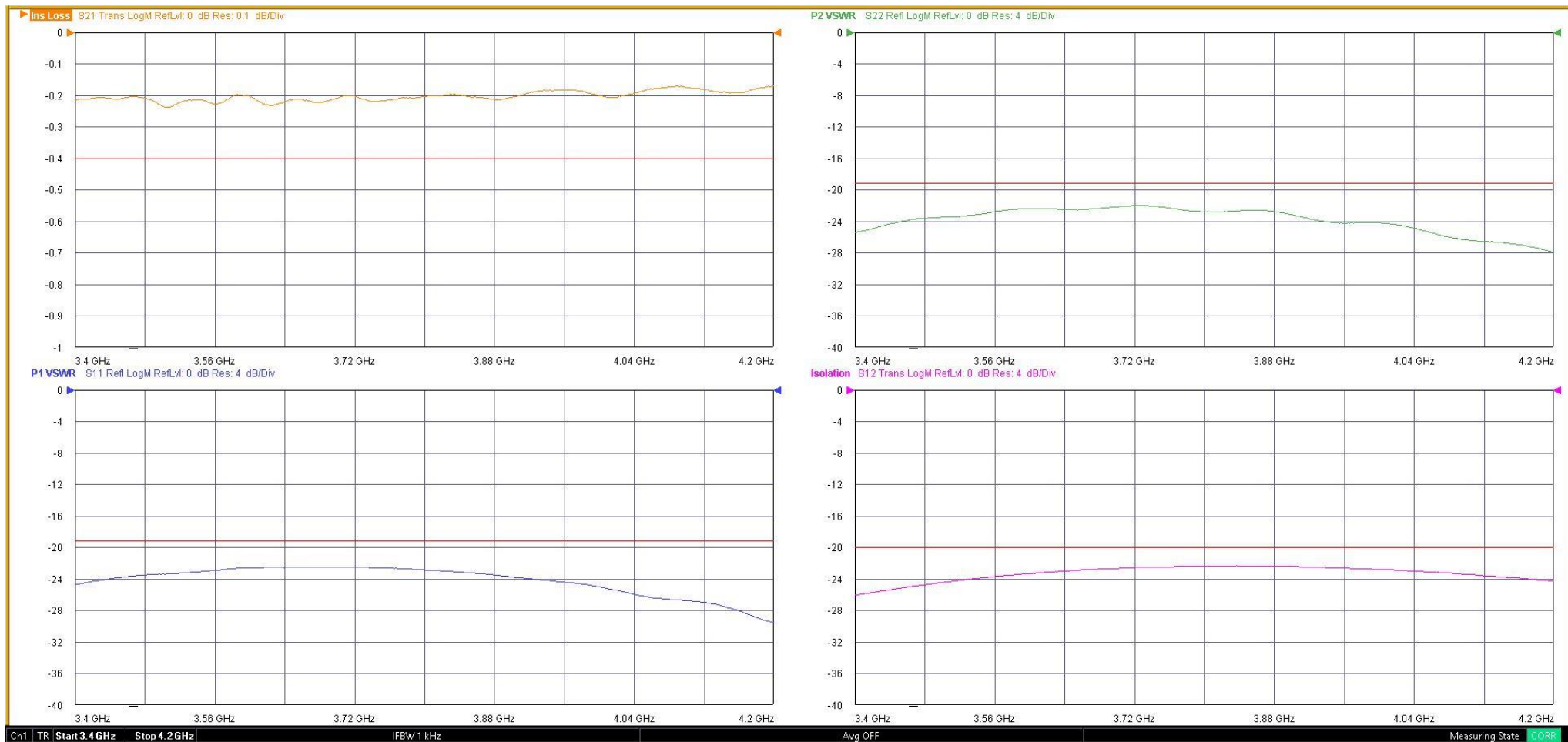

# Mouser Electronics

Authorized Distributor

Click to View Pricing, Inventory, Delivery & Lifecycle Information:

[DiTom:](#)

[D3I3442](#) [D3I3442-1](#) [D3I3442-2](#) [D3I3442-3](#)