



## Part Number: D3C3570

### Electrical Specifications

|                        |                 |
|------------------------|-----------------|
| Frequency Range (GHz): | 3.5 – 7.0       |
| Isolation (dB):        | 17 MIN          |
| Insertion Loss (dB):   | 0.5 MAX         |
| VSWR:                  | 1.35:1 MIN      |
| Forward Power (W):     | 20 AVG<br>30 PK |

### Mechanical/Environmental Specifications

|                   |                            |
|-------------------|----------------------------|
| Connector Type:   | SMA                        |
| Connector Body:   | Passivated stainless steel |
| Connector Pin:    | Gold plated copper         |
| Load Body:        | Brass                      |
| Magnetic Shunt:   | Nickel plated CRS          |
| Operational Temp: | 0°C to +50°C               |
| Weight (oz)       | 2.0 MAX                    |

#### D3C3570 Dimensions

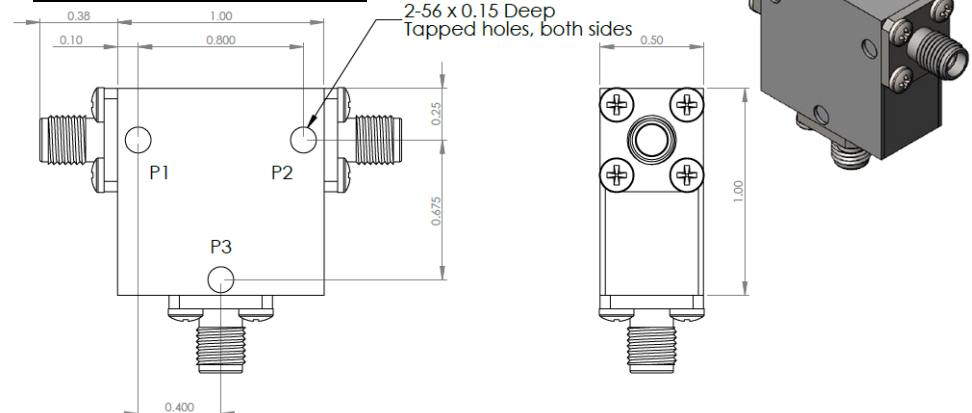

#### D3C3570-3 Dimensions

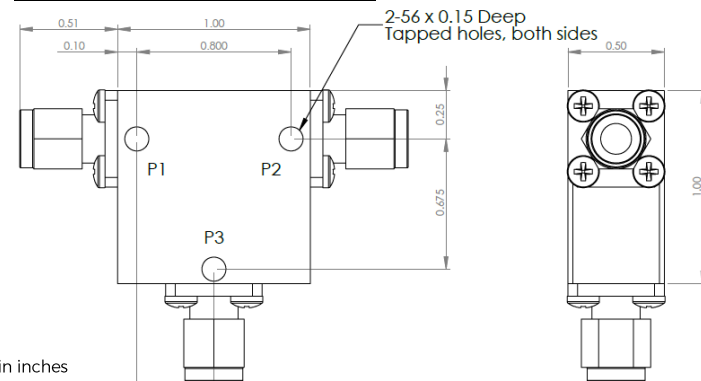

Dimensions are in inches  
Tolerance

XX ±0.03  
XXX ±0.010

| Type of Device  | PN Suffix | Connector Configuration<br>Input / Output | PN Example |
|---|-----------|---|------------|
| Single Junction Circulator<br>3-Port Device<br><br>Port 1 / Port 2 / Port 3 | No Dash   | Female / Female / Female                  | D3C3570    |
|   | -1        | Male / Female / Female                    | D3C3570-1  |
|   | -2        | Female / Male / Female                    | D3C3570-2  |
|   | -3        | Male / Male / Male                        | D3C3570-3  |
|   | -4        | Female / Female / Male                    | D3C3570-4  |
|   | -5        | Male / Female / Male                      | D3C3570-5  |
|   | -6        | Male / Male / Female                      | D3C3570-6  |
|   | -7        | Female / Male / Male                      | D3C3570-7  |



## MEASURED DATA

Part Number: D3C3570, P1→P2, P3 Terminated with 50Ω, +25°C

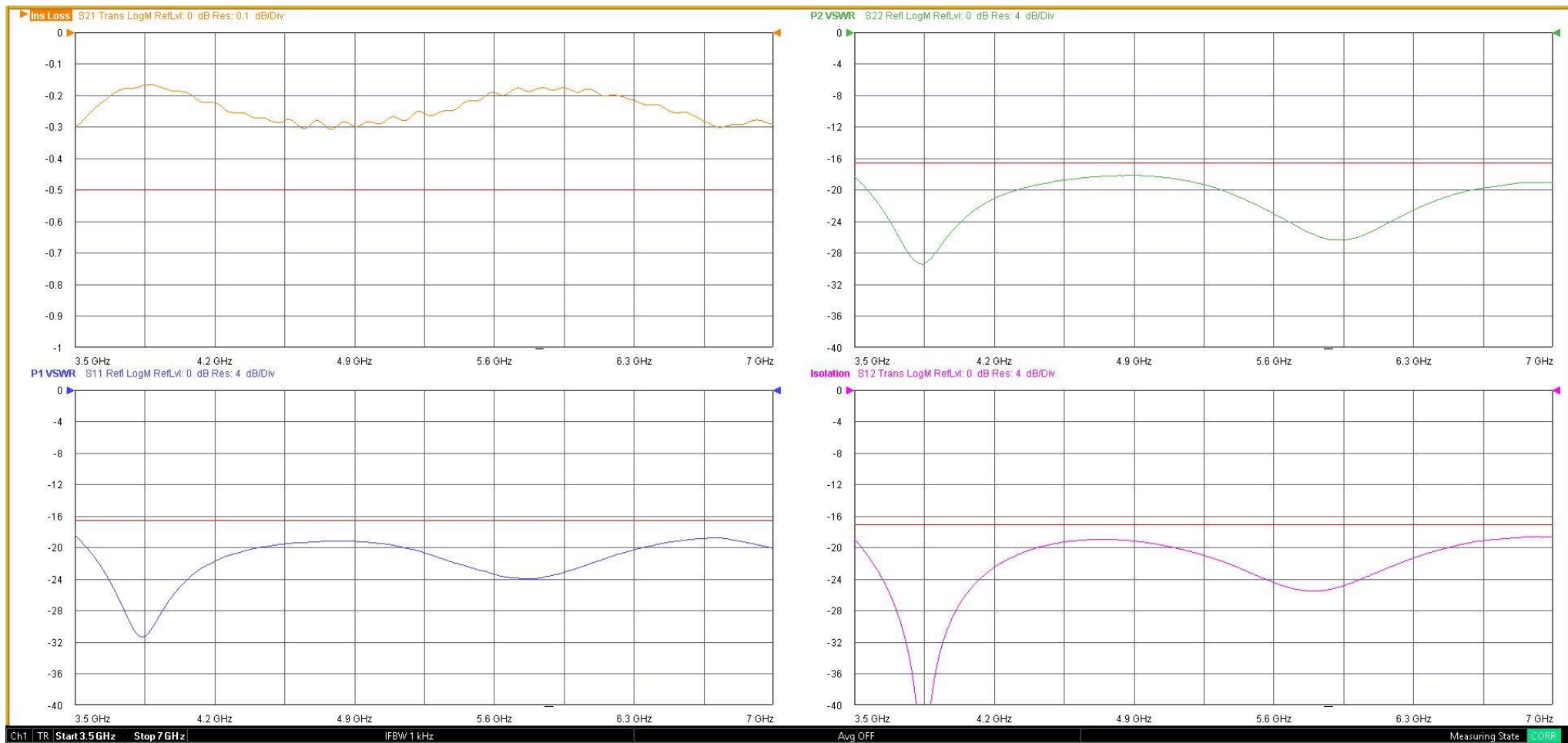

# Mouser Electronics

Authorized Distributor

Click to View Pricing, Inventory, Delivery & Lifecycle Information:

[DiTom:](#)

[D3C3570](#) [D3C3570-1](#) [D3C3570-2](#) [D3C3570-3](#) [D3C3570-4](#) [D3C3570-5](#) [D3C3570-6](#) [D3C3570-7](#)