



## Part Number: D3C1720S

### Electrical Specifications

Frequency Range (GHz):	1.7 – 2.0
Isolation (dB):	20 MIN
Insertion Loss (dB):	0.4 MAX
VSWR:	1.25:1 MIN
Forward Power (W):	150 AVG 500 PK

### Mechanical/Environmental Specifications

Connector Type:	SMA
Connector Body:	Passivated stainless steel
Connector Pin:	Gold plated copper
Load Body:	Brass
Magnetic Shunt:	Nickel plated CRS
Operational Temp:	-20°C to +65°C
Weight (oz)	3.0 MAX

### D3C1720S Dimensions

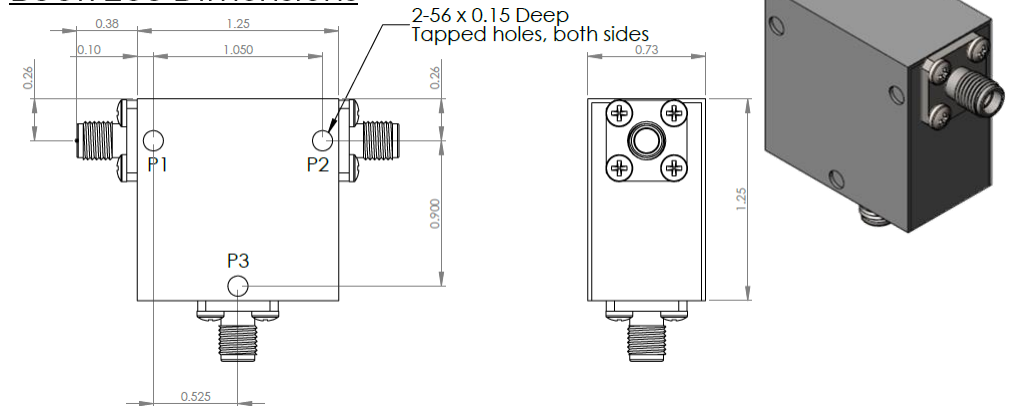

### D3C1720S-3 Dimensions

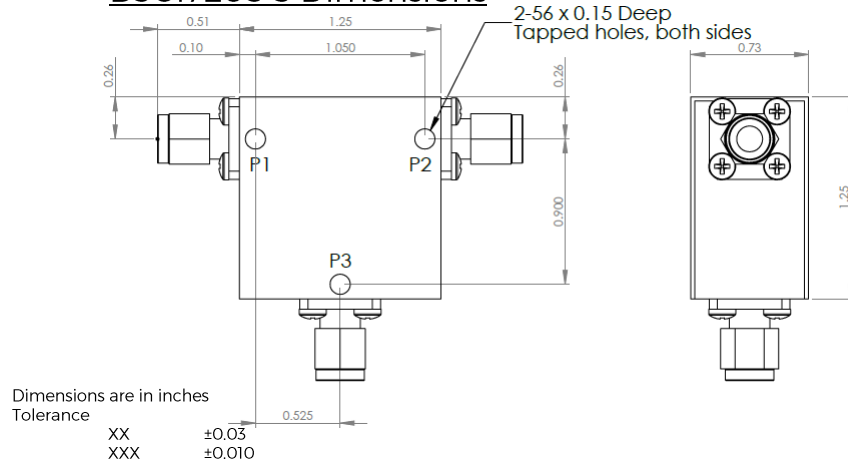

Type of Device	PN Suffix	Connector Configuration Input / Output	PN Example
Single Junction Circulator 3-Port Device  Port 1 / Port 2 / Port 3	No Dash	Female / Female / Female	D3C1720S
	-1	Male / Female / Female	D3C1720S-1
	-2	Female / Male / Female	D3C1720S-2
	-3	Male / Male / Male	D3C1720S-3
	-4	Female / Female / Male	D3C1720S-4
	-5	Male / Female / Male	D3C1720S-5
	-6	Male / Male / Female	D3C1720S-6
	-7	Female / Male / Male	D3C1720S-7



## MEASURED DATA

Part Number: D3C1720S, P1→P2, P3 Terminated with 50Ω, +25°C

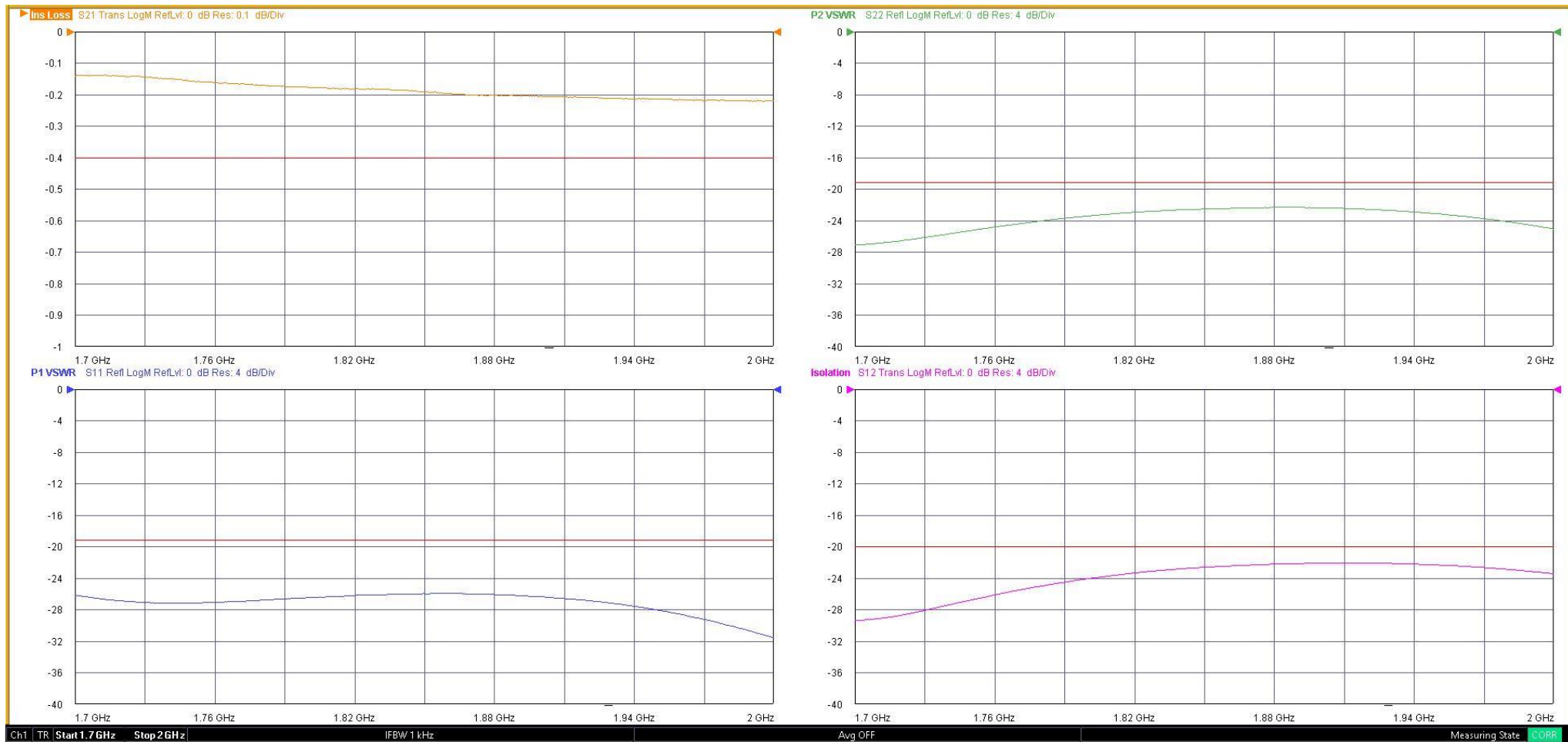

# Mouser Electronics

Authorized Distributor

Click to View Pricing, Inventory, Delivery & Lifecycle Information:

[DiTom:](#)

[D3C1720S](#) [D3C1720S-1](#) [D3C1720S-2](#) [D3C1720S-3](#) [D3C1720S-4](#) [D3C1720S-5](#) [D3C1720S-6](#) [D3C1720S-7](#)