

# Brushed DC Motor

## M25N-1 (Ø 24.4 x 30.8mm)

**MITSUMI**

### Features

Carbon Brush  
Weight: 46.8g

### Applications

Printer



### Specifications

MODEL	Voltage		No Load		Rated Load		Rated Load		Starting Torque		Starting Current	Shaft Length
	Operating	Rated	Speed	Current			Speed	Current				
	V	V	min-1	mA			min-1	mA				
M25N-1	12 to 24	12	5500	35	31.6	3.10	4500	193	164	16.1	938	*

*Characteristics and shaft length can be customized*

### External Dimensions

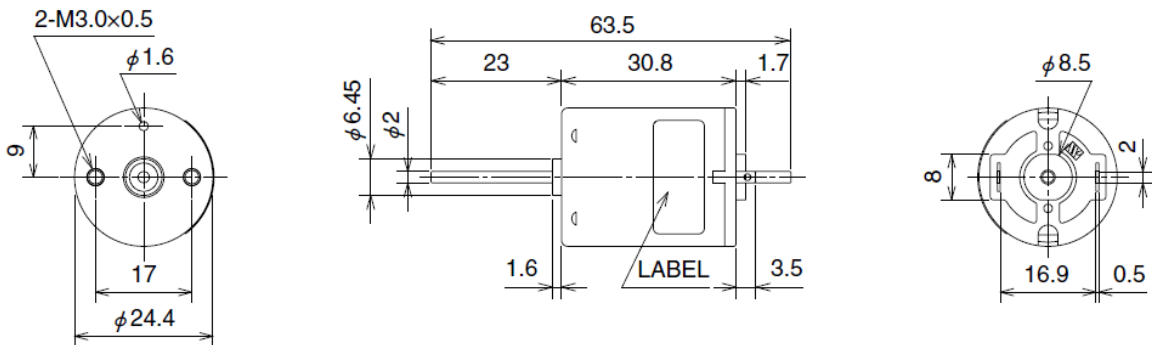

Unit:mm

### Characteristic Curve

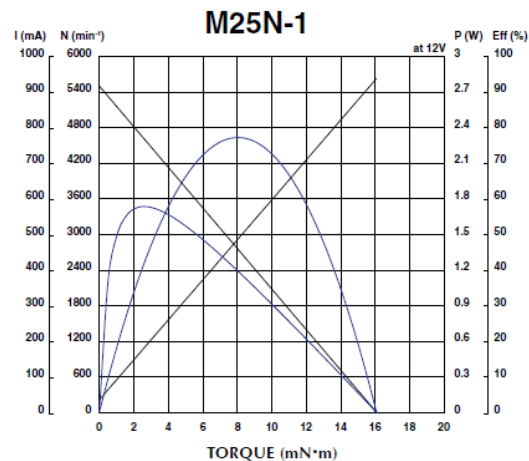

# Mouser Electronics

Authorized Distributor

Click to View Pricing, Inventory, Delivery & Lifecycle Information:

[NMB Technologies:](#)

[M25N-1](#)