

Universal AC Current Monitor

SPECIFICATIONS

| | | | |
|--------------------|----------------------------------|-------------------------------|--|
| CONTROL VOLTAGE | 24 or 120 VAC; 50/60 Hz, 24 VDC | | |
| OUTPUT | DPDT, 10 Amp @ 120 VAC Resistive | | |
| RESPONSE TIME | Operate | 0.1 to 10 SEC Adjustable | |
| | Release | 0.3 to 30 SEC Adjustable | |
| INDICATORS | Glows when relay is energized | | |
| RESET | Automatic | | |
| HYSTERESIS | 5% | | |
| TEMPERATURE RATING | Operate | 32° to 131°F (0° to +55°C) | |
| | Storage | -49° to 185°F (-45° to +85°C) | |
| SOCKETS | RB-08 or PF083A | | |
| ENCLOSURE | Lexan Dust Cover; 8-Pin plug-in | | |
| WEIGHT | 13 oz | | |

MODEL NUMBER

| | | | | | | |
|--------------------------------|-----------|-----------------------------------------------|---|---|---|-----|
| MODEL NUMBER | CMD | | | S | E | |
| CONTROL VOLTAGE | 24 Volts | 24 | | | | |
| | 120 Volts | 120 | | | | |
| TYPE OF CONTROL VOLTAGE | | | A | | | |
| | | | D | | | |
| CURRENT TRIP POINTS | | 0.05 to 0.25 amp adj. max continuous 3.4 amps | | | | .25 |
| | | 0.2 to 1 amp adj. max continuous 11.9 amps | | | | 1 |
| | | 1.0 to 5.0 amps adj. max continuous 13.4 amps | | | | 5 |
| | | 2.0 to 10 amps adj. max continuous 25 amps | | | | 10 |
| | | 4.0 to 20 amps adj. max continuous 25 amps | | | | 20 |

OPERATION

The **CMD Series** may be used as an **OVER CURRENT** Monitor or an **UNDER CURRENT** Monitor.

The CMD has adjustable Delay-on-Operate and adjustable Delay-on-Release time delays. When the current exceeds the preset current trip point for longer than the Delay-on-Operate time delay, the internal relay will energize (Pick-up). When the current drops below the preset current trip point for longer than the Delay-on-Release time delay, the internal relay will de-energize (Drop-out). When used as an over current monitor the Delay-on-Operate time delay is used to override inrush periods. When used as an under current monitor, the Delay-on-Release timer is used to override a temporary under current condition.

An External CT may be used to extend the range of the Current Monitor.

CMD

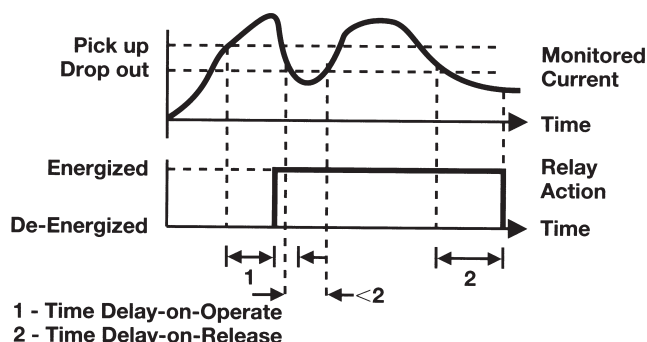

DIMENSIONS (INCHES)

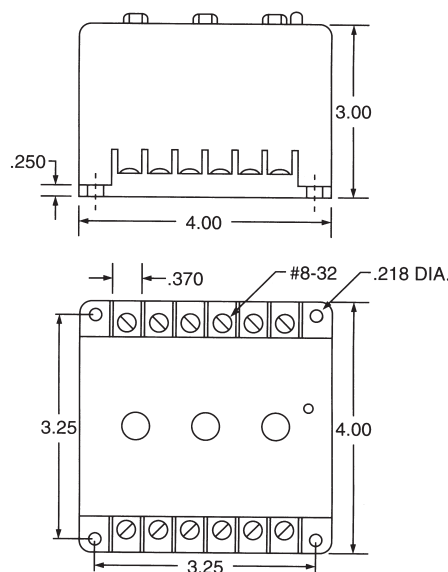

WIRING

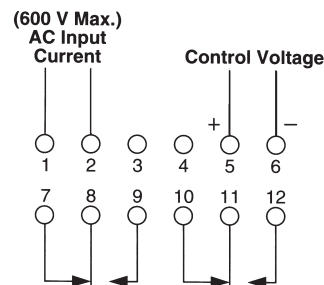

Mouser Electronics

Authorized Distributor

Click to View Pricing, Inventory, Delivery & Lifecycle Information:

[ATC Diversified Electronics:](#)

[CMD-24-ASE-1](#) [CMD-24-ASE-10](#) [CMD-24-ASE-20](#) [CMD-120-ASE-5](#) [CMD-120-ASE-10](#) [CMD-24-ASE-5](#) [CMD-120-ASE-20](#) [CMD-120-ASE-1](#) [CMD-120-ASE-.25](#) [CMD-24-ASE-.25](#)