

MODEL NO.	"L"	P/N
BMT116.4S-HT	5000 [197]	26652
BMT110S-HT	3048 [120]	14267
BMT123S-HT	7000 [276]	75486
BMT13.33S-HT	1016 [40]	72536
BMT16.6S-HT	2000 [79]	64397
BMY149.2S-HT	15000 [591]	808186
BMT132.83S-HT	10008 [394]	808161

NOTE - THIS ASSEMBLY CONSTRUCTED WITH EPOXY WHICH HAS A
MAXIMUM OPERATING TEMPERATURE OF 315°C [600°F]

FIBER BUNDLES "A" AND "B"
TO BE OPTICALLY ISOLATED
AT END TIP.

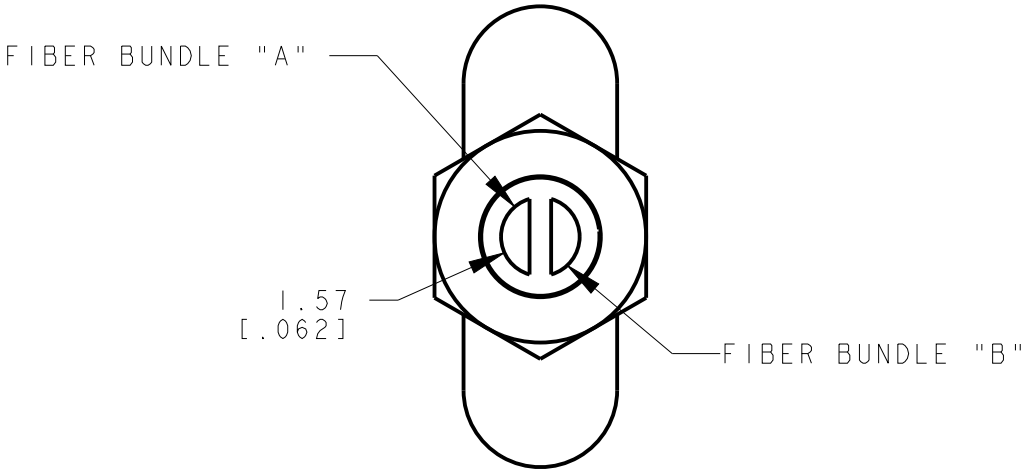

DETAIL A
SCALE 4:1

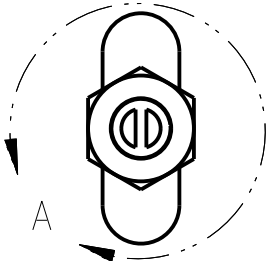
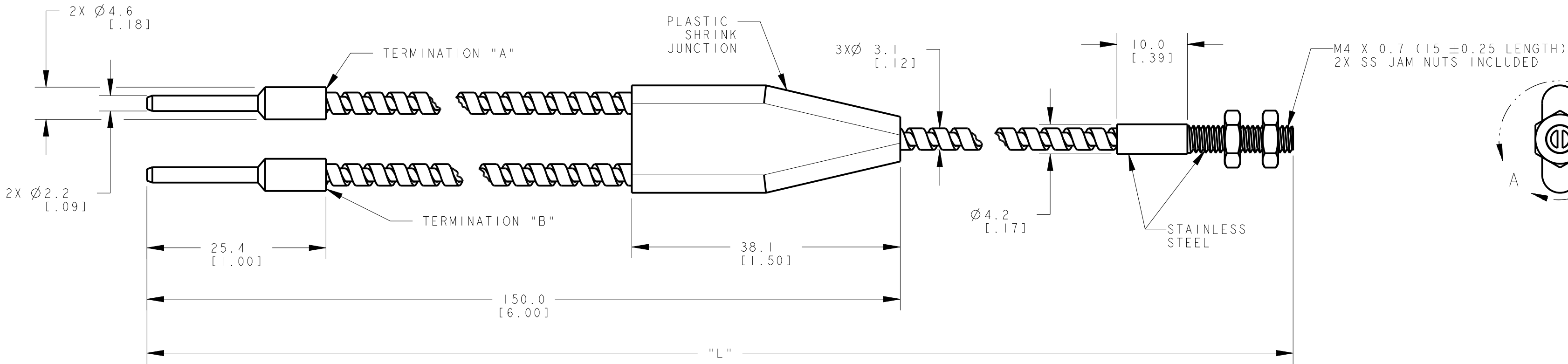

NOTES:
1. ALL DIMENSIONS ARE MILLIMETERS [INCHES] UNLESS OTHERWISE NOTED.
2. REFER TO "www.bannerengineering.com" FOR ADDITIONAL DATA AND SPECIFICATIONS.

This drawing is the property
of BANNER ENGINEERING CORP.
Any use or reproduction,
in any form, without prior
written permission of
Banner is prohibited.
© 2015 Banner Engineering Corp.

THIRD ANGLE PROJECTION

BANNER BANNER ENGINEERING CORP.
www.bannerengineering.com

TITLE
BMT1 STAINLESS STEEL HIGH TEMP SERIES

SIZE C	DRAWING NO. 193330	REV. A
SCALE 2:1		SHEET 1 OF 1

CREO

Mouser Electronics

Authorized Distributor

Click to View Pricing, Inventory, Delivery & Lifecycle Information:

[Banner Engineering:](#)

[BMT110S-HT](#) [BMT16.6S-HT](#) [BMT13.33S-HT](#) [BMT123S-HT](#)