

SPECIFICATIONS

ELECTRICAL

RESISTANCE VALUES _____ 1K,2K,5K,10K,20K,50K,100K
RESISTANCE TOLERANCE _____ $\pm 10\%$
LINEARITY(INDEPENDENT) _____ $\pm 1\%$
ELECTRICAL ANGLE _____ $320^\circ \pm 5^\circ$
END RESISTANCE _____ $0.2\% \text{ MAX.}$
RESOLUTION _____ ESSENTIALLY INFINITE
INSULATION RESISTANCE _____ 1000MEG OHMS @1000 VDC
DIELECTRIC STRENGTH _____ 1000 VAC
POWER RATING _____ 1 WATT
CONTACT RESIS. VARIATION _____ BELOW $2\% \text{ C.R.V.}$
OUTPUT SMOOTHNESS _____ LESS THAN 0.1%

MECHANICAL

NO OF TURNS _____ 1
MECHANICAL ROTATION _____ $320 + 10^\circ - 0^\circ$
ROTATIONAL LIFE _____ 20,000,000 TURNS
STOP STRENGTH _____ N/A
TORQUE _____ BELOW 0.3 OZ.IN.
WEIGHT _____ 1 OZ.

ENVIRONMENTAL

OPERATING TEMPERATURE _____ $-55^\circ\text{C TO} +125^\circ\text{C}$
TEMPERATURE COEFFICIENT _____ $\pm 400 \text{ PPM}/^\circ\text{C}$
VIBRATION _____ 10HZ TO 2000HZ 15G
SHOCK _____ 50G
MOISTURE RESISTANCE _____ $40^\circ\text{C } 95\% \text{RH } 120 \text{ HOURS}$

MATERIALS

HOUSING _____ ANODIZED ALUMINUM ,BLACK
SHAFT _____ STAINLESS STEEL
TERMINALS _____ GOLD PLATED BRASS
RESISTANCE ELEMENT _____ CONDUCTIVE PLASTIC

OPTIONAL FEATURES

SHAFT MODIFICATIONS
REAR SHAFT
CENTER TAP
O'RING SHAFT SEAL
BUSHING MOUNT
SPECIAL ANGLES
MULTIPLE SECTIONS

REV.	BY	DATE	PART NO.	SP22B
B	BT	11-6 95	ADDED MECHANICAL STOPS	

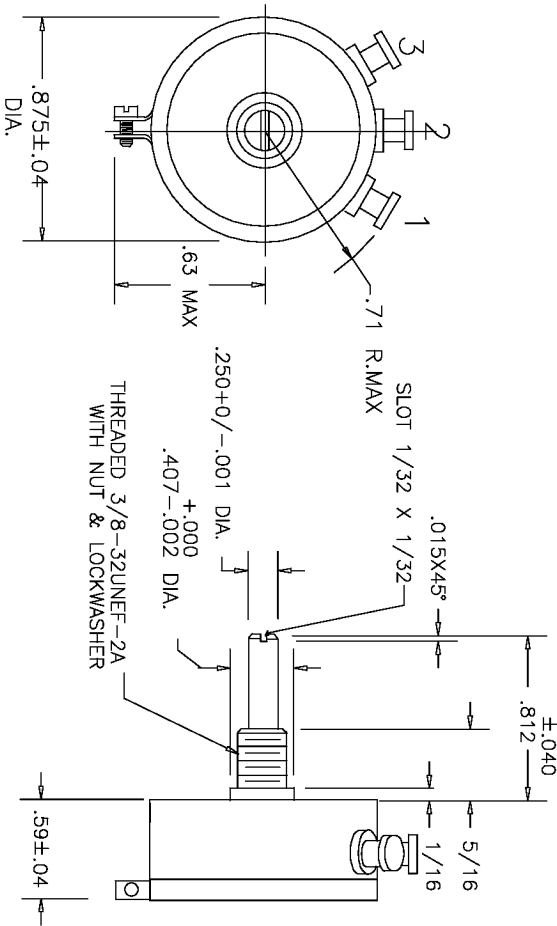

SCHEMATIC

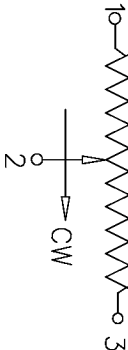

THIS DOCUMENT CONTAINS PROPRIETARY DATA OF POLARIS INDUSTRIAL ENTERPRISES, INC. NO DISCLOSURE, REPRODUCTION, OR USE OF ANY PART THERE OF MAY BE MADE EXCEPT BY WRITTEN PERMISSION.

TITLE

SINGLE TURN
POTENTIOMETER

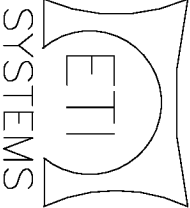

CARLSBAD
CALIFORNIA

PART NO.

SP22B

TOLERANCES

XX = .010 FRACTIONS = $?/64$
XXX = $\pm .005$ ANGLES = $\pm 1/2^\circ$

ALL SPECIFICATIONS SUBJECT TO CHANGE WITHOUT NOTICE.

Mouser Electronics

Authorized Distributor

Click to View Pricing, Inventory, Delivery & Lifecycle Information:

[ETI Systems:](#)

[SP22B-NS-1K](#) [SP22B-3349-1K](#)