

THIS DOCUMENT CONTAINS PROPRIETARY DATA OF POLARIS INDUSTRIAL ENTERPRISES, INC. NO DISCLOSURE, REPRODUCTION, OR USE OF ANY PART THERE OF MAY BE MADE EXCEPT BY WRITTEN PERMISSION.

REV.	BY	DATE	APPRVL.	P/N
B	BT	2-24-99		MW22B-1 WAS ±0.25%

ELECTRICAL SPECIFICATIONS

RESISTANCE RANGE _____ 100 TO 100,000 OHMS
RESISTANCE TOLERANCE _____ ± 5%
INDEPENDENT LINEARITY _____ SEE CHART
POWER RATING _____ SEE CHART
ELECTRICAL NOISE _____ 100 OHMS MAX.
ELECTRICAL ANGLE _____ SEE CHART
END RESISTANCE _____ 1 OHM OR 1% MAX.
RESOLUTION _____ SEE CHART
INSULATION RESISTANCE _____ 1000 MEGOHMS MIN. @ 500VDC
DIELECTRIC STRENGTH _____ 1000 VAC MIN.

MECHANICAL

MECHANICAL ANGLE _____ SEE CHART
STOP STRENGTH _____ 48 OZ./IN.
STARTING TORQUE _____ 1.4 OZ. IN. MAX.
ROTATIONAL LIFE _____ 1,000,000 REVOLUTIONS
WEIGHT _____ 0.8 OZ.

ENVIRONMENTAL

OPERATING TEMPERATURE _____ -55° TO +105°C
TEMPERATURE COEFFICIENT _____ SEE CHART
VIBRATION _____ 10Hz TO 2,000Hz 15G
MOISTURE RESISTANCE _____ 40°C95%RH 120 HOURS
SHOCK _____ 50G 11ms

MATERIALS

HOUSING----- HIGH TEMP. THERMO PLASTIC
TERMINALS----- GOLD PLATED BRASS
BUSHING----- BRASS
SHAFT ----- STAINLESS STEEL
RESISTIVE ELEMENT----- WIREWOUND

NON-STANDARDS AVAILABLE

MULTI-GANGED UP TO 6 SECTIONS
REAR SHAFT EXTENSION
FRONT SHAFT MODIFICATIONS

RESOLUTION CHART

	50	100	200	500	1K	2K	5K	10K	20K	50K	100K
RESISTANCE (OHMS)											
MW22B-1 TURN	0.60	0.50	0.40	0.30	0.25	0.20	0.20	0.16			
MW22B-3 TURN	.15	.12	.090	0.070	.056	.058	.045	.036	.030	.027	
MW22B-5 TURN	.10	.08	.064	.050	.040	.042	.032	.026	.021	.019	
MW22B-10 TURN	.06	.05	.040	.030	.025	.020	.020	.016	.013	.010	.009
TEMPERATURE COEFFICIENT PPM/°C	80					20					

MODEL	ELECTRICAL ANGLE	MECHANICAL ANGLE	LINEARITY INDEPENDENT	POWER RATING
MW22B-1	360°±5°	360°+10°/-0°	±0.5%	0.5WATT
MW22B-3	1080°±5°	1080°+10°/-0°	±0.5%	1 WATT
MW22B-5	1800°±5°	1800°+10°/-0°	±0.3%	1 WATT
MW22B-10	3600°±5°	3600°+10°/-0°	±0.25%	2 WATT

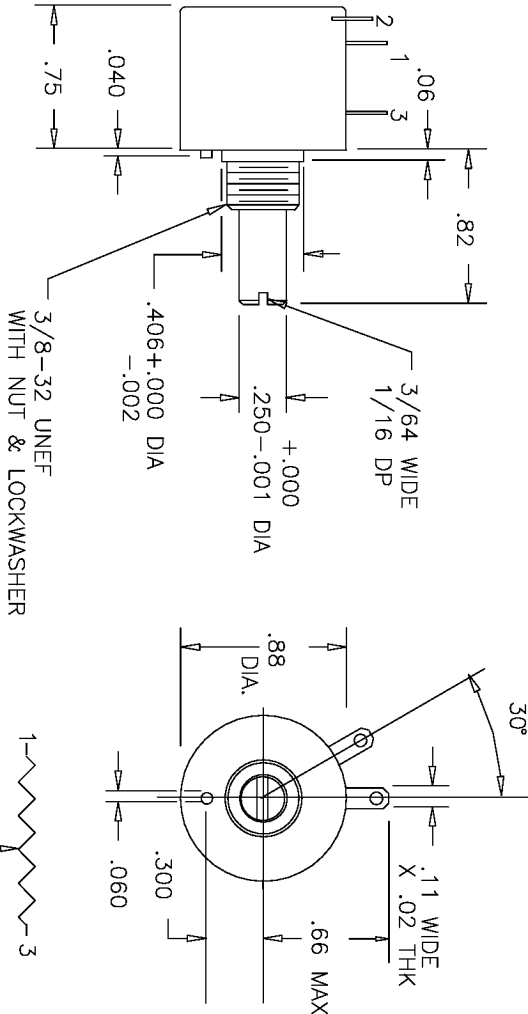

TOLERANCES
XX = +/- .010" FRACT. = +/- 1/64"
XXX = +/- .005" ANGLES = +/- 1/2°
ALL SPECIFICATIONS SUBJECT TO CHANGE WITHOUT NOTICE.

SCALE	DATE: 4-18-85
NONE	BY BT
APPRVD	
CODE IDENT: 19477	

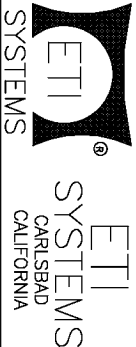

TITLE
MULTI-TURN
POTENTIOMETER

PART NO.
MW22B

Mouser Electronics

Authorized Distributor

Click to View Pricing, Inventory, Delivery & Lifecycle Information:

[ETI Systems:](#)

[MW22B-2200-2.5K](#)