

SPECIFICATIONS

ELECTRICAL

RESISTANCE RANGE ----- SEE CHART  
RESISTANCE TOLERANCE ----- ±3%  
LINEARITY TOLERANCE ----- ±0.25%  
RESOLUTION ----- SEE CHART  
END RESISTANCE AT TERM. ----- 1 OHM OR 0.1%  
ELECTRICAL ANGLE ----- 3600±5°  
ELECTRICAL NOISE ----- 100 OHM MAX.  
POWER RATING ----- 1.5 WATTS  
MAXIMUM VOLTAGE ----- 450 VOLTS  
INSULATION RESISTANCE ----- 1,000 MEGOHMS @ 500 V.D.C.  
DIELECTRIC STRENGTH ----- 1,000 V.A.C.

MECHANICAL

NUMBER OF TURNS ----- 10  
MECHANICAL ANGLE ----- 3600±15°-0°  
TORQUE ----- 0.4 OZ. IN. MAX.  
STOP STRENGTH ----- 20 OZ. IN. MAX.  
WEIGHT ----- 0.35 OZ.

ENVIRONMENTAL

OPERATING TEMPERATURE ----- -55°C to +105°C  
TEMPERATURE COEFFICIENT ----- SEE CHART  
VIBRATION ----- 10Hz TO 2000Hz 15G  
SHOCK ----- 50G 11ms  
MOISTURE RESISTANCE ----- 40°C 95%RH 120 HOURS  
ROTATIONAL LIFE ----- 1,000,000 SHAFT REVOLUTIONS

MATERIALS

HOUSING ----- HIGH TEMPERATURE PLASTIC  
SHAFT ----- STAINLESS STEEL  
BUSHING ----- BRASS  
TERMINALS ----- GOLD PLATED  
ELEMENT ----- WIREWOUND

RESISTANCE	20	50	100	200	500	1K	2K	5K	10K	20K	50K	100K
RESOLUTION	.070	.050	.059	.054	.039	.040	.033	.024	.021	.016	.012	.009
TEMPERATURE COEFFICIENT,PPM/°C	700	700	80	80	80	20	20	20	20	20	20	20

	SCALE	NONE
	DATE:	4-3-79
	BY	
TOLERANCES		
XX = +/- .010" FRACT. = +/- 1/64"		
XXX = +/- .005" ANGLES = +/- 1/2°		
ALL SPECIFICATIONS SUBJECT TO CHANGE WITHOUT NOTICE.		

REV.	BY	DATE	PART NO.
C	BT	11-21 87	MW12B-10

MECH. ANGLE WAS 3600±5°  
ADDED OPERATING TEMPERATURE

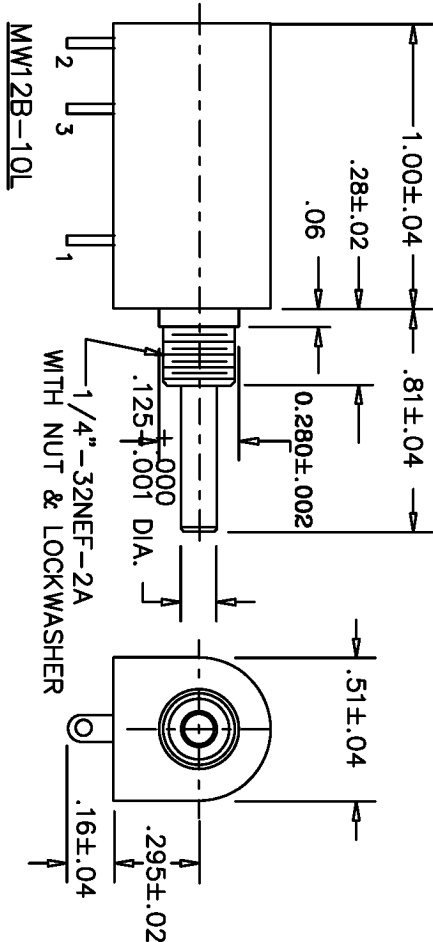

MW12B-10R

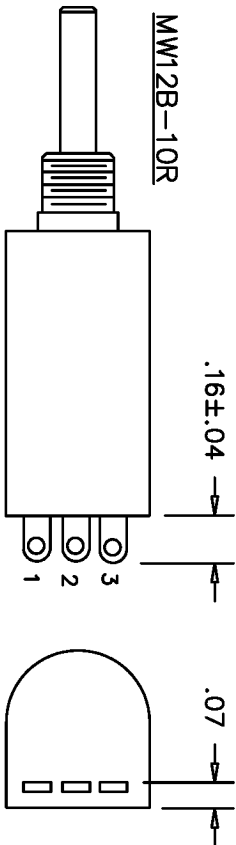

THIS DOCUMENT CONTAINS PROPRIETARY DATA OF POLARIS INDUSTRIAL ENTERPRISES, INC. NO DISCLOSURE, REPRODUCTION, OR USE OF ANY PART THERE OF MAY BE MADE EXCEPT BY WRITTEN PERMISSION.

MULTI-TURN  
POTENTIOMETER

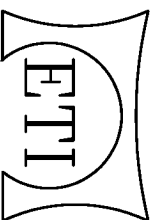

CARLSBAD  
SYSTEMS  
CALIFORNIA

PART NO.

MW12B-10

# Mouser Electronics

Authorized Distributor

Click to View Pricing, Inventory, Delivery & Lifecycle Information:

[ETI Systems:](#)

[MW12B-3R-10K](#) [MW12B-5R-10K](#)