

SPECIFICATIONS

REV.	BY	DATE	P/LN
			J90-CQ20-SMB

ELECTRICAL

RESISTANCE	10K OHMS
TOLERANCE	±15%
LINEARITY (INDEPENDENT)	±3.0%
POWER RATING	0.2 WATT
LEVER ELECTRICAL ANGLE	44°
RESOLUTION	ESSENTIALLY INFINITE
OUTPUT SMOOTHNESS	BELOW 0.2% AGAINST INPUT VOLTAGE
CONTACT RESISTANCE VARIATION	BELOW 5% C.R.V.
INSULATION RESISTANCE	1000 MEGA OHMS @ 500VDC.
DIELECTRIC STRENGTH	1 MINUTE AT 500 VAC
MAX. WIPER OUTPUT	1 mA RECOMMENDED, 5 mA MAX.

MECHANICAL

RANGE OF OPERATING LEVER	±22° ~ ±26° OMNI-DIRECTIONAL FROM CENTER.
OPERATING FORCE FOR X AND Y DIR.	APPROX. 7.2 ~ 43.2 OZ-F
OPERATING TEMPERATURE	-20°C TO +60°C
LIFE EXPECTANCY	5 MILLION OPERATIONS
WEIGHT	APPROX. 23 OZ.

MATERIALS

HOUSING	ALUMINUM
ELEMENT	CONDUCTIVE PLASTIC
KNOB	HARD PLASTIC

OPTIONS

- 1 & 3 DIMENSIONAL LEVER OPERATION.
- OTHER RESISTANCE AVAILABLE.
- LEVER SWITCHES.

"C" LEVER OPERATION

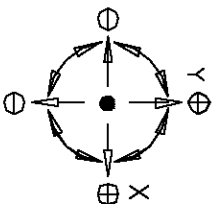

PANEL ARRANGEMENT

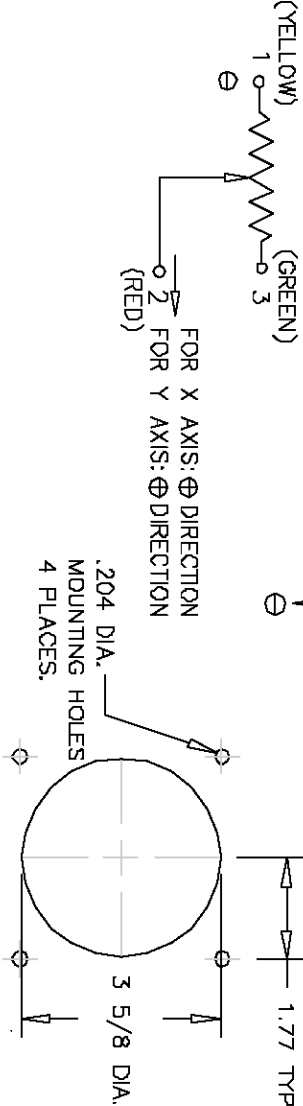

TWO DIMENSIONAL
OPERATING LEVER WITH
SPRING RETURN TO CENTER.

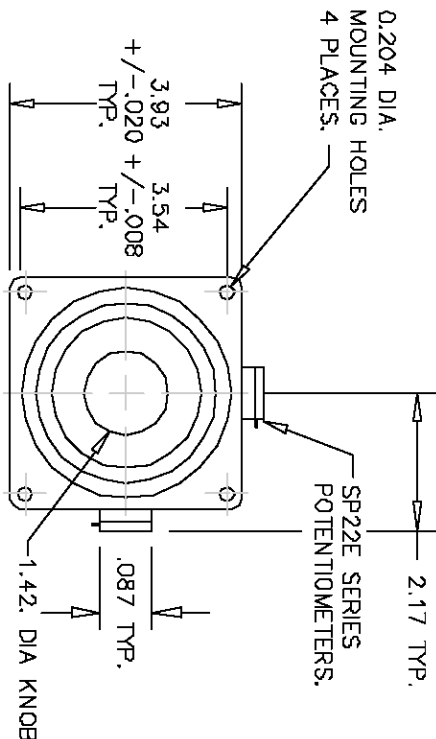
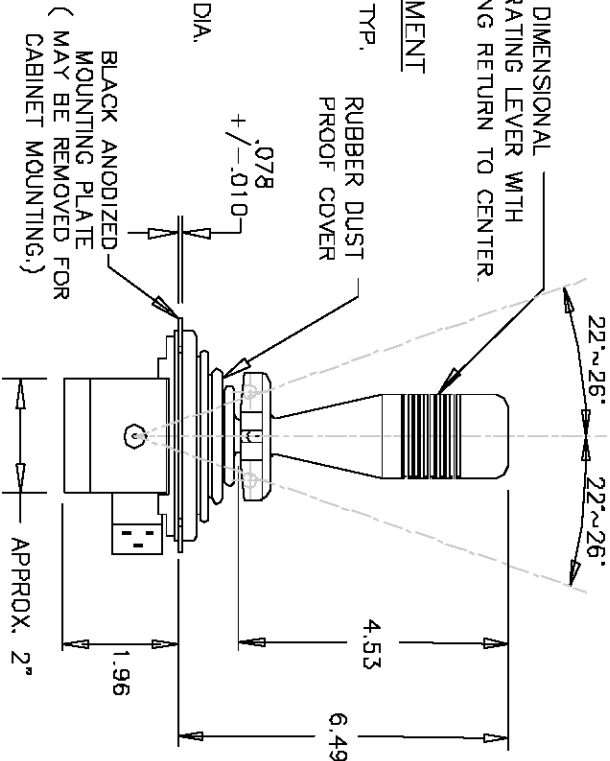

ETI
SYSTEMS
CARLSBAD
CALIFORNIA

2251 LAS PALMAS DR.
CARLSBAD, CA 92009
PHONE (760) 929-0749
FAX (760) 929-0748
WWW.ETISYSTEMS.COM

TITLE

JOYSTICK

PART NO.

J90-CQ20-SMB

Mouser Electronics

Authorized Distributor

Click to View Pricing, Inventory, Delivery & Lifecycle Information:

[ETI Systems:](#)

[J90-CQ20-SMB](#)