



Continuous light element, with integrated LED, green, 24 V AC/DC, Diameter 70 mm

product brand name	SIRIUS			
product designation	Continuous light element			
design of the product	including light sources			
General technical data				
type of voltage of the operating voltage	AC/DC			
operating voltage				
• 1 at DC rated value				24 V
• 1 at AC at 50 Hz rated value				24 V
• 1 at AC at 60 Hz rated value				24 V
relative positive tolerance of the operating voltage	10 %			
relative negative tolerance of the operating voltage	-10 %			
consumed current maximum	30 mA			
reference code according to EN 61346-2	P			
Lamp				
product component light source	Yes			
type of light source	LED			
service life of LED	100 000 h			
design of the optical signal	continuous light			
light intensity	0.88 cd			
light intensity	0.6 ... 1.36 cd			
Enclosure				
height	65.5 mm			
width	70 mm			
outer diameter of the signal column element	70 mm			
material	PC			
color	green			
fastening method	Bayonet			
protection class IP	IP65			
Ambient conditions				
ambient temperature during operation	-20 ... +50 °C			
Certificates/ approvals				
General Product Approval		EMC	Declaration of Conformity	

[Confirmation](#)



other

Further information

Siemens has decided to exit the Russian market (see here).

<https://press.siemens.com/global/en/pressrelease/siemens-wind-down-russian-business>

Siemens is working on the renewal of the current EAC certificates.

Please contact your local Siemens office on the status of validity of the EAC certification if you intend to import or offer to supply these products to an EAC relevant market (other than the sanctioned EAEU member states Russia or Belarus).

Information on the packaging

<https://support.industry.siemens.com/cs/ww/en/view/109813875>

Information- and Downloadcenter (Catalogs, Brochures,...)

<https://www.siemens.com/ic10>

Industry Mall (Online ordering system)

<https://mall.industry.siemens.com/mall/en/en/Catalog/product?mlfb=8WD4420-5AC>

Cax online generator

<http://support.automation.siemens.com/WW/CAXorder/default.aspx?lang=en&mlfb=8WD4420-5AC>

Service&Support (Manuals, Certificates, Characteristics, FAQs,...)

<https://support.industry.siemens.com/cs/ww/en/ps/8WD4420-5AC>

Image database (product images, 2D dimension drawings, 3D models, device circuit diagrams, EPLAN macros, ...)

http://www.automation.siemens.com/bilddb/cax_de.aspx?mlfb=8WD4420-5AC&lang=en

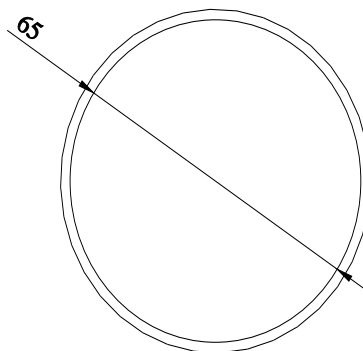
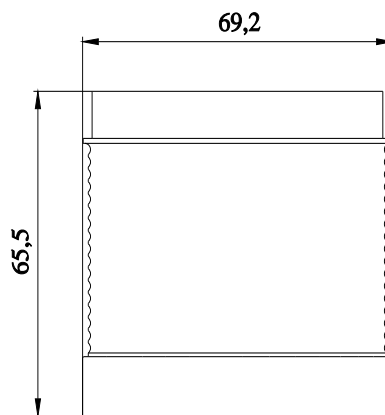

-P

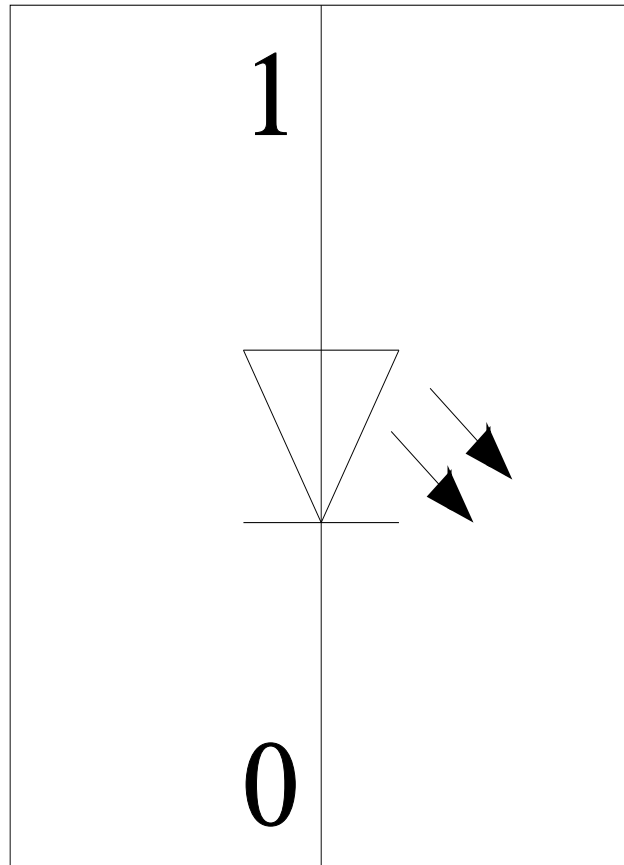

last modified:

2/25/2021 

Mouser Electronics

Authorized Distributor

Click to View Pricing, Inventory, Delivery & Lifecycle Information:

Siemens:

8WD44205AC