



Continuous light element, clear, 12-230 V AC/DC, 70 mm diameter, base BA 15d without light element

product brand name	SIRIUS			
product designation	Continuous light element			
design of the product	without light source			
General technical data				
type of voltage of the operating voltage	AC/DC			
operating voltage				
• at DC rated value				12 ... 230 V
• at AC at 50 Hz rated value				12 ... 230 V
• at AC at 60 Hz rated value				12 ... 230 V
reference code according to EN 61346-2	P			
Lamp				
product component light source	No			
type of light source	filament lamp / LED			
design of the optical signal	continuous light			
light intensity	1.31 cd			
light intensity	1.01 ... 1.78 cd			
socket design	BA 15d			
Enclosure				
height	65.5 mm			
width	70 mm			
outer diameter of the signal column element	70 mm			
material	PC			
color	clear			
fastening method	Bayonet			
protection class IP	IP65			
Ambient conditions				
ambient temperature during operation	-20 ... +60 °C			
Certificates/ approvals				
General Product Approval		EMC	Declaration of Conformity	

[Confirmation](#)



other

[Confirmation](#)

#### Further information

Siemens has decided to exit the Russian market (see here).

<https://press.siemens.com/global/en/pressrelease/siemens-wind-down-russian-business>

Siemens is working on the renewal of the current EAC certificates.

Please contact your local Siemens office on the status of validity of the EAC certification if you intend to import or offer to supply these products to an EAC relevant market (other than the sanctioned EAEU member states Russia or Belarus).

Information on the packaging

<https://support.industry.siemens.com/cs/ww/en/view/109813875>

Information- and Downloadcenter (Catalogs, Brochures,...)

<https://www.siemens.com/ic10>

Industry Mall (Online ordering system)

<https://mall.industry.siemens.com/mall/en/en/Catalog/product?mlfb=8WD4400-1AE>

Cax online generator

<http://support.automation.siemens.com/WW/CAXorder/default.aspx?lang=en&mlfb=8WD4400-1AE>

Service&Support (Manuals, Certificates, Characteristics, FAQs,...)

<https://support.industry.siemens.com/cs/ww/en/ps/8WD4400-1AE>

Image database (product images, 2D dimension drawings, 3D models, device circuit diagrams, EPLAN macros, ...)

[http://www.automation.siemens.com/bilddb/cax\\_de.aspx?mlfb=8WD4400-1AE&lang=en](http://www.automation.siemens.com/bilddb/cax_de.aspx?mlfb=8WD4400-1AE&lang=en)

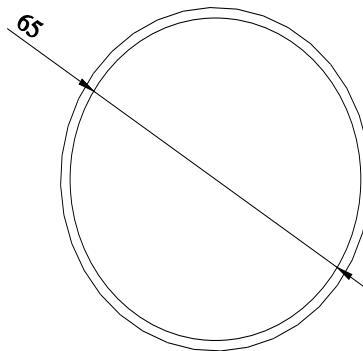
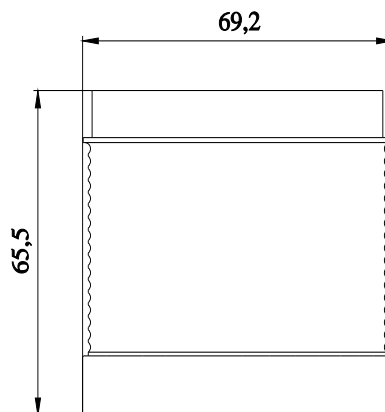

**-P**

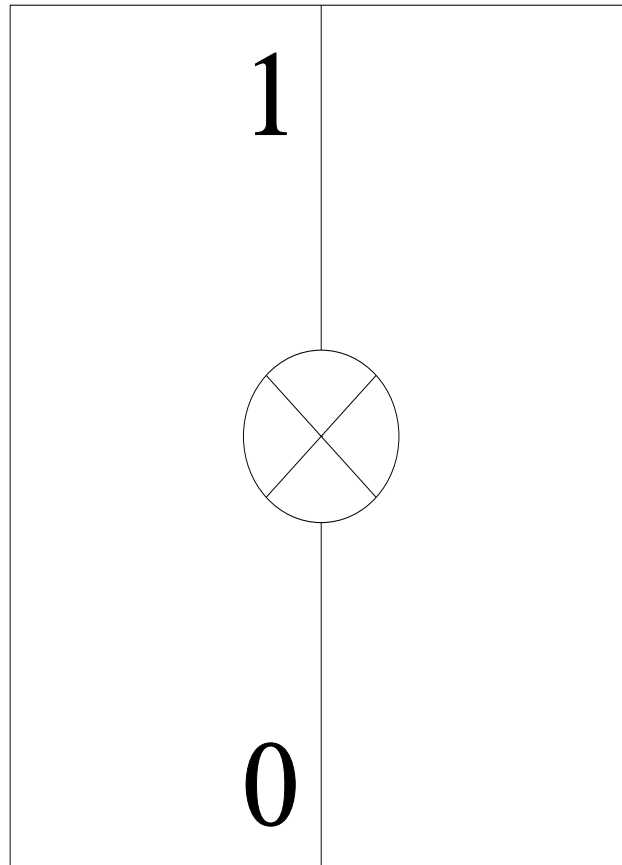

last modified:

2/25/2021 

# Mouser Electronics

Authorized Distributor

Click to View Pricing, Inventory, Delivery & Lifecycle Information:

Siemens:

8WD44001AE