



Accessory for position switches 3SE51/52; M12 connector 5-pole, for M20 x 1.5; Pin1=Brown cable, Pin2=White cable, Pin3=Yellow-green cable, Pin4=Black cable, Pin5=Gray cable. Suitable for wiring sensors that are to be connected to all SIMATIC ET200 compact block I/O modules .

General technical data	
operational current at 40 °C rated value	4 A
operating voltage rated value	60 V
number of poles	5
insulation resistance	100 MΩ
ambient temperature during operation	-40 ... +85 °C
connector coding of the M12 circular connector	A - Standard
type of electrical connection	connector M12
color coding of the core	pin 1 = BN, pin 2 = WH, pin 3 = GN/YE, pin 4 = BK, pin 5 = GY
overvoltage category	2
degree of pollution	3
protection class IP	IP67
material	
• of the contact	CuSn
• of contact coating	Au
• of contact main body	PA

Certificates/ approvals		
General Product Approval	Declaration of Conformity	other

[Confirmation](#)



[Confirmation](#)

Further information
Siemens has decided to exit the Russian market (see here). https://press.siemens.com/global/en/pressrelease/siemens-wind-down-russian-business
Siemens is working on the renewal of the current EAC certificates. Please contact your local Siemens office on the status of validity of the EAC certification if you intend to import or offer to supply these products to an EAC relevant market (other than the sanctioned EAEU member states Russia or Belarus).
Information on the packaging https://support.industry.siemens.com/cs/ww/en/view/109813875
Information- and Downloadcenter (Catalogs, Brochures,...) https://www.siemens.com/ic10
Industry Mall (Online ordering system) https://mall.industry.siemens.com/mall/en/en/Catalog/product?mlfb=3SX5100-1SS51
Cax online generator http://support.automation.siemens.com/WW/CAXorder/default.aspx?lang=en&mlfb=3SX5100-1SS51
Service&Support (Manuals, Certificates, Characteristics, FAQs,...) https://support.industry.siemens.com/cs/ww/en/ps/3SX5100-1SS51
Image database (product images, 2D dimension drawings, 3D models, device circuit diagrams, EPLAN macros, ...) http://www.automation.siemens.com/bilddb/cax_de.aspx?mlfb=3SX5100-1SS51&lang=en

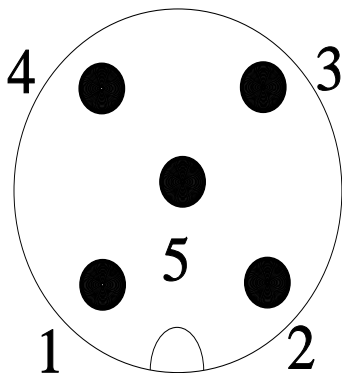
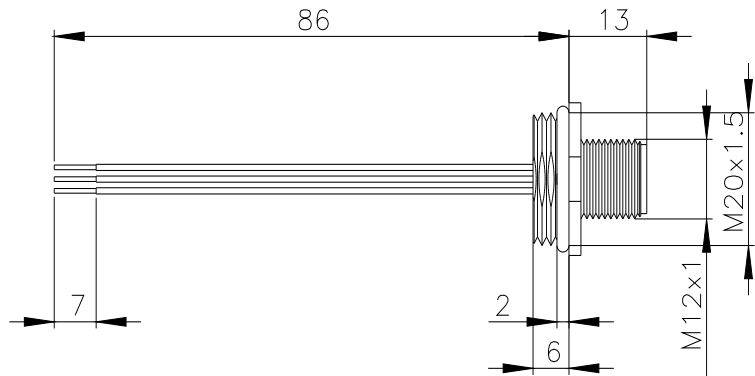
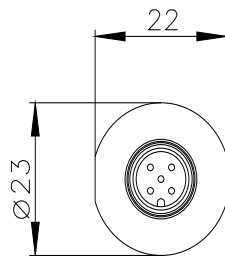

1	BN = Brown
2	WH = White
3	GN/YE = Green/Yellow
4	BK = Black
5	GY = Grey

Mouser Electronics

Authorized Distributor

Click to View Pricing, Inventory, Delivery & Lifecycle Information:

Siemens:

3SX51001SS51