

two-hand operation console for command devices, 22 mm, round, enclosure material plastic, enclosure top part gray, 3 holes for command points, 8 additional preset breaking points for 22 mm command devices, 2 mushroom pushbuttons black 40 mm, 2x1NO+1NC, screw terminal, 1 EMERGENCY STOP red, 40 mm, 2 NC, screw terminal, front mounting, with cable cut-outs for metric screw connections



<b>product brand name</b>	SIRIUS ACT
<b>product designation</b>	Two-hand operation console
<b>product type designation</b>	3SU1
<b>manufacturer's article number</b>	
<ul style="list-style-type: none"> <li>of supplied contact module</li> <li>of supplied contact module at the command point A 1</li> <li>of supplied contact module at the command point A 3</li> <li>of supplied contact module at the command point B 1</li> <li>of supplied contact module at the command point B 3</li> <li>of supplied contact module at the command point C 1</li> <li>of supplied contact module at the command point C 3</li> <li>of the supplied holder at the command point A</li> <li>of the supplied holder at the command point B</li> <li>of the supplied holder at the command point C</li> <li>of the supplied actuator at the command point A</li> <li>of the supplied actuator at the command point B</li> <li>of the supplied actuator at the command point C</li> <li>of supplied empty enclosure</li> <li>of the supplied accessories at the command point B</li> </ul>	<p>R2 = 3SU1400-1AA10-1BA0 / L2 = 3SU1400-1AA10-1BA0 / M1 = 3SU1400-1AA10-1CA0 / R1 = 3SU1400-1AA10-1CA0 / L1 = 3SU1400-1AA10-1CA0 / M2 = 3SU1400-1AA10-1CA0</p> <p><a href="#">3SU1400-1AA10-1CA0</a></p> <p><a href="#">3SU1400-1AA10-1BA0</a></p> <p><a href="#">3SU1400-1AA10-1CA0</a></p> <p><a href="#">3SU1400-1AA10-1CA0</a></p> <p><a href="#">3SU1400-1AA10-1CA0</a></p> <p><a href="#">3SU1400-1AA10-1BA0</a></p> <p><a href="#">3SU1550-0AA10-0AA0</a></p> <p><a href="#">3SU1550-0AA10-0AA0</a></p> <p><a href="#">3SU1550-0AA10-0AA0</a></p> <p><a href="#">3SU1000-1BD10-0AA0</a></p> <p><a href="#">3SU1000-1HB20-0AA0</a></p> <p><a href="#">3SU1000-1BD10-0AA0</a></p> <p><a href="#">3SU1803-3AA00-0AA1</a></p> <p><a href="#">3SU1900-0BB31-0AT0</a></p>
<b>Enclosure</b>	
<b>design of the housing</b>	Two-hand operating console with standard components
<b>material of the enclosure</b>	plastic
<b>number of command points</b>	3
color of the enclosure top part	grey
<b>delivery state</b>	
<ul style="list-style-type: none"> <li>as a kit</li> <li>pre-wired on strip terminal</li> </ul>	<p>No</p> <p>No</p>
<b>fastening method of the enclosure</b>	Horizontal
<b>Actuator</b>	
<b>design of the actuating element</b>	A = mushroom pushbutton / B = EMERGENCY STOP mushroom pushbutton / C = mushroom pushbutton
<b>principle of operation of the actuating element</b>	A = momentary contact / B = latching / C = momentary contact
<b>product feature</b>	
<ul style="list-style-type: none"> <li>lockout</li> <li>staggered switching</li> </ul>	<p>No</p> <p>No</p>
color of the actuating element	A = black / B = red / C = black
<b>material of the actuating element</b>	plastic
<b>shape of the actuating element</b>	round
<b>number of contact modules</b>	6

type of unlocking device	A = none / B = rotate to unlock / C = none
<b>Front ring</b>	
product component front ring	Yes
material of the front ring	plastic
color of the front ring	black
<b>Holder</b>	
material of the holder	Plastic
<b>General technical data</b>	
product function	
• positive opening	Yes
• EMERGENCY OFF function	Yes
• EMERGENCY STOP function	Yes
product component stand/pedestal	No
protection class IP	IP66
degree of protection NEMA rating	1, 4X, 12K, indoor use only, 13
shock resistance according to IEC 60068-2-27	sinusoidal half-wave 15g / 11 ms
vibration resistance according to IEC 60068-2-6	10 ... 500 Hz: 5g
reference code according to IEC 81346-2	S
continuous current of the C characteristic MCB	10 A; for a short-circuit current smaller than 400 A
continuous current of the quick DIAZED fuse link	10 A
continuous current of the DIAZED fuse link gG	10 A
Substance Prohibitance (Date)	10/01/2014
<b>Auxiliary circuit</b>	
design of the contact of auxiliary contacts	Silver alloy
number of NC contacts for auxiliary contacts	4
number of NO contacts for auxiliary contacts	2
<b>Connections/ Terminals</b>	
type of electrical connection on enclosure	Cable routing at the rear 2 x M25
<b>Safety related data</b>	
B10 value with high demand rate according to SN 31920	100 000
proportion of dangerous failures	
• with low demand rate according to SN 31920	20 %
• with high demand rate according to SN 31920	20 %
failure rate [FIT] with low demand rate according to SN 31920	100 FIT
<b>Ambient conditions</b>	
ambient temperature	
• during operation	-25 ... +70 °C
• during storage	-40 ... +80 °C
environmental category during operation according to IEC 60721	3M6, 3S2, 3B2, 3C3, 3K6 (with relative air humidity of 10 ... 95%, no condensation in operation permitted for all devices behind front panel)
<b>Installation/ mounting/ dimensions</b>	
fastening method of modules and accessories	Front plate mounting
height	185.3 mm
width	469.2 mm
depth	137.4 mm
<b>Accessories</b>	
number of backing plates	1
marking of backing plate	EMERGENCY-STOP
color of backing plate	Yellow
<b>Certificates/ approvals</b>	
General Product Approval	
Declaration of Con- formity	

[Confirmation](#)



Declaration of Con- formity	Test Certificates	Marine / Shipping
--------------------------------	-------------------	-------------------



[Type Test Certificates/Test Report](#)

[Special Test Certificate](#)



Marine / Shipping

other

Environment



[Confirmation](#)

[Environmental Confirmations](#)

#### Further information

**Siemens has decided to exit the Russian market (see here).**

<https://press.siemens.com/global/en/pressrelease/siemens-wind-down-russian-business>

**Siemens is working on the renewal of the current EAC certificates.**

Please contact your local Siemens office on the status of validity of the EAC certification if you intend to import or offer to supply these products to an EAC relevant market (other than the sanctioned EAEU member states Russia or Belarus).

**Information on the packaging**

<https://support.industry.siemens.com/cs/ww/en/view/109813875>

**Information- and Downloadcenter (Catalogs, Brochures,...)**

<https://www.siemens.com/ic10>

**Industry Mall (Online ordering system)**

<https://mall.industry.siemens.com/mall/en/en/Catalog/product?mlfb=3SU1803-3NB00-1AE1>

**Cax online generator**

<http://support.automation.siemens.com/WW/CAXorder/default.aspx?lang=en&mlfb=3SU1803-3NB00-1AE1>

**Service&Support (Manuals, Certificates, Characteristics, FAQs,...)**

<https://support.industry.siemens.com/cs/ww/en/ps/3SU1803-3NB00-1AE1>

**Image database (product images, 2D dimension drawings, 3D models, device circuit diagrams, EPLAN macros, ...)**

[http://www.automation.siemens.com/bilddb/cax\\_de.aspx?mlfb=3SU1803-3NB00-1AE1&lang=en](http://www.automation.siemens.com/bilddb/cax_de.aspx?mlfb=3SU1803-3NB00-1AE1&lang=en)

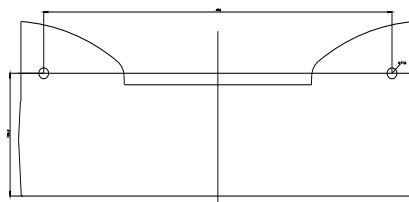
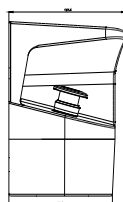
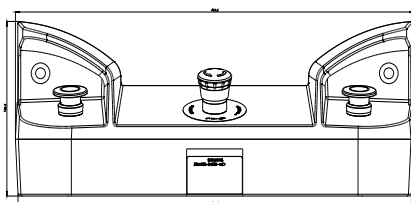

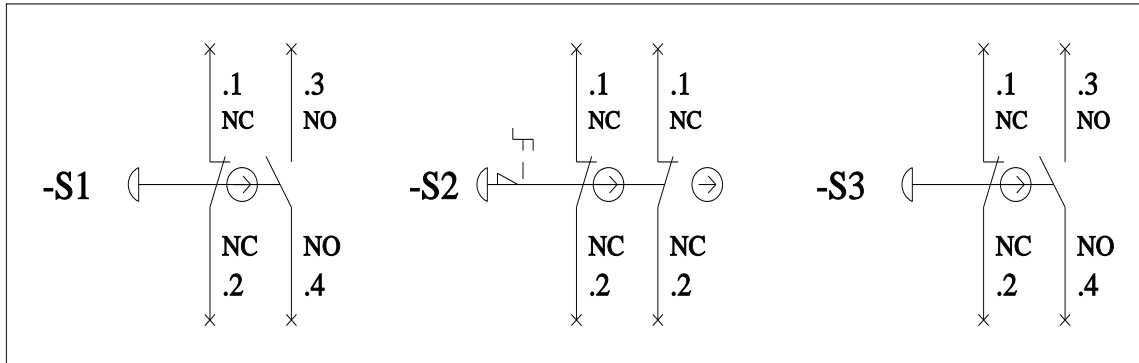

last modified:

1/26/2022 [↗](#)

# Mouser Electronics

Authorized Distributor

Click to View Pricing, Inventory, Delivery & Lifecycle Information:

Siemens:

[3SU18033NB001AE1](#)