



Contactor, 42DP,90A,3P,Open,240 Contactor, 42DP,90A,3P,Open,240

| | |
|-------------------------------------------------------------------------|-------------------------------------------------------------------|
| product brand name | Class 42 DP Contactors |
| design of the product | Non-reversing Definite Purpose Contactor |
| special product feature | Snap on auxiliary contacts, enclosed body design |
| General technical data | |
| weight [lb] | 4.08 lb |
| Height x Width x Depth [in] | 5.02 × 3.5 × 4.39 in |
| touch protection against electrical shock | Not finger-safe |
| ambient temperature [°F] | |
| • during storage | 158 °F |
| • during operation | 158 ... 158 °F |
| ambient temperature | |
| • during storage | 75 °C |
| • during operation | 70 ... 70 °C |
| country of origin | China |
| number of poles for main current circuit | 3 |
| Horsepower ratings | |
| yielded mechanical performance [hp] for 3-phase AC motor | |
| • at 460/480 V rated value | 50 hp |
| • at 575/600 V rated value | 50 hp |
| Contactor | |
| size of contactor | 90A |
| number of NO contacts for main contacts | 3 |
| operating voltage for main current circuit at AC at 60 Hz maximum | 600 V |
| operational current at AC at 600 V rated value | 360 A |
| mechanical service life (operating cycles) of the main contacts typical | 250000 |
| Auxiliary contact | |
| number of NC contacts for auxiliary contacts | 2 |
| number of NO contacts for auxiliary contacts | 2 |
| number of NC contacts at contactor for auxiliary contacts | 0 |
| number of NO contacts at contactor for auxiliary contacts | 0 |
| number of total auxiliary contacts maximum | 2 |
| operational current of auxiliary contacts of contactor | |
| • at AC at 600 V | 10 A |
| contact rating of auxiliary contacts of contactor according to UL | 10A@600VAC (A600), 11A 1/2HP 125-250VAC, 0.6A 125VDC, 0.3A 250VDC |
| Coil | |
| control supply voltage | |
| • at AC at 50 Hz rated value | 190 ... 220 V |
| • at AC at 60 Hz rated value | 208 ... 240 V |

| | |
|--------------------------------------------------------------------------------------------------------------------|--------------------------------------|
| Enclosure | |
| degree of protection NEMA rating of the enclosure | Open device (no enclosure) |
| Mounting/wiring | |
| mounting position | vertical |
| fastening method | Surface mounting and installation |
| type of electrical connection for supply voltage line-side | Box lug |
| tightening torque [lbf-in] for supply | 60 ... 60 lbf-in |
| type of connectable conductor cross-sections at line-side for AWG cables single or multi-stranded | 1/0 AWG |
| type of electrical connection for load-side outgoing feeder | Box lug |
| type of connectable conductor cross-sections for AWG cables for load-side outgoing feeder single or multi-stranded | 1/0 AWG |
| type of electrical connection of magnet coil | Quick connects, Screw-type terminals |
| type of electrical connection for auxiliary and control circuit | Quick Connects, Screw-type terminals |
| type of electrical connection at contactor for auxiliary contacts | Screw-type terminals |
| Certificates/ approvals | |
| certificate of suitability | cRUus, ARI 780 & 790, UL File E14900 |
| Further information | |

Industrial Controls - Product Overview (Catalogs, Brochures,...)

www.usa.siemens.com/iccatalog

Industry Mall (Online ordering system)

<https://mall.industry.siemens.com/mall/en/us/Catalog/product?mlfb=US2:42GE35AG>

Service&Support (Manuals, Certificates, Characteristics, FAQs,...)

<https://support.industry.siemens.com/cs/US/en/ps/US2:42GE35AG>

Image database (product images, 2D dimension drawings, 3D models, device circuit diagrams, EPLAN macros, ...)

http://www.automation.siemens.com/bilddb/cax_de.aspx?mlfb=US2:42GE35AG&lang=en

Certificates/approvals

<https://support.industry.siemens.com/cs/US/en/ps/US2:42GE35AG/certificate>

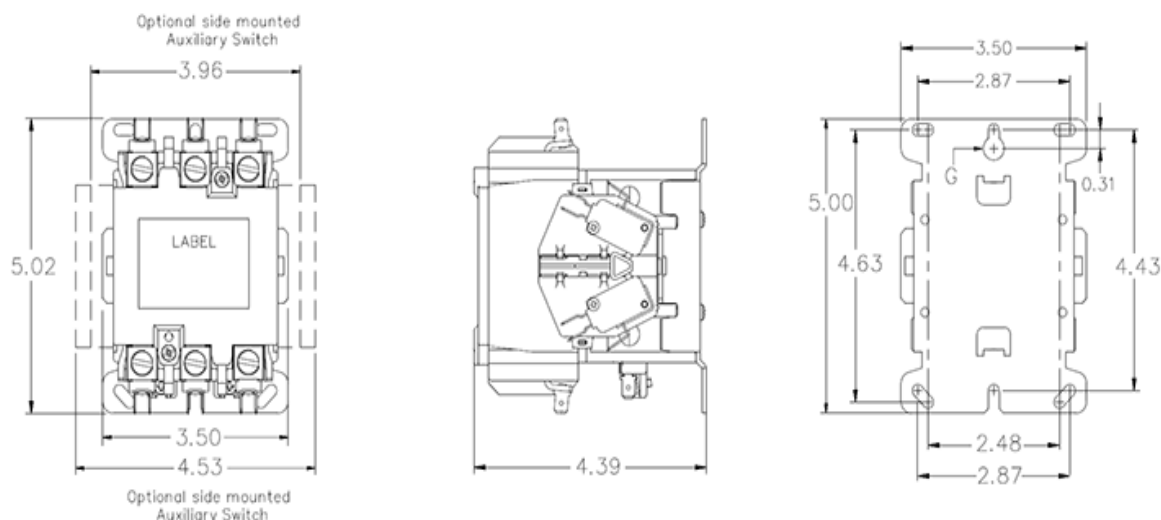

last modified:

5/25/2021

Mouser Electronics

Authorized Distributor

Click to View Pricing, Inventory, Delivery & Lifecycle Information:

Siemens:

42GE35AG