

RECOMMENDED P.C.B. LAYOUT

		RED LED		
LED SPECIFICATION	SYMBOL	MAX. MIN.	TYP.	UNITS
POWER DISSIPATION	P _D	80 --		mW
FORWARD VOLTAGE	V _F	2.8 1.9	2.2	V
REVERSE VOLTAGE	V _R	5		V
EMISSION WAVELENGTH	λ _P		695	nm
AVE. FORWARD CURRENT	I _{AF}	30 --		mA
LUMINOUS INTENSITY	I _V	0.7	22	mcđ

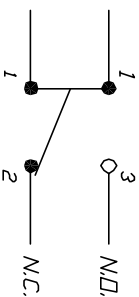
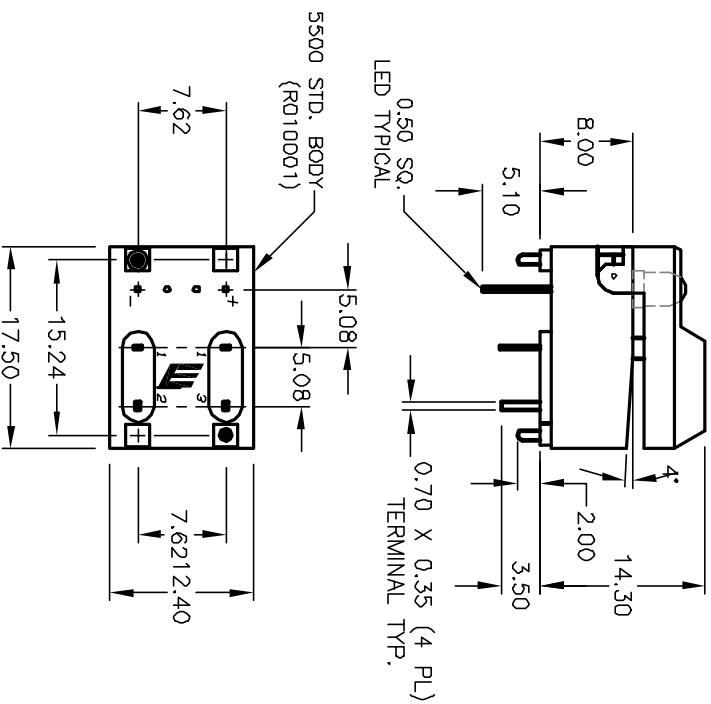

NOTES:

1. ALL DIMENSIONS IN MM
2. GENERAL TOLERANCE: X.X=±0.4
X.XX=±0.25
3. TERM. NO. FOR REF. ONLY
4. RATING: 12mA @24V
5. FIXED CONTACT/MOVING CONTACT:
COPPER ALLOY W/GOLD PLATE
6. CONTACT BOUNCE: <5m SEC.
7. CONTACT RESISTANCE: <50milli-OHMS
8. TRAVEL: 2.5±0.2mm



					TITLE			
A	12151	RELEASED FOR PRODUCTION	5/14/02	CJB		5511-M-4-1		
REV.	ECN No.	DESCRIPTION	DATE	CHKD				
THE INFORMATION CONTAINED IN THIS DOCUMENT IS PROPRIETARY TO E-SWITCH AND IS NOT TO BE COPIED OR TRANSFERRED					SCALE	DATE	DR	DWG
					1.5:1	5/14/02	CJB	KR0171P
								REV A

Mouser Electronics

Authorized Distributor

Click to View Pricing, Inventory, Delivery & Lifecycle Information:

[E-Switch:](#)

[5511M41](#)