

NOTES:

1. ALL DIMENSIONS IN MM [INCH]
2. GENERAL TOLERANCE: x.x=± 0.4mm
x.xx=± 0.25mm
3. RATING: DC 30V, 0.3A
4. OPERATING FORCE: 200± 100gf
5. TRAVEL: 3.3mm FULL TRAVEL
2.5mm TO LOCK
6. LIFE CYCLES: 10,000 CYCLES
7. OPERATING TEMPERATURE: -20°C TO 70°C
8. CONTACT RESISTANCE: 20mΩ MAX.
9. INSULATION RESISTANCE: 100MΩ MIN@ 500VDC.
- ▲10. LED COLOR: YELLOW
11. ▲ DENOTES CRITICAL PARAMETER.
12. 2002/95/EC (RoHS) COMPLIANT.

R05 BUTTON
CLEAR
(B410000)

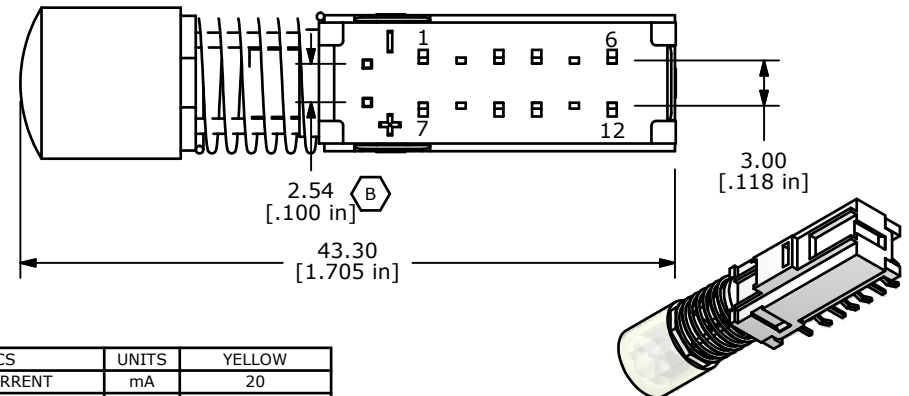
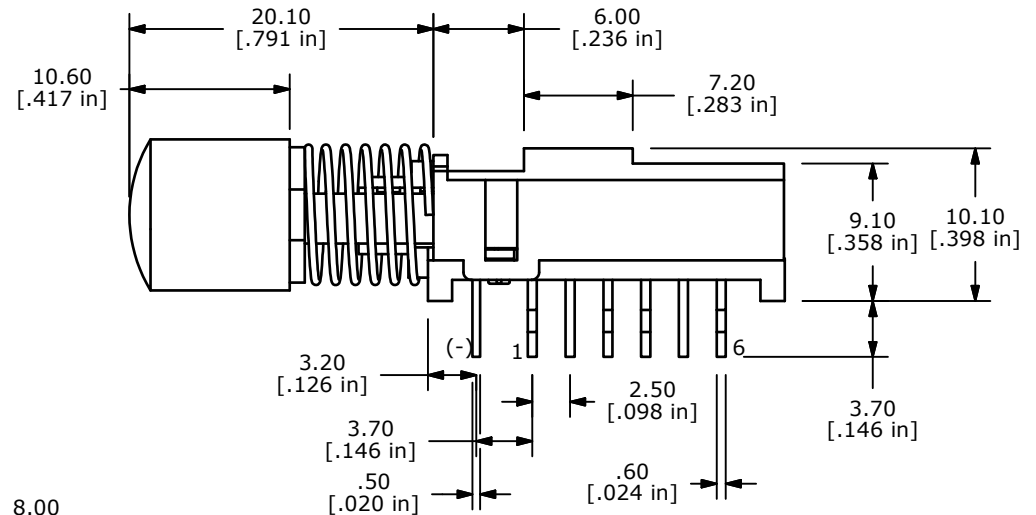
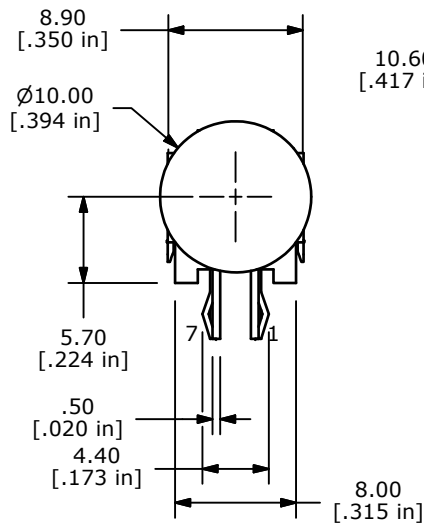

LED SPECS	UNITS	YELLOW
FORWARD CURRENT	mA	20
FORWARD VOLTAGE @20mA	V	1.7 Typ-2.6 Max
LUMINOUS INTENSITY @ 10mA	MCD	4.7



TITLE WBL4UEEYQR05CLR

SCALE 2:1

DATE 8/22/2011

DR BGL

DWG XB0935P

REV B

THE INFORMATION CONTAINED IN THIS DOCUMENT IS PROPRIETARY
TO E-SWITCH AND IS NOT TO BE COPIED OR TRANSFERRED

B	20153	DIM. CHANGE WAS 3.0	9/14/11	BGL
A	20110	New-Release	8/22/11	BGL
REV	PCR NO	DESCRIPTION	DATE	BY

Mouser Electronics

Authorized Distributor

Click to View Pricing, Inventory, Delivery & Lifecycle Information:

[E-Switch:](#)

[WBL4UEEYQR05CLR](#)