

PANEL THICKNESS	X dimension
0.75-1.25 [.030-.049]	19.2-.01 [.756]
1.25-2.0 [.049-.079]	19.4-.01 [.764]
2.0-3.0 [.079-.118]	19.8-.01 [.780]

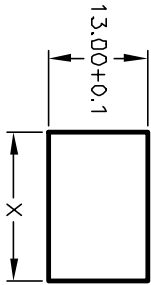

PANEL CUTOUT  
NOT TO SCALE

SWITCH FUNCTION	
PDS, 1	PDS, 2
DN	UP
1-1a	OPEN

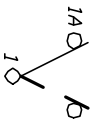

CIRCUIT: SPST

NOTES:

- ALL DIMENSIONS IN MM [INCH]
- GENERAL TOLERANCE:  $X.X=\pm 0.4$   
 $X.XX=\pm 0.25$
- TERMINAL NUMBERS FOR REF ONLY
- RATING:  
15A @125VAC; 8A @250V UL,VDE,CSA APPROVED  
6A @250VAC
- MATERIALS: (TERMINALS) SILVER PLATED COPPER  
(CONTACTS) COIN SILVER, SILVER PLATED.
- CONTACT RESISTANCE: <20 Mega
- ELECTRICAL LIFE: 10,000 cycles
- INSULATION RESISTANCE: >1000 Mega
- DIELECTRIC STRENGTH: >1500V 1 minute  
>3000V between Poles
- OPERATING TEMP. RANGE: -25°C to +85°C

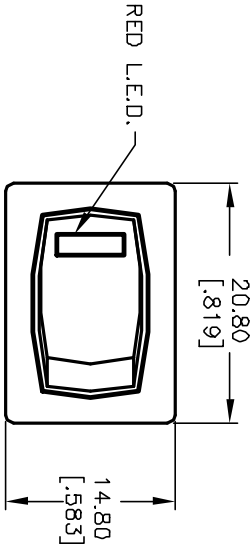

RED L.E.D.

PARAMETERS	SYMBOL	MAX.	TYP.	UNITS
POWER DISSIPATION	$P_D$	80		mW
Ave FORWARD CURRENT	$I_{AF}$	--		mA
PEAK FORWARD CURRENT	$I_{PF}$	100		mA
REVERSE VOLTAGE	$V_R$	5		V
FORWARD VOLTAGE	$V_F$	2.1	1.7	V
REVERSE CURRENT	$I_R$		100	$\mu A$
EMISSION WAVELENGTH	$\lambda_p$		660	nm
LUMINOUS INTENSITY	$I_v$		30	mcđ

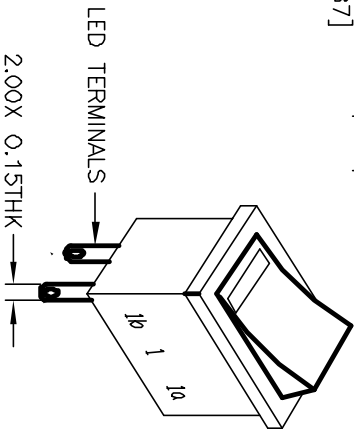
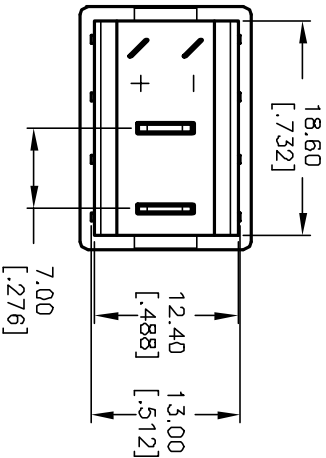
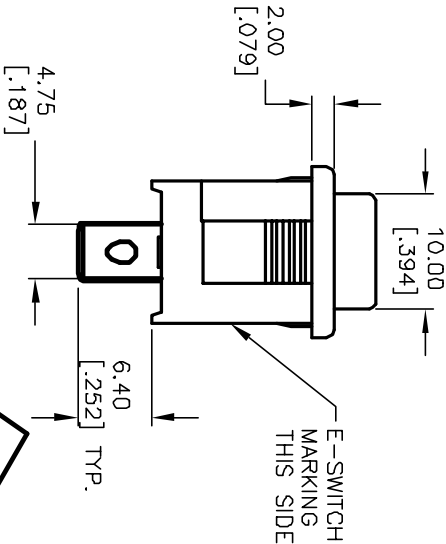
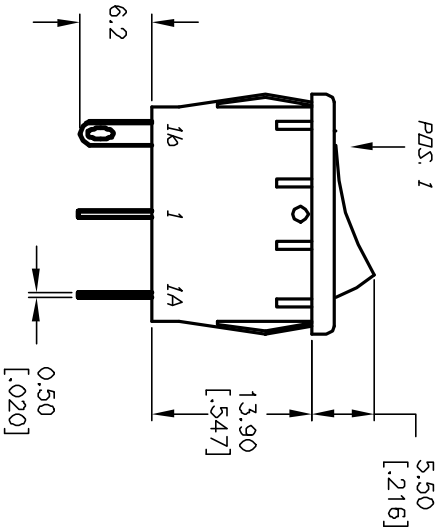

ORTHOGRAPHIC PROJECTION  
FOR CLARITY ONLY

TITLE			
R1966A BLK BLK E G RED			
E-SWITCH®			
A	12393	RELEASED	8/29/02
REV.	ECN No.	DESCRIPTION	DATE
THE INFORMATION CONTAINED IN THIS DOCUMENT IS PROPRIETARY TO E-SWITCH AND ITS NOT TO BE COPIED OR TRANSFERRED			
SCALE 1.5:1			
DATE 9/20/01			
DR CB			
DWG M301119			
REV A			

# Mouser Electronics

Authorized Distributor

Click to View Pricing, Inventory, Delivery & Lifecycle Information:

[E-Switch:](#)

[R1966ABLKBLKEGRED](#)