

NOTE:

- ALL DIMENSIONS IN MM [INCH]
- GENERAL TOLERANCE: X.X = ±0.4
X.XX = ±0.25
- TERMINAL NUMBERS FOR REF ONLY
- CONTACT MATERIAL: SILVER PLATED
- RATING: 2A 36VDC
- ELECTRIC LIFE: 100,000
- INSULATION RESISTANCE: 1,000MΩ MIN @ 500VDC.
- DIELECTRIC STRENGTH: 2,000VAC MIN. FOR 1 MINUTE
- CONTACT RESISTANCE: 50mΩ MAX. @ 1A 12VDC
- OPERATING TEMP.: -20°C to 70°C
- TRAVEL: 2.30mm ±0.40mm
- ▲ DENOTES CRITICAL PARAMETER.
- ILLUMINATION COLOR: BLUE (ON POSITION)
- ILLUMINATION VOLTAGE RATING: 3V @ 20 mA
- HARDWARE SUPPLIED: O-RING AND HEXNUT (NOT SHOWN)
- INGRESS PROTECTION: IP67
- OPERATING FORCE: 460 ±150gf

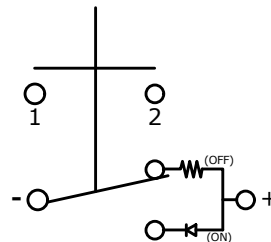

SCHEMATIC
OFF - ON
SPST LATCHING
ILLUMINATED

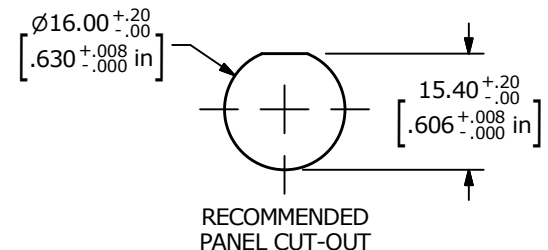

A	24060	NEW RELEASE	10/14/19	MW	TITLE PVA6LRPW1241			
REV	PCR NO	DESCRIPTION	DATE	BY	SCALE 1:1	DATE 10/14/2019	DR MW	DWG T960115
THE INFORMATION CONTAINED IN THIS DOCUMENT IS PROPRIETARY TO E-SWITCH AND IS NOT TO BE COPIED OR TRANSFERRED					REV A			

Mouser Electronics

Authorized Distributor

Click to View Pricing, Inventory, Delivery & Lifecycle Information:

[E-Switch:](#)

[PVA6LRPW1241](#)