

RECOMMENDED PANEL CUTOUT
MAX. PANEL THICKNESS 10mm

▲ SWITCH FUNCTION

POS. 1	POS. 2
OFF	(ON)
OPEN	1-2

(ON) = MOMENTARY

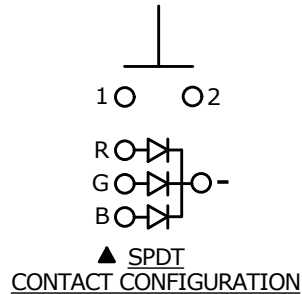

NOTE:

- ALL DIMENSIONS IN MM [INCH]
- GENERAL TOLERANCE: X.X = ± 0.4
X.XX = ± 0.25
- TERMINAL NUMBERS FOR REF ONLY
- CONTACT MATERIAL: SILVER PLATED
- RATING: 2A 48VDC
- ELECTRIC LIFE: 200,000 MAKE-AND-BREAK CYCLES
AT FULL LOAD.
- INSULATION RESISTANCE: 1,000 M Ω MIN.
- DIELECTRIC STRENGTH: 2,000 VAC MIN. FOR 1 MINUTE
- CONTACT RESISTANCE: 50m Ω MAX. @ 1A 12VDC
- OPERATING TEMP.: -20°C to 55°C
- TRAVEL: 1.8mm
- ▲ DENOTES CRITICAL PARAMETER
- HARDWARE SUPPLIED: O-RING and HEXNUT (NOT SHOWN)
- ILLUMINATION BASE RATING @ 20mA: RED - 1.8V
GREEN - 2.8V
BLUE - 2.8V

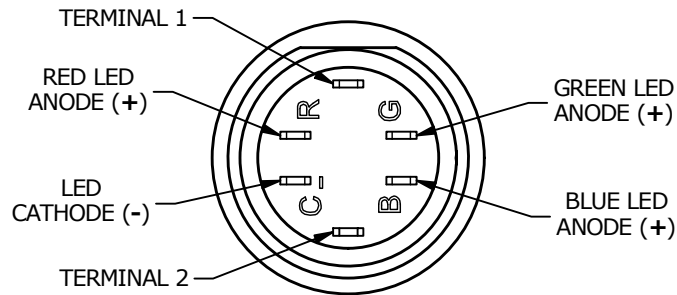
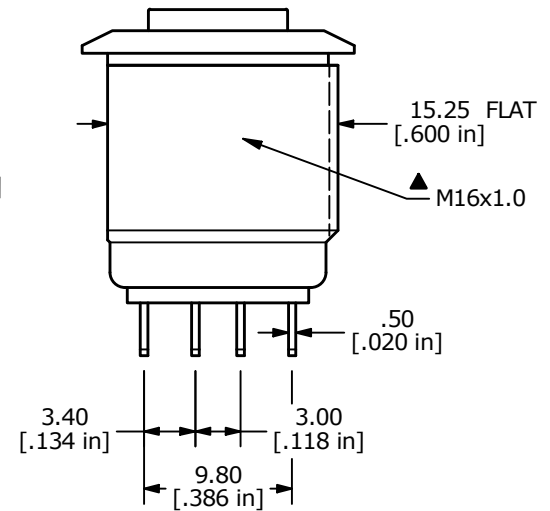
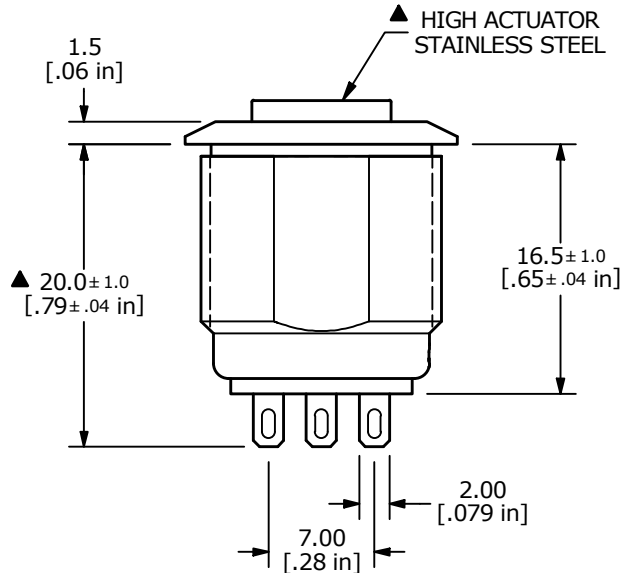
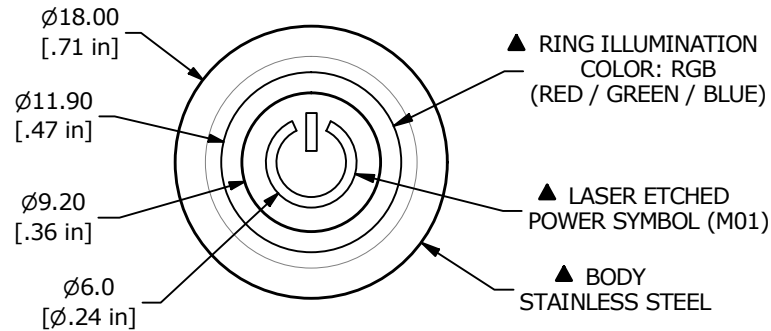

REV	ECO NO	DESCRIPTION	DATE	BY	E-SWITCH®				OBJECT ID
A	ECO-100411	Release	10/04/21	MW	TITLE PV6H240SS-3R1-M01				100119175
					SCALE	DATE	DR	DWG	REV
					2:1	10/4/2021	MW	52-PV6H240SS3R1M01	A

THE INFORMATION CONTAINED IN THIS DOCUMENT IS PROPRIETARY TO
E-SWITCH AND IS NOT TO BE COPIED OR TRANSFERRED

Mouser Electronics

Authorized Distributor

Click to View Pricing, Inventory, Delivery & Lifecycle Information:

[E-Switch:](#)

[PV6H240SS-3R1-M01](#)