

PV4 SERIES ANTI-VANDAL SWITCH



APPLICATIONS / MARKETS



Audio / Visual



Security Devices



Industrial Controls

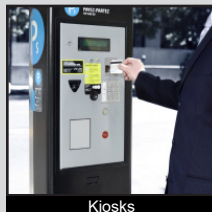

Kiosks



Electrical Housewares



Medical Equipment

RoHS

SPECIFICATIONS

Electrical Rating: 2A, 24VDC
Electrical Life: 50,000 Cycles
Contact Resistance: 50mΩ Max.
Insulation Resistance: 1000 MΩ Min.
Dielectric Strength: 2,000VAC
Operating/Storage Temperature: -20°C to 55°C
Travel: 2.50mm
Moisture Protection: IP65
Contact Arrangement: SPDT, DPDT
Actuation Force: 4 N
Panel Thickness: 1-11mm
Mounting Nut Torque: 5-14Nm

FEATURES & BENEFITS

- 19mm diameter panel cutout
- RGB LED option
- Dot, ring or power symbol illumination available
- Multiple function options
- IP65 rated
- SPDT & DPDT
- Soldered wire leads (300mm long) optional

PART NUMBER CONFIGURATOR

Series	Actuator Options	Terminal Options	Function Options	Rating Options	Body Finish Options	Actuator Finish Options	Contact Material Options	Lens Style Options	LED-Color Options	Illumination Voltage Options	Graphic (Optional)
<input type="text" value="PV4"/>	<input type="text" value="F - Flat"/> <input type="text" value="H - High"/>	<input type="text" value="2 - Solder"/> <input type="text" value="6 - Screw*"/> <input type="text" value="W - Wire"/> Leads 300mm	<input type="text" value="3 - 1P"/> On-On <input type="text" value="B - 1P"/> On-(On) <input type="text" value="G - 2P"/> On-On <input type="text" value="H - 2P"/> On-(On) <input type="text" value="Y -"/> Double break 1P Off-(On) 1P On-(Off)	<input type="text" value="0 - 2A, 24VDC"/>	<input type="text" value="S - Stainless Steel"/> <input type="text" value="1 - Black"/> Anodized	<input type="text" value="S - Stainless Steel"/> <input type="text" value="1 - Black"/> Anodized	<input type="text" value="None - Silver"/> <input type="text" value="G - Gold"/>	<input type="text" value="NONE - Non-Illuminated"/> <input type="text" value="2 - Dot"/> Illumination <input type="text" value="3 - Ring"/> Illumination	<input type="text" value="NONE - Non-Illuminated"/> <input type="text" value="0 - White"/> <input type="text" value="1 - Red"/> <input type="text" value="2 - Orange"/> <input type="text" value="3 - Green"/> <input type="text" value="4 - Blue"/> <input type="text" value="5 - Yellow"/> <input type="text" value="F - Red/Orange"/> <input type="text" value="G - Red/Green"/> <input type="text" value="H - Red/Blue"/> <input type="text" value="J - Red/Yellow"/> <input type="text" value="K - Orange/Green"/> <input type="text" value="L - Orange/Blue"/> <input type="text" value="M - Orange/Yellow"/> <input type="text" value="R - RGB LED***"/>	<input type="text" value="NONE - Non-Illuminated"/> <input type="text" value="1 - Base Voltage"/> <input type="text" value="3 - 6V"/> <input type="text" value="4 - 12V"/> <input type="text" value="5 - 24V"/> <input type="text" value="6 - 125V"/> <input type="text" value="7 - 250V"/>	<input type="text" value="M01 - Power symbol laser etched"/> <input type="text" value="M26 - Power symbol illuminated**"/>

NOTES:

() denotes function is momentary

* Screw termination is available only with "Y" function option

** Illuminated power symbol graphic is only available with ring Illumination

*** RGB is only for SPDT functions 3 and B

Specifications subject to change without notice 5.2.2019



E-SWITCH®

www.e-switch.com

800.867.2717

1

PV4 SERIES ANTI-VANDAL SWITCH

STANDARD LED FUNCTIONS 3, B, G & H

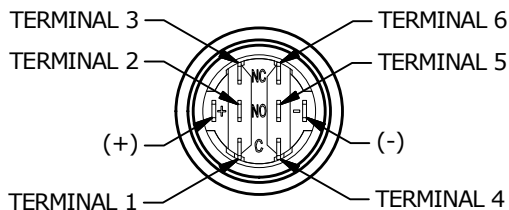
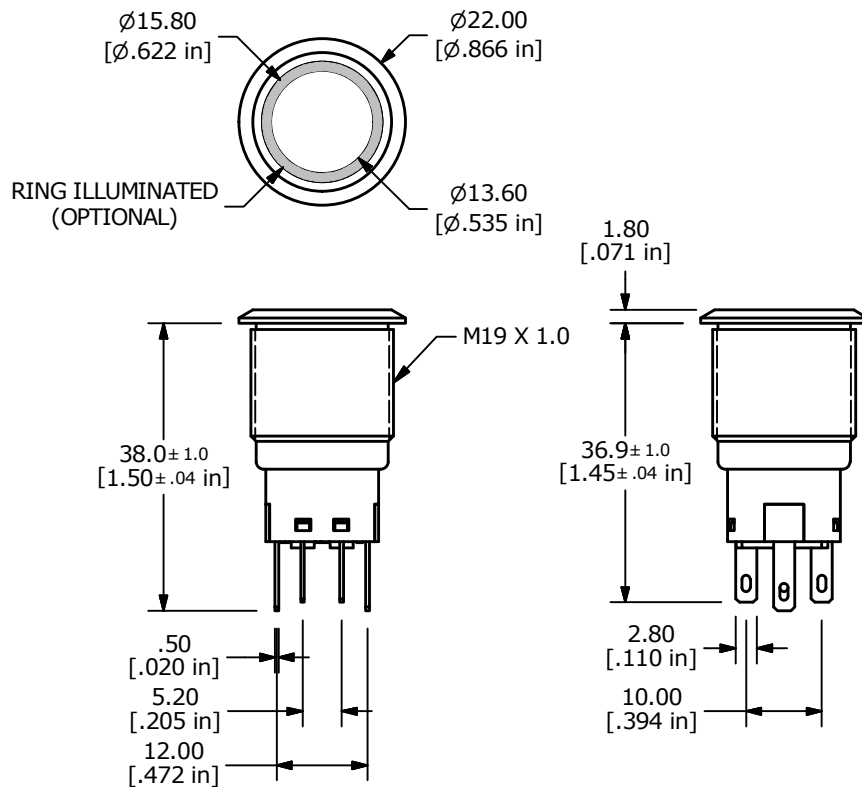

DPDT ILLUMINATED OPTION
SHOWN LED (+) AND (-)
TERMINALS ARE NOT
INCLUDED ON THE
NON-ILLUMINATED OPTION

TERMINALS 4,5 AND 6 ARE
NOT ON THE SPDT VERSION

FUNCTIONS 3 & B ARE SPDT
FUNCTIONS G & H ARE DPDT

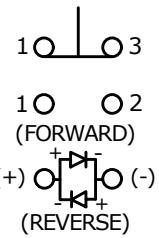

SPDT LED SCHEMATIC

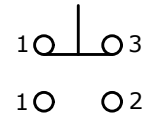

SPDT Non ILL SCHEMATIC

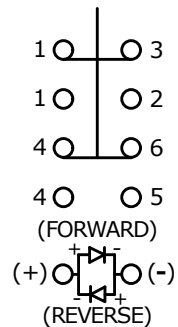

DPDT LED SCHEMATIC

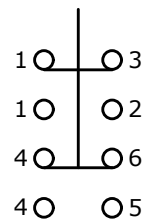

DPDT Non ILL SCHEMATIC

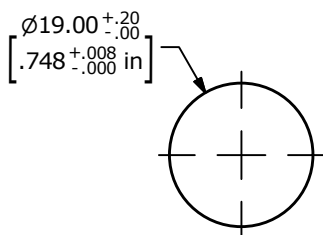

RECOMMENDED PANEL CUTOUT
MAX. PANEL THICKNESS 11.0mm

PANEL CUTOUT

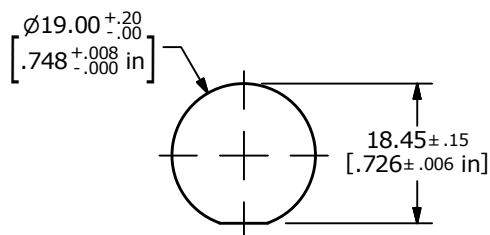

RECOMMENDED "D" PANEL CUTOUT
MAX. PANEL THICKNESS 11.0mm
"D" HOUSING TO BE USED WITH
POWER SYMBOL OR CUSTOM GRAPHICS

POWER SYMBOL PANEL CUTOUT



E-SWITCH®

www.e-switch.com

800.867.2717

2

ANTI-VANDAL SWITCHES
DETECTOR SWITCHES
DIP SWITCHES
KEYLOCK SWITCHES
NAVIGATION SWITCHES
PUSHBUTTON SWITCHES
ROCKER SWITCHES
ROTARY SWITCHES
SLIDE SWITCHES
SNAP ACTION SWITCHES
TACTILE SWITCHES
TOGGLE SWITCHES
CAP OPTIONS

PV4 SERIES ANTI-VANDAL SWITCH

Y FUNCTION W/ SOLDER TERMINALS

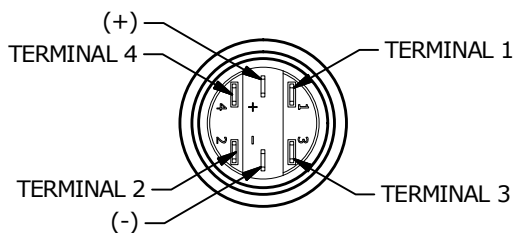
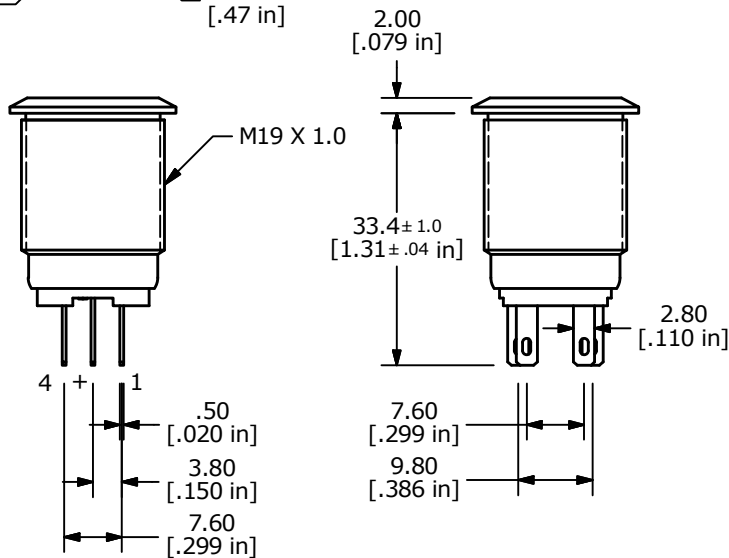
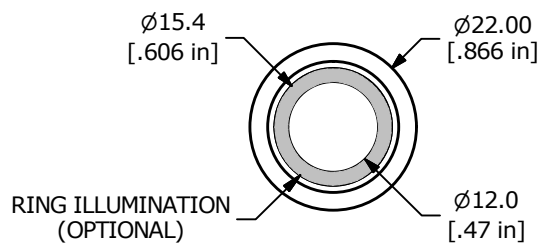

ILLUMINATED OPTION SHOWN LED
 (+) AND (-) TERMINALS ARE NOT
 ON THE NON-ILLUMINATED OPTION

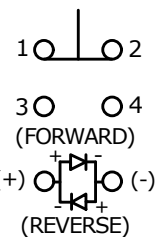

SPDT LED SCHEMATIC

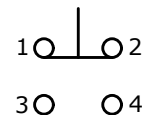

SPDT Non ILL SCHEMATIC

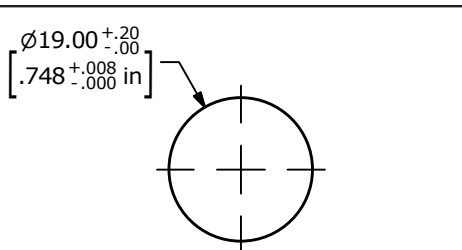

RECOMMENDED PANEL CUTOUT
 MAX. PANEL THICKNESS 11.0mm

PANEL CUTOUT

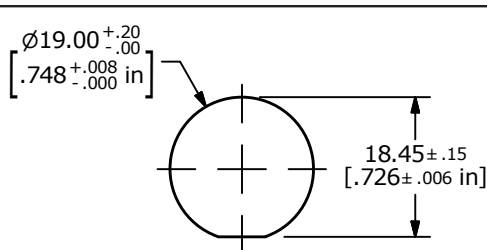

RECOMMENDED "D" PANEL CUTOUT
 MAX. PANEL THICKNESS 11.0mm
 "D" HOUSING TO BE USED WITH
 POWER SYMBOL OR CUSTOM GRAPHICS

POWER SYMBOL PANEL CUTOUT



E-SWITCH®

www.e-switch.com

800.867.2717

3

PV4 SERIES ANTI-VANDAL SWITCH

Y FUNCTION W/ SCREW TERMINALS

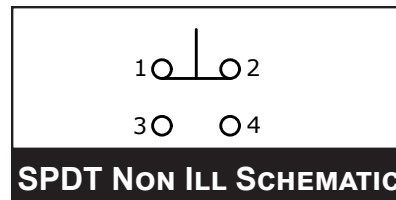
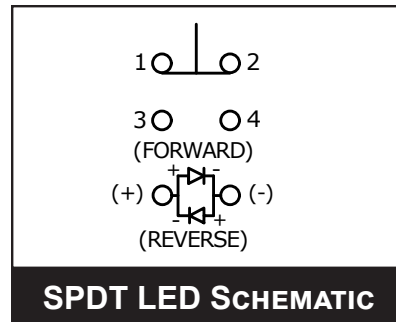
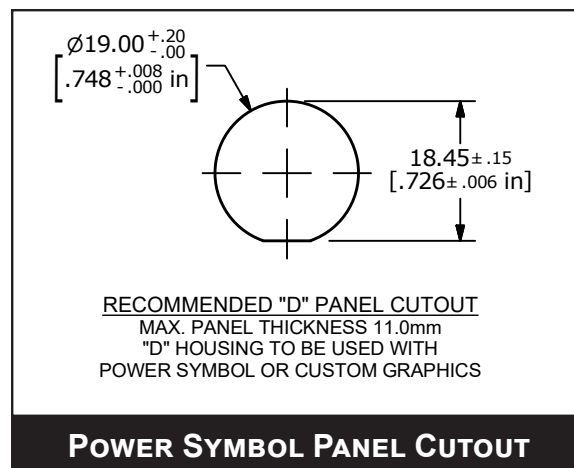
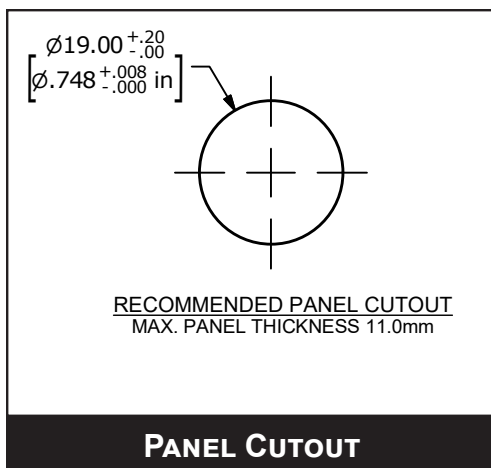
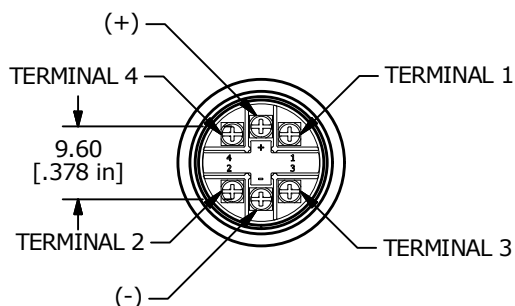
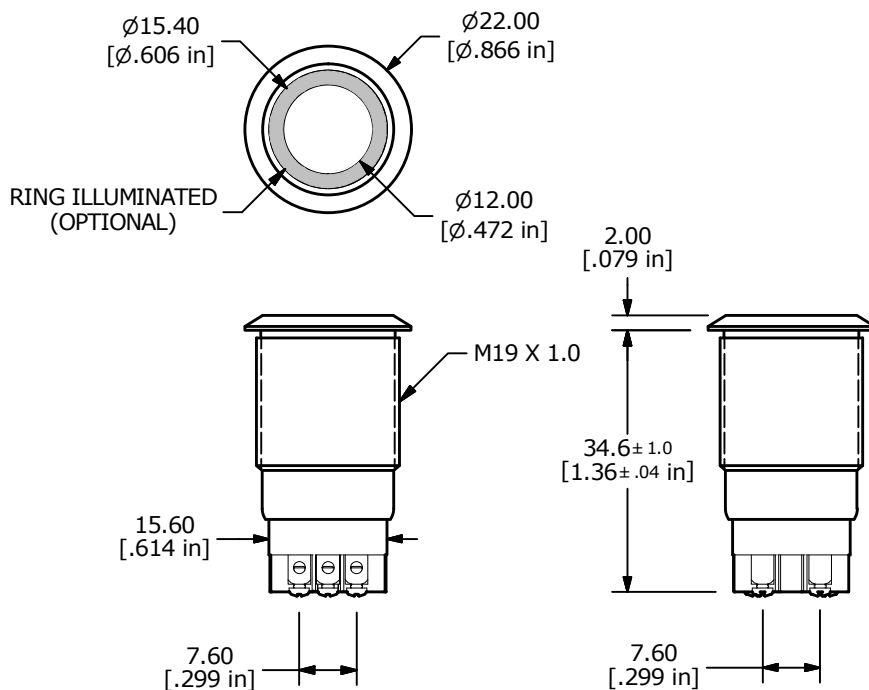

PV4 SERIES ANTI-VANDAL SWITCH

RGB LED ILLUMINATION FUNCTIONS 3 & B

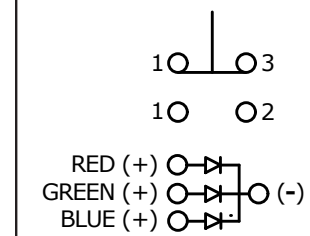
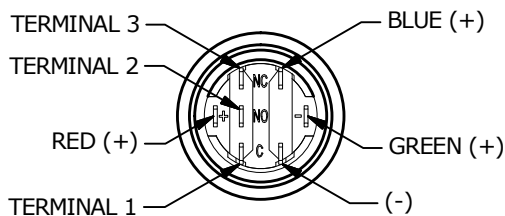
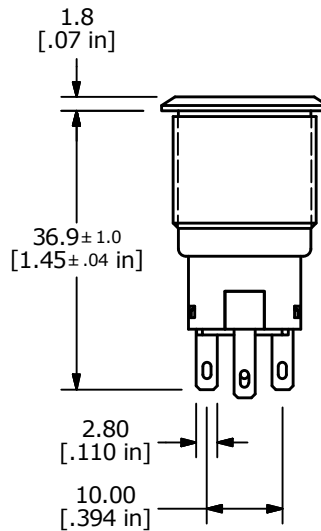
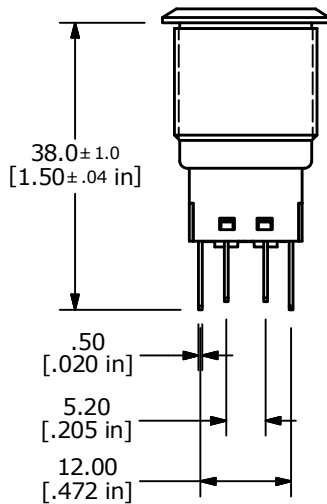
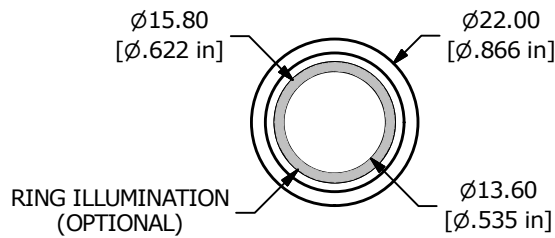

SPDT RGB LED SCHEMATIC

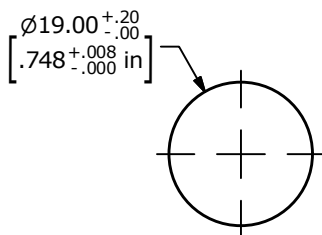

RECOMMENDED PANEL CUTOUT
MAX. PANEL THICKNESS 11.0mm

PANEL CUTOUT

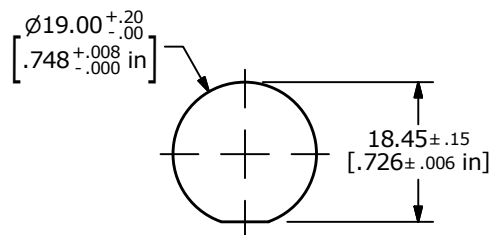

RECOMMENDED "D" PANEL CUTOUT
MAX. PANEL THICKNESS 11.0mm
"D" HOUSING TO BE USED WITH
POWER SYMBOL OR CUSTOM GRAPHICS

POWER SYMBOL PANEL CUTOUT



E-SWITCH®

www.e-switch.com

800.867.2717

5

PV4 SERIES ANTI-VANDAL SWITCH

ACTUATOR OPTIONS

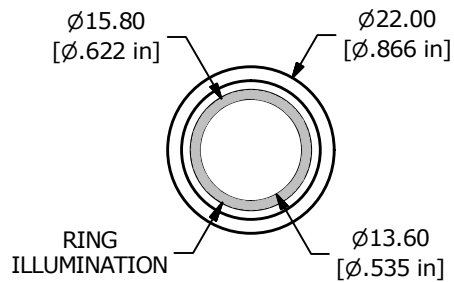
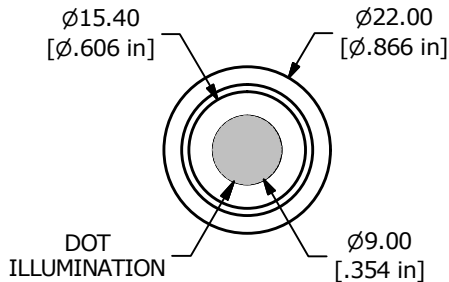
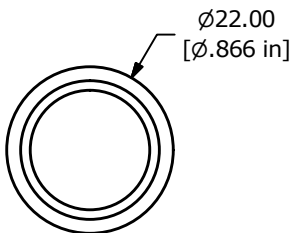

FLAT NON-ILLUMINATED

FLAT DOT ILLUMINATED

FLAT RING ILLUMINATED

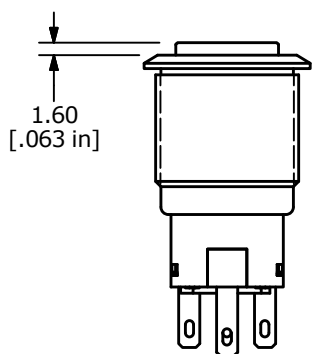

HIGH ACTUATOR

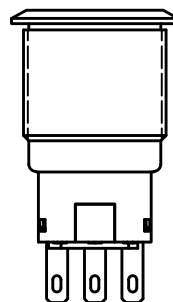

FLAT ACTUATOR

GRAPHIC OPTIONS

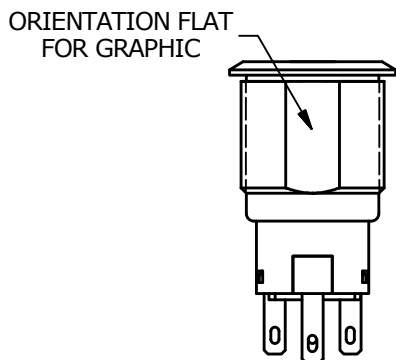
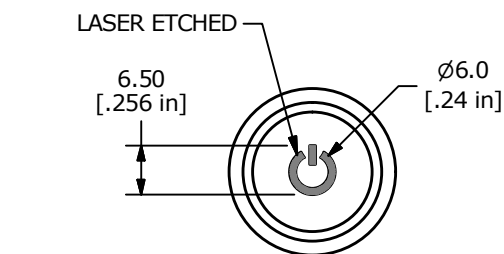

M01

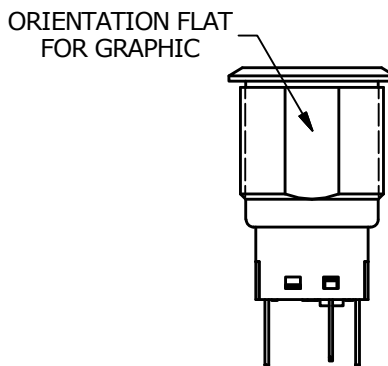
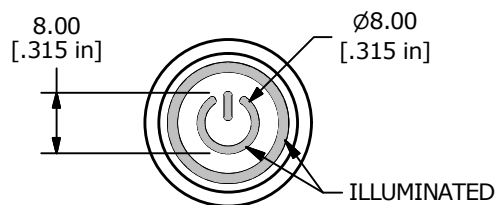

M26



E-SWITCH®

www.e-switch.com

800.867.2717

6

ANTI-VANDAL
SWITCHES

DETECTOR
SWITCHES

DIP
SWITCHES

KEYLOCK
SWITCHES

NAVIGATION
SWITCHES

PUSHBUTTON
SWITCHES

ROCKER
SWITCHES

ROTARY
SWITCHES

SLIDE
SWITCHES

SNAP ACTION
SWITCHES

TACTILE
SWITCHES

TOGGLE
SWITCHES

CAP
OPTIONS

PV4 SERIES ANTI-VANDAL SWITCH

STANDARD LED WIRE LEAD

SWITCH	WIRE	LENGTH
SW1-1	WIRE, 24AWG AWM UL1015, YELLOW	300.0 [11.8 in]
SW1-2	WIRE, 24AWG AWM UL1015, BLUE	300.0 [11.8 in]
SW1-3	WIRE, 24AWG AWM UL1015, GREEN	300.0 [11.8 in]
SW1-4	WIRE, 24AWG AWM UL1015, PURPLE	300.0 [11.8 in]
SW1-5	WIRE, 24AWG AWM UL1015, ORANGE	300.0 [11.8 in]
SW1-6	WIRE, 24AWG AWM UL1015, WHITE	300.0 [11.8 in]
SW1- (+)	WIRE, 24AWG AWM UL1015, RED	300.0 [11.8 in]
SW1- (-)	WIRE, 24AWG AWM UL1015, BLACK	300.0 [11.8 in]

** WIRE LEADS PROVIDED ARE DEPENDANT ON THE FUNCTION AND/OR ILLUMINATION SELECTED **

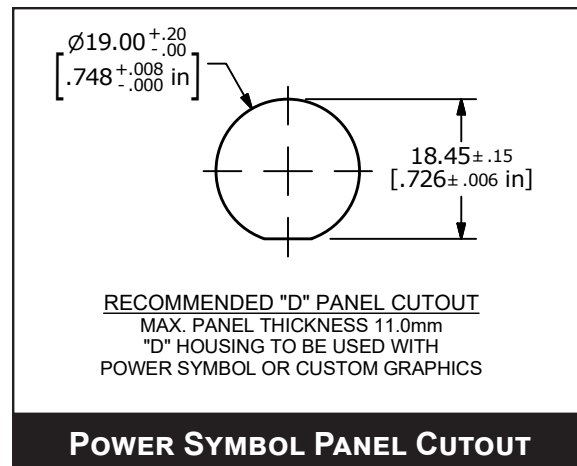
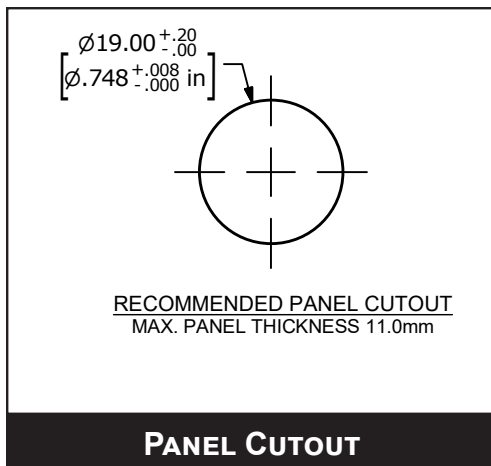
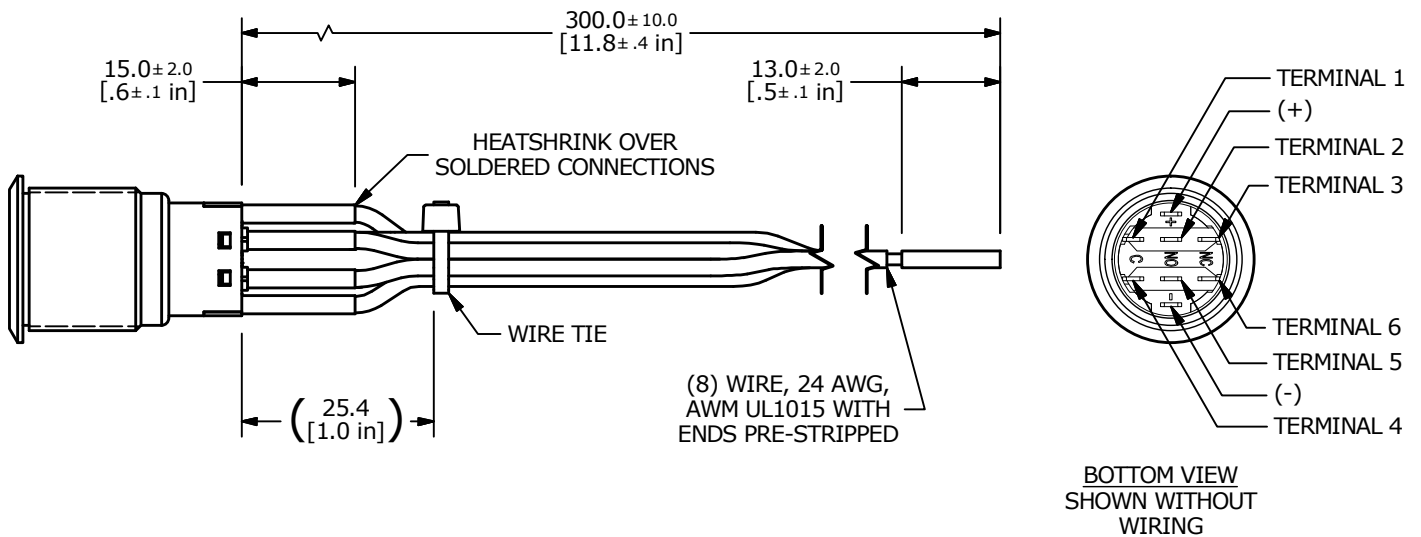

E-SWITCH®

www.e-switch.com

800.867.2717

7

PV4 SERIES ANTI-VANDAL SWITCH

RGB LED WIRE LEAD

SWITCH	WIRE	LENGTH
SW1-1	WIRE, 24AWG AWM UL1015, ORANGE	300.0 [11.8 in]
SW1-2	WIRE, 24AWG AWM UL1015, WHITE	300.0 [11.8 in]
SW1-3	WIRE, 24AWG AWM UL1015, YELLOW	300.0 [11.8 in]
SW1-RED (+)	WIRE, 24AWG AWM UL1015, RED	300.0 [11.8 in]
SW1-GREEN (+)	WIRE, 24AWG AWM UL1015, GREEN	300.0 [11.8 in]
SW1-BLUE (+)	WIRE, 24AWG AWM UL1015, BLUE	300.0 [11.8 in]
SW1- (-)	WIRE, 24AWG AWM UL1015, BLACK	300.0 [11.8 in]

** WIRE LEADS PROVIDED ARE DEPENDANT ON THE FUNCTION AND/OR ILLUMINATION SELECTED **

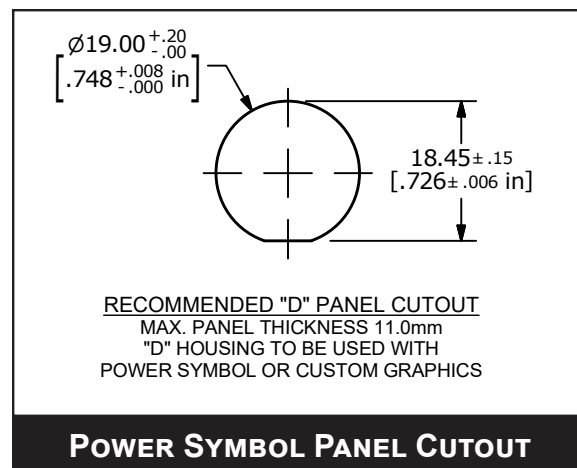
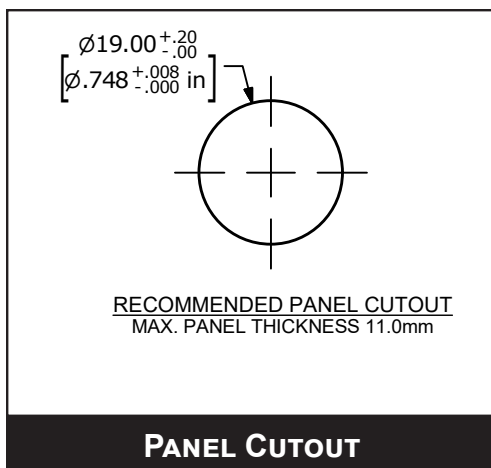
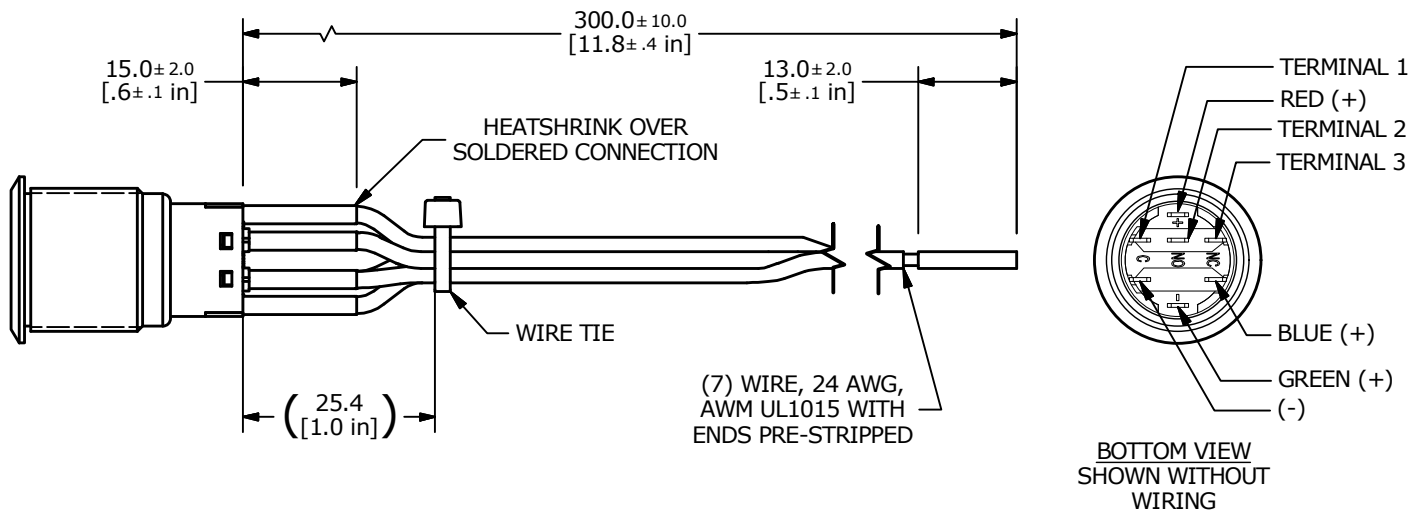

Mouser Electronics

Authorized Distributor

Click to View Pricing, Inventory, Delivery & Lifecycle Information:

E-Switch:

[PV4F2B0SS-331](#) [PV4F2B0SS-341](#) [PV4F2Y0SSG-2G1](#) [PV4F2Y0SSG-3G1](#) [PV4F2B0SS-311](#) [PV4F2B0SS-334](#)
[PV4F2G0SS-325](#) [PV4F2G0SS-331](#) [PV4F2H011](#) [PV4F2H0SS-344](#) [PV4F2Y011-345](#) [PV4F2Y0SS-3G5](#) [PV4F6Y0SS-](#)
[335](#) [PV4F2H011-341](#) [PV4F2Y011-311](#) [PV4F2G011-311](#) [PV4F2Y0SS-341](#) [PV4F2H011-311](#) [PV4F2G011-341](#)
[PV4F2Y011-341](#) [PV4F2H0SS-341](#) [PV4F2G0SS-341](#) [PV4F230SS](#) [PV4F230SS-314](#) [PV4F230SS-315](#) [PV4F230SS-](#)
[324](#) [PV4F230SS-325](#) [PV4F230SS-331](#) [PV4F230SS-335](#) [PV4F230SS-344](#) [PV4F230SS-346](#) [PV4F2B0SS-3N4](#)
[PV4F2G0SS](#) [PV4F2G0SS-314](#) [PV4F2G0SS-334](#) [PV4F2G0SS-344](#) [PV4F2G0SS-354](#) [PV4F2H0SS-335-M01](#)
[PV4F2Y0SS](#) [PV4F2Y0SS-211](#) [PV4F2Y0SS-214](#) [PV4F2Y0SS-235](#) [PV4F2Y0SS-241](#) [PV4F2Y0SS-244](#) [PV4F2Y0SS-](#)
[245](#) [PV4F2Y0SS-301](#) [PV4F2Y0SS-304](#) [PV4F2Y0SS-311](#) [PV4F2Y0SS-314](#) [PV4F2Y0SS-315](#) [PV4F2Y0SS-316](#)
[PV4F2Y0SS-324](#) [PV4F2Y0SS-325](#) [PV4F2Y0SS-334](#) [PV4F2Y0SS-335](#) [PV4F2Y0SS-344](#) [PV4F2Y0SS-346](#)
[PV4F23011-334](#) [PV4F2Y011-351](#) [PV4F2B01S-331-M01](#) [PV4F2B0SS-304](#) [PV4F2Y01S-344](#) [PV4F6Y0SS-341](#)
[PV4F2Y01S-314](#) [PV4F2Y011-344](#) [PV4F2Y011-314](#) [PV4F23011](#) [PV4F2B0SS-311-M01](#) [PV4F23011-344](#)
[PV4F2Y01S-343](#) [PV4F2B0SS-344](#) [PV4F2G0SS-335](#) [PV4F23011-341](#) [PV4F2G0SS-3G4](#) [PV4F2H0SS](#) [PV4F2Y0SS-](#)
[355](#) [PV4F2B0SS-345](#) [PV4F2G0SS-311](#) [PV4F2H0SS-351](#) [PV4F2H0SS-315](#) [PV4F2B011-344](#) [PV4F2G011](#)
[PV4F2B0SS-343](#) [PV4F2B0SS-315](#) [PV4F2Y0SS-3G4](#) [PV4F23011-314](#) [PV4F230SS-334](#) [PV4F2Y0SS-345](#)
[PV4F2B011-324](#) [PV4F23011-324](#) [PV4F2B0SS-335](#) [PV4F230SS-3K1-M01](#) [PV4F2Y0SS-331](#) [PV4F2Y0SS-3H4](#)
[PV4F230SS-341](#) [PV4F2Y0SS-3J1](#) [PV4F2B011-314](#) [PV4F2B0SSG-3N1](#) [PV4F230SS-345](#) [PV4F230SS-336](#)