

NOTES:

1. ALL DIMENSIONS IN MM [INCH]
2. GENERAL TOLERANCE: x.x = $\pm 0.4\text{mm}$
x.xx = $\pm 0.25\text{mm}$
3. RATING: 3A 30VDC
4. TERMINALS: COPPER, SILVER PLATED
- ▲ 5. TRAVEL: FULL TRAVEL $3.2 \pm .3\text{mm}$
SWITCH to MAKE: $1.8 \pm .3\text{mm}$
6. FUNCTION: OFF-(ON) (MOMENTARY)
7. ELECTRICAL LIFE: 6,000 CYCLES
8. OPERATING TEMPERATURE: -5°C to 60°C
9. CONTACT RESISTANCE: $30\text{m}\Omega$ MAX.
10. INSULATION RESISTANCE: $500\text{M}\Omega$ MIN@ 500V
11. ▲ DENOTES CRITICAL PARAMETER.
12. 2011/65/EU (RoHS) COMPLIANT.
- ▲ 13. CAPS ARE TO COME IN BULK IN A PLASTIC BAG.

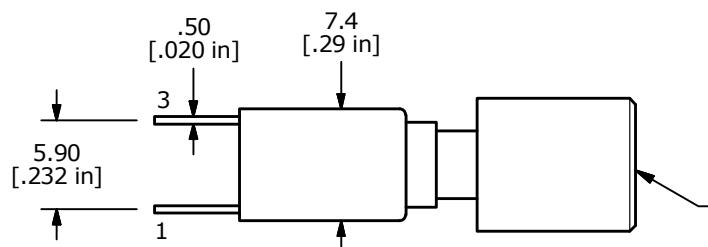

▲ CAP
COLOR: BLACK
(SHOWN WITH CAP)
(CAPS DO NOT COME
ASSEMBLED TO THE SWITCH)

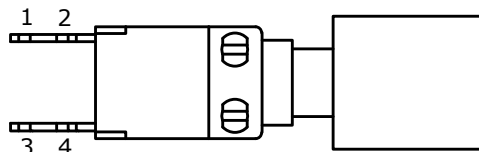
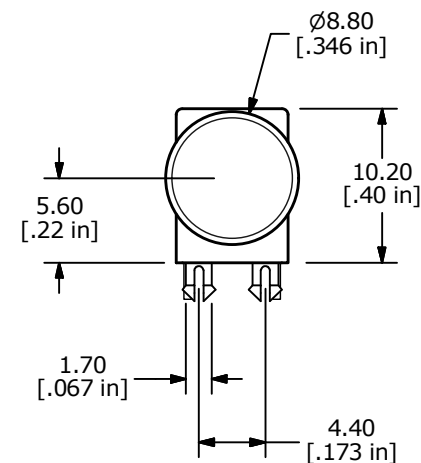
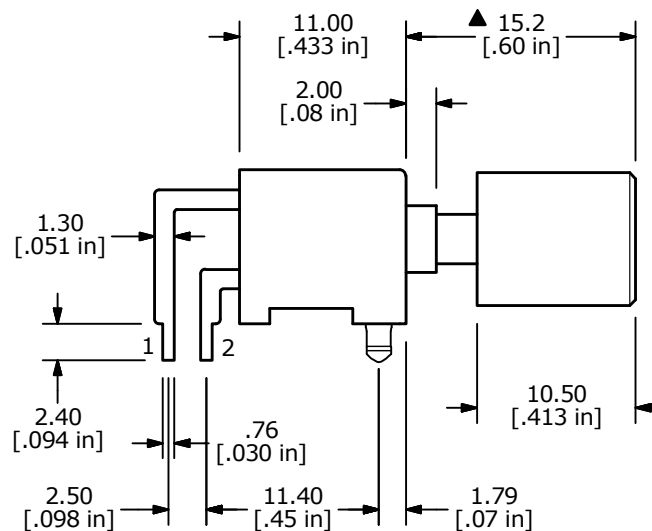
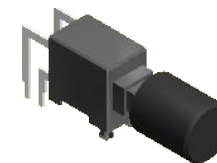

TITLE PB4000AQR1BLK

SCALE 2:1

DATE 11/10/2017

DR MW

DWG T004001

REV A

THE INFORMATION CONTAINED IN THIS DOCUMENT IS PROPRIETARY
TO E-SWITCH AND IS NOT TO BE COPIED OR TRANSFERRED

A	23055	New Release	11/10/17	MW
REV	PCR NO	DESCRIPTION	DATE	BY

Mouser Electronics

Authorized Distributor

Click to View Pricing, Inventory, Delivery & Lifecycle Information:

[E-Switch:](#)

[PB400OAQR1BLK](#)