

ITEM	QTY.	PART NO.	PART DESCRIPTION
1	1	F040010	P16 0A S11
2	1	F052311	50-003-11 (BLU OPAQUE LENS)

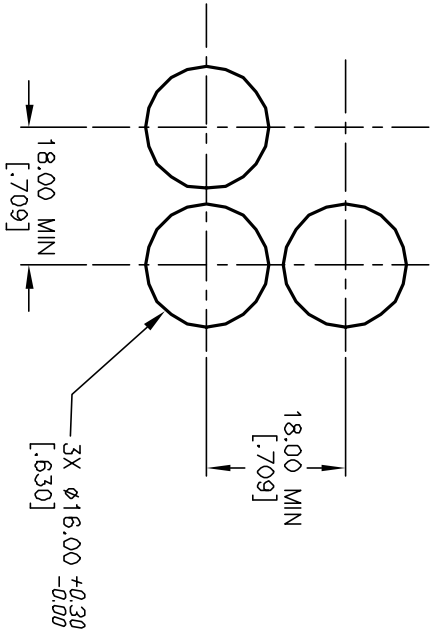

RECOMMENDED
PANEL MOUNTING

1 2 3 4
3 0 0 4
a-L-b (+)

SPST
CONTACT CONFIGURATION

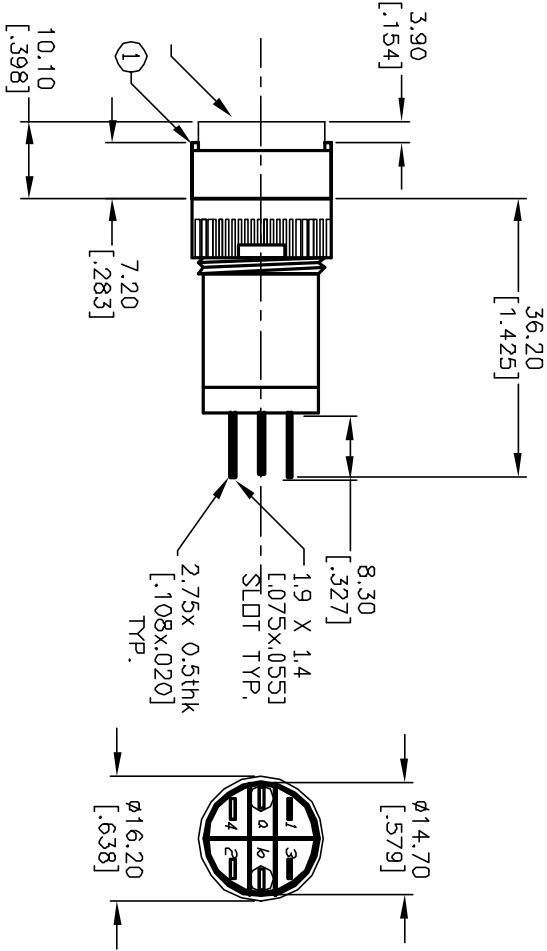
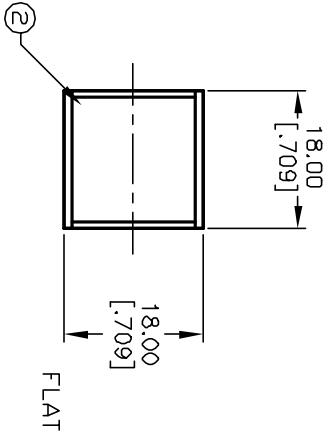

NOTES:

1. ALL DIMENSIONS IN MM [INCH]
2. GENERAL TOLERANCE: X.X=±0.4
X.XX=±0.25
3. TERM. NOS. FOR REFERENCE ONLY.
4. RATING: 5A@250V AC / 8A@125V AC
5. MECHANICAL LIFETIME: >2 MILLION OPERATIONS
6. TRAVEL: 3.0MM
7. CONTACT MATERIAL: COPPER ALLOY W/SILVER PLATING

TITLE				P16 0A S11 0 BLU			
A	12455	RELEASED FOR PRODUCTION	10/1/02	CB	SCALE	DATE	DR
REV.	ECN No.	DESCRIPTION	DATE	CHKD	1:5:1	10/1/02	CB
THE INFORMATION CONTAINED IN THIS DOCUMENT IS PROPRIETARY TO E-SWITCH AND IS NOT TO BE COPIED OR TRANSFERRED				E-SWITCH®			
				XF0518P			
				A			

Mouser Electronics

Authorized Distributor

Click to View Pricing, Inventory, Delivery & Lifecycle Information:

[E-Switch:](#)

[P16OAS110BLU](#)