

RECOMMENDED PANEL
MOUNTING

1 0 1 0 2
3 0 0 4
a-(L)-b (+)

SPST
CONTACT CONFIGURATION

NOTES:

1. ALL DIMENSIONS IN MM
2. GENERAL TOLERANCE: X.X=±0.4
X.XX=±0.25
3. RATINGS: 5A@250V AC,
8A@125V AC
4. CONTACT MATERIAL: COPPER ALLOY W/Gold Plating
5. TRAVEL: 3.0mm (Total) 2.0mm (Latch)
6. MECHANICAL LIFE: >100,000 Cycles
7. ELECTRICAL LIFE: >50,000 Cycles
8. INSULATION RESISTANCE: >1000 MΩ-100MΩ
9. OPERATING TEMP: -20°C to 55°C
10. LAMP VOLTAGE: 12VDC (L.E.D.)

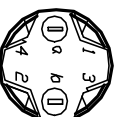
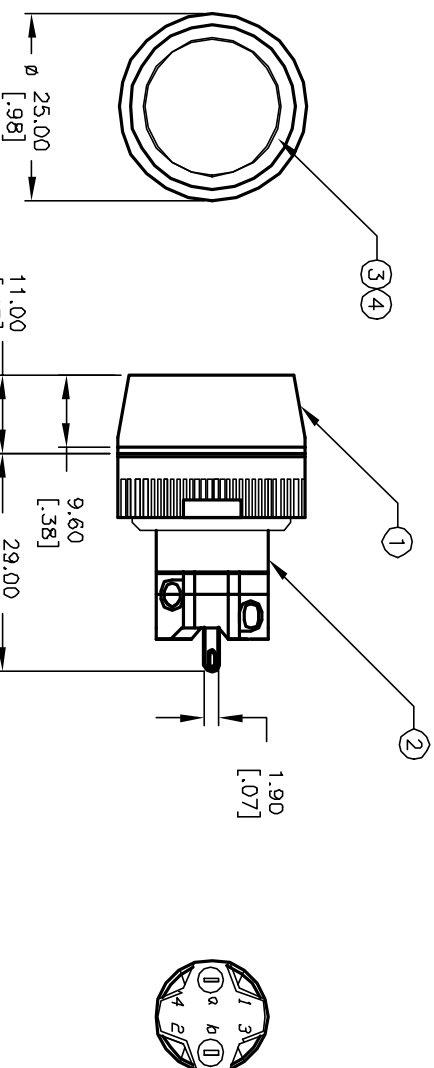

| PARTS LIST | | | |
|------------|------|----------|-----------------------------|
| Item | Qty. | Dwg. No. | Part No. |
| 1 | 1 | F051702 | 25mm RING FOR LA SERIES |
| 2 | 1 | F060602 | LASEEV110 |
| 3 | 1 | F061254 | 25mm GRN LENS (TRANSPARENT) |
| 4 | 1 | F050419 | 50-004-20 RED L.E.D. |

| | | | |
|--|---------|-------------------------|---------|
| TITLE | | | |
| LAS EE V1 1J RED GRN (TRANSPARENT LENS) | | | |
| E-SWITCH® | | | |
| A | 12307 | RELEASED FOR PRODUCTION | 7/17/02 |
| REV. | ECN No. | DESCRIPTION | DATE |
| THE INFORMATION CONTAINED IN THIS DOCUMENT IS PROPRIETARY TO E-SWITCH AND IS NOT TO BE COPIED OR TRANSFERRED | | | |
| SCALE | | DATE | DR |
| 1:1 | | 7/17/02 | CJB |
| DWG | | XF0487P | |
| REV | | A | |

Mouser Electronics

Authorized Distributor

Click to View Pricing, Inventory, Delivery & Lifecycle Information:

[E-Switch:](#)

[LASEEV11JREDGRN](#)