

a ○ ○ b (+)
CIRCUIT
(NO LAMP)

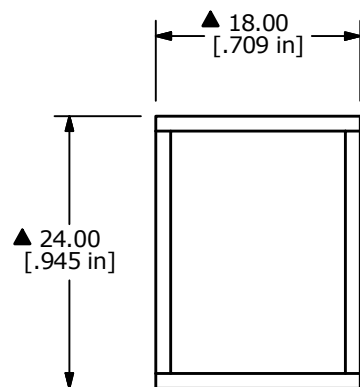

NOTE:

1. ALL DIMENSIONS IN MM [INCH]
2. GENERAL TOLERANCE: X.X = ± 0.4
X.XX = ± 0.25
3. TERMINAL NUMBERS FOR REF ONLY
4. OPERATING TEMP: -25°C to +70°C (No Lamp)
5. STORAGE TEMP: -40°C to +85°C
- ▲ 6. LAMP VOLTAGE: N/A
7. ▲ DENOTES CRITICAL PARAMETER.
8. SEAL RATING: IP40

PARTS LIST			
ITEM	QTY	PART NUMBER	DESCRIPTION
1	1	F040001	L16PLT10
2	1	F050215	50-002-15 WHITE TRANSPARENT RECTANGULAR FLAT LENS
-	-	-	NO LAMP

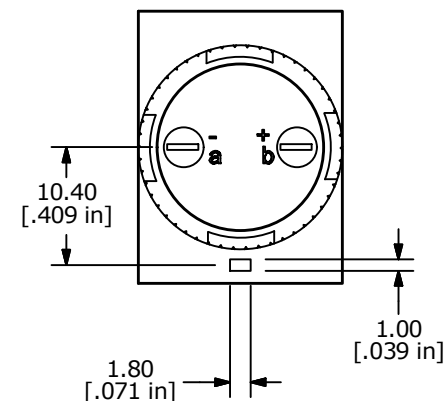
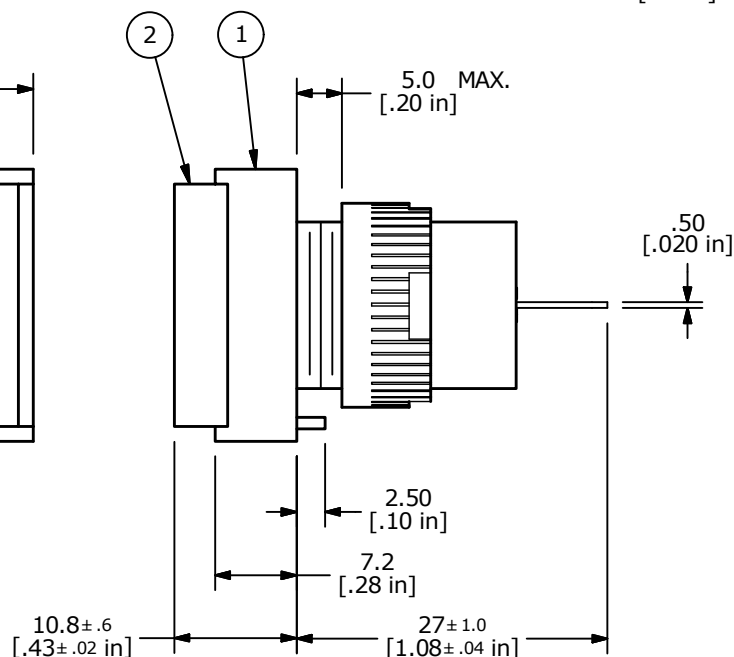
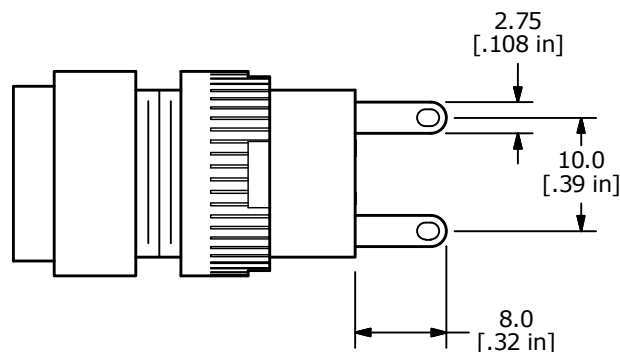

A	24038	RELEASE	9/18/19	MW
REV	PCR NO	DESCRIPTION	DATE	BY

THE INFORMATION CONTAINED IN THIS DOCUMENT IS PROPRIETARY
TO E-SWITCH AND IS NOT TO BE COPIED OR TRANSFERRED

TITLE L16PLT100WHT

SCALE 3:2

DATE 9/18/2019

DR MW

DWG XF0927P

REV A

Mouser Electronics

Authorized Distributor

Click to View Pricing, Inventory, Delivery & Lifecycle Information:

[E-Switch:](#)

[L16PLT100WHT](#)