

PARTS LIST

ITEM	QTY	PART NUMBER	DESCRIPTION
1	1		SQUARE with HIGH BEZEL
2	1	F050312	50-003-12 SQUARE FLAT GREEN LENS
3	1	F050422	50-004-11 110V AC GREEN NEON LAMP

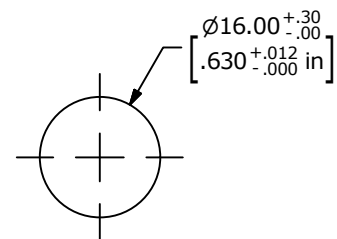

PANEL MOUNTING

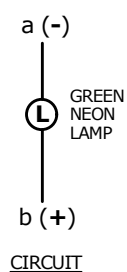
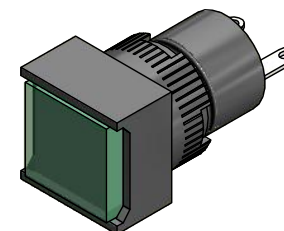
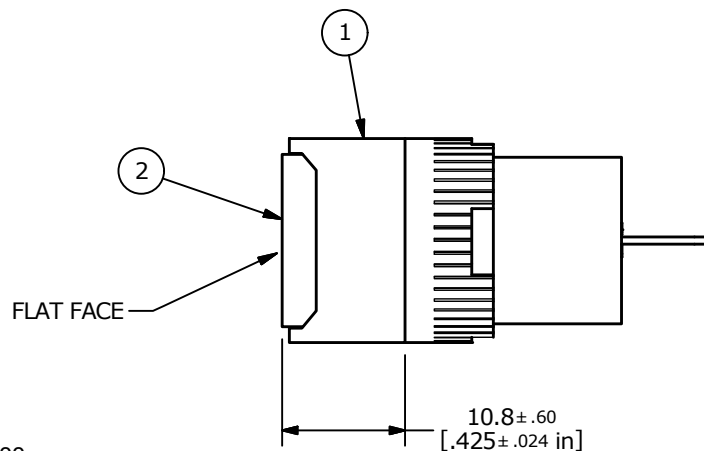

CIRCUIT

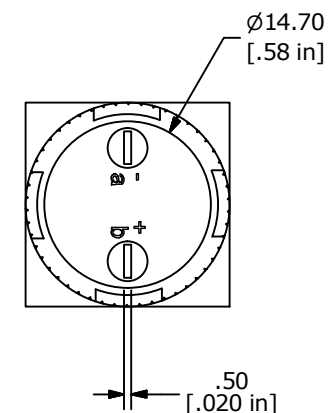
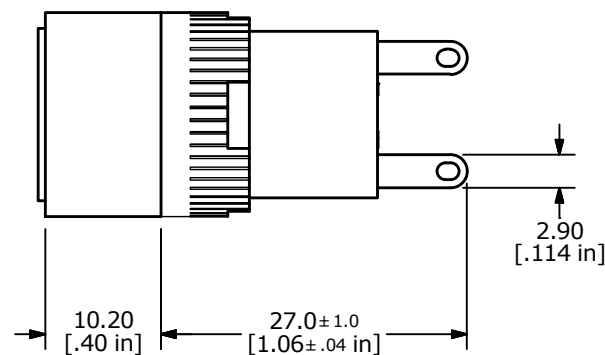
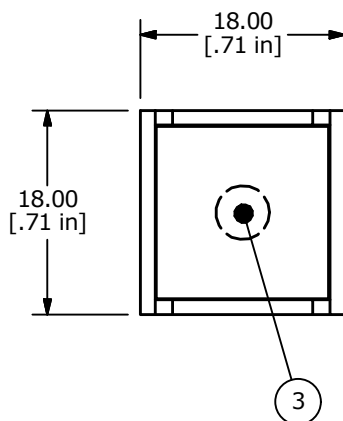

NOTE:

1. ALL DIMENSIONS IN MM [INCH]
2. GENERAL TOLERANCE: X.X = ±0.4
X.XX = ±0.25
3. TERMINAL NUMBERS FOR REF ONLY
4. OPERATING TEMP: -25°C to +55°C
5. STORAGE TEMP: -40°C to +85°C
- ▲ 6. LAMP VOLTAGE: 110VAC GREEN NEON LAMP
7. ▲ DENOTES CRITICAL PARAMETER.
8. 2011/65/EU (ROHS) COMPLIANT



TITLE L16PLS20FGRNGRN

A	23158	RELEASE	1/22/18	MW
REV	PCR NO	DESCRIPTION	DATE	BY

THE INFORMATION CONTAINED IN THIS DOCUMENT IS PROPRIETARY
TO E-SWITCH AND IS NOT TO BE COPIED OR TRANSFERRED

SCALE 3:2	DATE 1/15/2018	DR MW	DWG XF0914P	REV A
--------------	-------------------	----------	----------------	----------

Mouser Electronics

Authorized Distributor

Click to View Pricing, Inventory, Delivery & Lifecycle Information:

[E-Switch:](#)

[L16PLS20FGRNGRN](#)