

RECOMMENDED PANEL MOUNTING

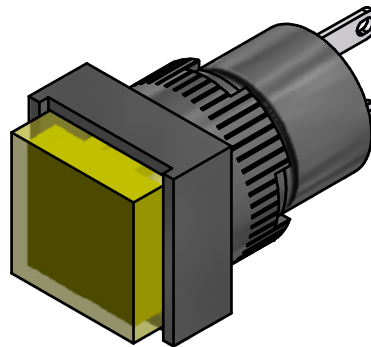

a—(L)—b(+)
CIRCUIT

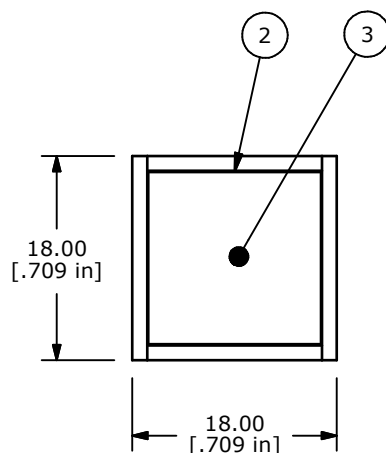

NOTE:

1. ALL DIMENSIONS IN MM [INCH]
2. GENERAL TOLERANCE: X.X=±0.4
X.XX=±0.25
3. TERMINAL NUMBERS FOR REF ONLY
4. OPERATING TEMP: -25°C to +55°C
5. STORAGE TEMP: -40°C TO +85°C
- ▲ 6. LAMP VOLTAGE: 6VDC LED
7. ▲ DENOTES CRITICAL PARAMETER.
8. 2002/95/EC (ROHS) COMPLIANT

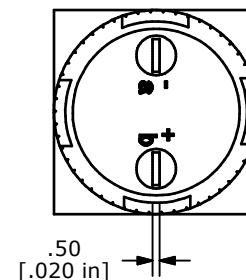
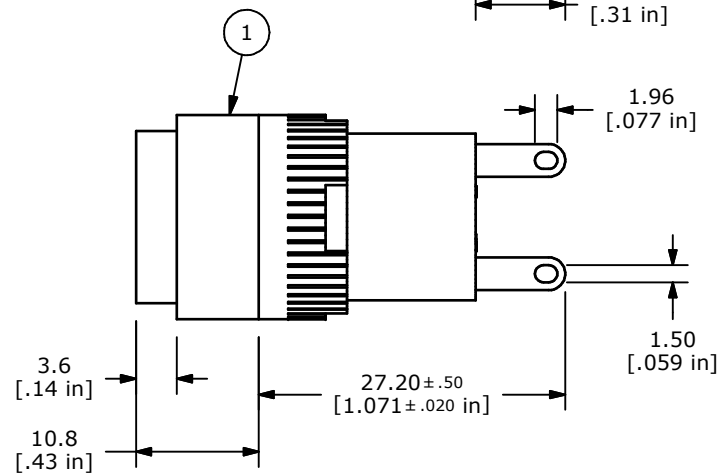
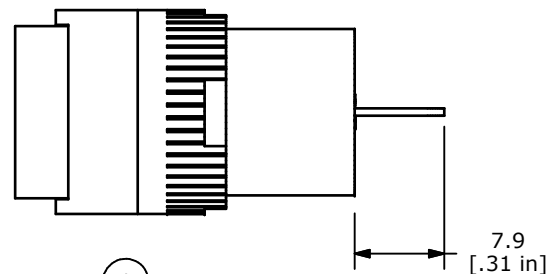

PARTS LIST

ITEM	QTY	PART NUMBER	DESCRIPTION
1	1	F040002	L16PLS10
2	1	F050316	50-003-16 TRANSPARENT FLAT YELLOW LENS
3	1	F050431	50-004-31 6V WHITE LED



TITLE L16PLS10HWHTYEL

A	21352	RELEASED FOR PRODUCTION	1/15/14	EBP
REV	PCR NO	DESCRIPTION	DATE	BY

THE INFORMATION CONTAINED IN THIS DOCUMENT IS PROPRIETARY
TO E-SWITCH AND IS NOT TO BE COPIED OR TRANSFERRED

SCALE	DATE 1/15/2014	DR EBP	DWG XF0876P	REV A
-------	-------------------	-----------	----------------	----------

Mouser Electronics

Authorized Distributor

Click to View Pricing, Inventory, Delivery & Lifecycle Information:

[E-Switch:](#)

[L16PLS10HWHTYEL](#)